

# **Monona Grove School District**

## **4K-8 Grade Configuration Study**

**December 22, 2009**

**Patti McGinnis**

# ***Contents***

**Background and Purpose of Study**

**Study Participants**

**Enrollment Projections**

**Computer Related Projected Expenses**

**Science Lab Projected Expenses**

**FACE and Tech. Ed. Projected Expenses**

**Library Materials Replication Projected Costs**

**Music Replication Projected Expenses**

**PE and Health Instruction Projected Expenses**

**Student Services Staffing**

**Winnequah Interscholastic Athletics Projected Costs**

**Transportation Projected Cost Estimates**

**Projected Sections for Grades Seven and Eight at Winnequah and GDS**

**Sample Master Schedules for Grades 6 – 8**

**Draft Maps of Winnequah and Glacial Drumlin**

**Summary of Projected Expenses**

# **Monona Grove School District**

## **4K-8 Grade Configuration Study**

### **Background**

In May of 2008 the Board of Education asked that a task force be formed to examine the future of 4K through sixth-grade programming in Monona to include staffing, and all Monona facilities usage, including potential closing of Maywood School, and sixth-grade programming at Winnequah School. In November of 2008 the Board recommended the scope of the committee be expanded to include discussion of issues related to enrollments and grade configurations of the 4K – 8<sup>th</sup> grade schools in the Monona Grove School District. This committee was comprised of Monona Grove parents, teachers, principals, and the superintendent of schools. At the end of the school year the committee brought forward to the Board six recommendations. One of the six was to research 4K-8 programming in both communities.

### **Purpose of the 4K-8 Grade Configuration Study**

Determine the fiscal impact of providing comparable elementary and middle school programming for students should all 4K-8 students attend school in their respective communities beginning in 2011 – 2012.

### **Assumptions**

- Replication of middle level programming at Winnequah will have the greatest fiscal impact, hence the focus of this study.
- For the purposes of this study, programming for middle level students remains the same as currently offered.
- Cottage Grove fourth-grade students will be moved to Glacial Drumlin (seven sections). This move will include all core classroom furniture and curriculum materials.

- Monona students in grades seven and eight will be moved to Winnequah (five sections). This move will include all core classroom furniture and curriculum materials.
- Should the Monona Grove School Board choose to move forward with this grade configuration, related arts/encore staffing district-wide will be finalized by building principals. This will likely have additional fiscal impact.
- Should the Monona Grove School Board choose to move forward with this grade configuration, decisions will be made regarding grade configurations at Cottage Grove Elementary School & Taylor Prairie Elementary School.

## **4K-8 Grade Configuration Study Participants 2009**

<b>Barbara Burt</b>	<b>Winnequah 6<sup>th</sup> Science</b>
<b>Jennifer Bussan</b>	<b>Glacial Drumlin 7<sup>th</sup> &amp; 8<sup>th</sup> Choir</b>
<b>Carl Davick</b>	<b>Glacial Drumlin Orchestra</b>
<b>Pat Dorn</b>	<b>Glacial Drumlin &amp; Winnequah Band</b>
<b>John Faust</b>	<b>Monona Grove Director of Student Services</b>
<b>Lynn Hammersley</b>	<b>MG Data/Student Information Administrator</b>
<b>Bill Herman</b>	<b>Monona Grove Technology Director</b>
<b>Sarah Hinton</b>	<b>Glacial Drumlin &amp; Winnequah 6<sup>th</sup> – 8<sup>th</sup> French</b>
<b>David Kinsler</b>	<b>Glacial Drumlin 6<sup>th</sup> – 8<sup>th</sup> Tech. Ed.</b>
<b>Kim Kieck</b>	<b>Glacial Drumlin Administrative Assistant</b>
<b>Lila Klahn</b>	<b>Glacial Drumlin 8<sup>th</sup> Science</b>
<b>Pam Kolb</b>	<b>Glacial Drumlin &amp; Winnequah 6<sup>th</sup> – 8<sup>th</sup> FACE</b>
<b>Joyce Krug</b>	<b>Winnequah Administrative Assistant</b>
<b>Ann Maeder</b>	<b>Glacial Drumlin Reading Specialist</b>
<b>Kevin Mikelbank</b>	<b>Glacial Drumlin Physical Education</b>
<b>Lynn Nelson</b>	<b>Glacial Drumlin Administrative Assistant</b>
<b>Stacey Pipson</b>	<b>Winnequah Library Media Specialist</b>
<b>Bob Schlaefer</b>	<b>Glacial Drumlin 7<sup>th</sup> Science</b>
<b>Barb Schmidt</b>	<b>Glacial Drumlin Library Media Specialist</b>
<b>Ann Schroeder</b>	<b>Winnequah School Principal</b>
<b>Mark Scullion</b>	<b>Monona Grove Director of Facilities &amp; Grounds</b>
<b>Rick Sonn</b>	<b>Glacial Drumlin Physical Education &amp; Health</b>
<b>Janice Stone</b>	<b>Glacial Drumlin &amp; Winnequah Band</b>
<b>Renee Tennant</b>	<b>Glacial Drumlin Principal</b>
<b>John VanDerMerwe</b>	<b>Monona Grove Director of Transportation</b>
<b>Krisi Wollermann</b>	<b>Glacial Drumlin 7<sup>th</sup> &amp; 8<sup>th</sup> Spanish</b>
<b>Dan Zweifel</b>	<b>Glacial Drumlin Athletic Director</b>

---

**MONONA GROVE SCHOOL DISTRICT**  
**DECEMBER 22, 2009**

# **4K-8 Grade Configuration Study**

---

## **Enrollment Projections**

### ***K-6 2009-2010 Enrollment***

**Actual Enrollment**

**APL Projected Enrollment**

### ***Winnequah School***

**Cast Forward Projections for 2011 - 2012**

**Cast Forward Projections for 2012 - 2013**

### ***Glacial Drumlin School***

**Cast Forward Projections for 2011 - 2012**

**Cast Forward Projections for 2012 - 2013**

# Monona Grove Student Counts K – 6

2009 - 2010

## Cottage Grove

Actual Enrollment as of September 18, 2009			Applied Population Baseline Projected Enrollment '09-'10		
Grade	Enrollment	% of Grade Level Enrollment	Grade	Enrollment	% of Grade Level Enrollment
K	162	62%	K	140	68%
1	171	75%	1	180	76%
2	149	76%	2	154	77%
3	149	71%	3	152	73%
4	165	69%	4	172	72%
5	152	76%	5	164	78%
6	149	71%	6	No breakdown for grade level	?
Totals	1,097	71% of K-6 Enrollment	Totals		

## Monona

Actual Enrollment as of September 18, 2009			Applied Population Baseline Projected Enrollment '09-'10		
Grade	Enrollment	% of Grade Level Enrollment	Grade	Enrollment	% of Grade Level Enrollment
K	98	38%	K	67	32%
1	57	25%	1	58	24%
2	47	24%	2	45	23%
3	61	29%	3	56	27%
4	75	31%	4	66	28%
5	48	24%	5	47	22%
6	61	29%	6	No breakdown for grade level	?
Totals	447	29% of K-6 Enrollment	Totals		

# **School Configurations**

## **Cast Forward Projection**

**2011 - 2012**

### **Winnequah School**

**Monona Grades 3 – 8**

<b>Grades</b>	<b>Number of Students*</b>	<b>Number of Sections</b>	<b>Class Size</b>
3	57	3	19
4	47	2	23 - 24
5	61	3	20 - 21
6	75	4	18 - 19
7	48	2	22 - 23
8	61	3	20 - 21
	<b>Total = 349</b>	<b>Total = 17</b>	

\* 28% of district middle school students (184 students out of 650 students in grades 6 – 8)

\* Cast forward projection of '09 – '10 September Third Friday Counts

### **Glacial Drumlin School**

**Cottage Grove Grades 4 – 8**

<b>Grades</b>	<b>Number of Students*</b>	<b>Number of Sections</b>	<b>Class Size</b>
4	149	7	21 - 22
5	149	7	21 - 22
6	165	7	23 - 24
7	152	7	21 - 22
8	149	7	21 - 22
	<b>Total = 764</b>	<b>Total = 28</b>	

\* 72% of district middle school students (466 students out of 650 students in grades 6 – 8)

\* Cast forward projection of '09 – '10 September Third Friday Counts



Revised 10.20.09

# **School Configurations**

## **Cast Forward Projections**

### **2012 - 2013**

#### **Winnequah School**

**Monona Grades 3 – 8**

<b>Grades</b>	<b>Number of Students*</b>	<b>Number of Sections</b>	<b>Class Size</b>
3	98	5	19 - 20
4	57	3	19
5	47	2	23 - 24
6	61	3	20 - 21
7	75	4	18 - 19
8	48	2	24
	<b>Total = 386</b>	<b>Total = 19</b>	

\* 28% of district middle school students (184 students out of 650 students in grades 6 – 8)

\* Cast forward projection of '09 – '10 September Third Friday Counts

#### **Glacial Drumlin School**

**Cottage Grove Grades 4 – 8**

<b>Grades</b>	<b>Number of Students*</b>	<b>Number of Sections</b>	<b>Class Size</b>
4	171	7	24 - 25
5	149	7	21 - 22
6	149	7	21 - 22
7	165	7	23 - 24
8	152	7	21 - 22
	<b>Total = 786</b>	<b>Total = 28</b>	

\* 72% of district middle school students (466 students out of 650 students in grades 6 – 8)

\* Cast forward projection of '09 – '10 September Third Friday Counts

**MONONA GROVE SCHOOL DISTRICT**  
**DECEMBER 22, 2009**

## **4K-8 Grade Configuration Study**

---

### **Projected Additional Computer Related Expenses**

<b>Year 1 Costs for Computer Labs, READ 180 Classroom, Tech. Ed. Lab</b>	<b>\$168,800</b>
<b>Year 1 Construction Cost Estimate for New Computer Lab at Winnequah</b>	<b>\$ 32,550</b>
<b>Furniture Cost Estimate for New Computer Lab and READ 180 Classroom</b>	<b>\$ <u>9,567</u></b>
	<b>\$210,917</b>
 <b>Annual Additional Ongoing Computer Related Costs at Winnequah &amp; GDS</b>	 <b>\$23,267</b>

## ***Student Enrollment & Computer Lab Ratios***

### ***Winnequah & Glacial Drumlin***

**2009 – 2010**

#### ***Winnequah School***

<b>Grade Enrollment September 18</b>	<b>Number of Computer Labs</b>	<b>Ratio of Students to Computer Labs</b>
<b>Grade 3 = 61</b>	<b>1 Instructional Lab</b>	
<b>Grade 4 = 75</b>	<b>1 Laptop Lab</b>	
<b>Grade 5 = 48</b>		
<b>Grade 6 = 61</b>		
<b>Total Enrollment: 245</b>	<b>Total Labs: 2</b>	<b>Ratio: 123:1</b>

#### ***Glacial Drumlin School***

<b>Grade Enrollment September 18</b>	<b>Number of Computer Labs</b>	<b>Ratio of Students to Computer Labs</b>
<b>Grade 5 = 152</b>	<b>1 Lab</b>	
<b>Grade 6 = 149</b>	<b>1 Lab</b>	
<b>Grade 7 = 215</b>	<b>1 Lab</b>	
<b>Grade 8 = 207</b>	<b>1 Lab</b>	
	<b>IMC Laptop Lab</b>	
<b>Total Enrollment: 723</b>	<b>Total Labs: 5</b>	<b>Ratio: 145:1</b>

## ***Cast Forward Student Enrollment & Computer Lab Ratios***

### ***Winnequah & Glacial Drumlin***

**2011 – 2012**

#### ***Winnequah School***

<b>Grade Enrollment</b>	<b>Number of Computer Labs</b>	<b>Ratio of Students to Computer Labs</b>
<b>Grade 3 = 57</b>	<b>1 Instructional Lab</b>	
<b>Grade 4 = 47</b>	<b>2 Labs</b>	
<b>Grade 5 = 61</b>		
<b>Grade 6 = 75</b>		
<b>Grade 7 = 48</b>		
<b>Grade 8 = 61</b>		
<b>Total Enrollment: 349</b>	<b>Total Labs: 3</b>	<b>Ratio: 116:1</b>

#### ***Glacial Drumlin School***

<b>Grade Enrollment</b>	<b>Number of Computer Labs</b>	<b>Ratio of Students to Computer Labs</b>
<b>Grade 4 = 149</b>	<b>4 Labs in Pods</b>	
<b>Grade 5 = 149</b>	<b>IMC Laptop Lab</b>	
<b>Grade 6 = 165</b>	<b>1 Mobile Lab</b>	
<b>Grade 7 = 152</b>		
<b>Grade 8 = 149</b>		
<b>Total Enrollment: 764</b>	<b>Total Labs: 6</b>	<b>Ratio: 127:1</b>

**A decrease in the ratio of students to computer labs at both Winnequah and Glacial Drumlin is positive due to increased technology use for full implementation of elementary and middle school literacy curriculums.**

## 4-8 Grade Configuration Study: Projected Additional Computer-Related Expenses Monona Grove

Prepared by Bill Herman

Year 1 costs: Winnequah	97,850
Year 1 costs: Glacial Drumlins	69,750
<b>Total Year 1 costs:</b>	<b>167,600</b>

Annual additional ongoing costs: Winnequah	13,975
Annual additional ongoing costs: GDS	9,292
<b>Total additional annual ongoing costs:</b>	<b>23,267</b>

see other worksheets for detail

rev. November 25, 2009

### Construction Estimates Prepared by Mark Scullion

Below are construction estimates based on 2009 pricing. These are estimates only of square footage costs associated with remodeling Room 136 at Winnequah as a computer lab.

#### Computer Lab (Room 136)

- Existing room needing no new walls, doors, or windows
- Removal of existing floor & ceiling finishes
- All new finishes-carpet, acoustical tile ceiling, new lighting, paint walls
- Electrical/data for computer work stations
- Wiring and smartboard
- Plastic laminate perimeter countertops
- Does not include FFE (chairs or computers)

The square footage of room 136 is 1,085 square feet at an estimate of \$30.00 sq/ft.

**Total Remodeling Estimate      \$32,550**

## 4-8 Grade Configuration Study: Projected Additional Computer-Related Expenses Winnequah

### Year 1 Costs

#### Computers

##### **1 additional instructional lab**

28 desktop computers	14,000
4 electrical circuits	1,200
28 data locations	7,000
1 projector	1,200

Total cost of additional lab **23,400**

##### **1 tech ed lab**

25 desktop computers	12,500
2 electrical circuits	600
25 data locations	6,250
1 projector	1,200

Total cost of tech ed lab **20,550**

##### **Read 180 classroom**

8 desktop computers	4,000
8 data locations	2,000
1 projector	1,200

READ 180 Enterprise Software 7,500

Total cost of READ 180 classroom **14,700**

#### Projectors

13 classroom projectors 15,600

For grade 3, 4, 5, 7, 8 classrooms,  
band room

#### Bandwidth (for WAN and Internet)

2 additional T1 lines 4,800

Year 1 cost (future bandwidth costs are  
difficult to project; this is one possible  
approach)

Wireless infrastructure 20,000

For parity with GDS

Total year 1 costs: **99,050**

### Additional annual ongoing costs

Computer replacement	6,400
Projector replacements	2,775
WAN bandwidth	4,800

assumes 5 year replacement

assumes 5 year replacement and 1 bulb

Total additional annual ongoing costs **13,975**

assumption: classrooms added at Winnequah will be removed from CGS -- so classroom computers can move with classrooms without additional cost.

assumption: CGS will still have 14 sections (around 310 students) so it should still have 2 labs

note: remodeling and furnishing costs are not included

note: projector costs include cost of mounting equipment, electrical circuit, cabling, and speakers

## 4-8 Grade Configuration Study: Projected Additional Computer-Related Expenses GDS

### Year 1 Costs

#### Computers

##### **1 additional mobile lab**

28 laptops	14,000	
2 electrical circuits	600	
28 data locations	7,000	
<b><u>Total cost of additional lab</u></b>		<b>21,600</b>

#### Notes

assumes netbook computers

##### **READ 180 Classroom**

READ 180 Enterprise Software extension	6,900	upgrade, parity with Winnequah
--	-------	--------------------------------

#### Projectors

25 classroom projectors	16,250
-------------------------	--------

rooms that don't have them;  
for parity with Winnequah  
To support mobile lab

#### Wireless infrastructure

25,000

**Total year 1 costs:** 69,750

### Additional annual ongoing costs

Computer replacement	4,667
Projector replacements	4,625

assumes 3 year replacement  
assumes 5 year replacement &  
1 bulb replacement

**Total additional annual ongoing costs** 9,292

assumption: classrooms added at GDS will be removed from CGS -- so computers can move with classrooms without additional cost

assumption: CGS will still have 14 sections (around 310 students) so it should still have 2 labs

note: remodeling and furnishing costs are not included

# Winnequah Computer Lab and READ 180

## Estimated Costs for Furniture

### K-8 Configuration

#### Computer Lab

Classroom Furniture	Cost	# Needed	Total	10% Added
Teacher Desk	\$290.40	1	\$290.40	\$319.44
Teacher Task Chair	\$200.27	1	\$200.27	\$220.30
Filing Cabinet (4 High Vertical)	\$135.65	2	\$271.30	\$542.60
Bookcase	\$111.85	2	\$223.70	\$246.07
Classroom Table	\$142.42	14	\$1,993.88	\$2,003.88
Student Chair	\$45.12	28	\$1,263.36	\$1,389.70
<b>Total for Classroom Furniture</b>				<b>\$4,722</b>

#### READ 180 Classroom

Classroom Furniture	Cost	# Needed	Total	10% Added
Teacher Desk	\$290.40	1	\$290.40	\$319.44
Teacher Task Chair	\$200.27	1	\$200.27	\$220.30
Filing Cabinet (4 High Vertical)	\$135.65	2	\$271.30	\$542.60
Classroom Table	\$142.42	14	\$1,993.88	\$2,003.88
Bookcase	\$111.85	3	\$335.55	\$369.11
Student Chair	\$45.12	28	\$1,263.36	\$1,389.70
<b>Total for Classroom Furniture</b>				<b>\$4,845</b>

***Computer Lab & READ 180 Projected Furniture Cost: \$9,567***



**MONONA GROVE SCHOOL DISTRICT**  
**DECEMBER 22, 2009**

# **4K-8 Grade Configuration Study**

---

## **Projected Additional Science Lab Expenses**

<b>Construction Cost Estimate for 7<sup>th</sup> Grade Science Lab at Winnequah</b>	<b>\$ 73,450</b>
<b>Construction Cost Estimate for 8<sup>th</sup> Grade Science Lab at Winnequah</b>	<b>\$ 91,000</b>
<b>Furniture Cost Estimate for Two Science Labs</b>	<b>\$ 10,728</b>
<b>Year 1 Estimated Classroom Science Material Costs</b>	<b>\$ <u>3,000</u></b>
	<b>\$178,178</b>

## ***4K-8 Configuration***

### ***Addition of Two Science Labs at Winnequah***

#### **Contributors**

Barb Burt – Winnequah Sixth-Grade Science Teacher

Bob Schlaefer – Glacial Drumlin Seventh-Grade Science Teacher

Lila Klahn – Glacial Drumlin Eighth-Grade Science Teacher

Mark Scullion – Monona Grove Buildings & Grounds Director

#### **Rationale**

7<sup>th</sup> - 8<sup>th</sup> grade science curriculum is highly dependent upon lab facilities.

In 2012 four science sections are projected at the 7<sup>th</sup> grade level. This would require a dedicated full-time science lab.

In 2013 four science sections are projected at the 8<sup>th</sup> grade level. This would require a dedicated full-time science lab.

Science instruction has increasingly moved toward inquiry-based investigations. This curricular focus and progress in science instruction requires appropriate lab facilities and access to technological resources.

Based upon projected enrollment, increased inquiry-based science methodology, and the use of technology to facilitate the district's emphasis on 21<sup>st</sup> century skills, we recommend the addition of two science labs at Winnequah School.

#### **Year One Estimated Classroom Science Material Costs**

<b>Grade</b>	<b>Items</b>	<b>Cost</b>
<b>7<sup>th</sup></b>	Glassware, scales, props, samples, models, text TE editions, and lab supplies	\$1,500
<b>8<sup>th</sup></b>	Glassware, scales, props, samples, models, text TE editions, and lab supplies	\$1,500
	<b>Total</b>	<b>\$3,000</b>

## Science Classroom Furniture

Classroom Furniture	Cost	# Needed	Total	10% Added
Teacher Desk	\$290.40	2	\$580.80	\$638.88
Teacher Task Chair	\$200.27	2	\$400.54	\$440.59
Filing Cabinet (4 High Vertical)	\$135.65	2	\$271.30	\$542.60
Classroom Table	\$142.42	2	\$284.84	\$313.32
Student Tables	\$142.42	28	\$3,987.76	\$4,386.54
Student Chairs	\$45.12	56	\$2,526.72	\$2,779.39
Lab Stools	\$26.40	56	\$1,478.40	\$1,626.24
<b>Total Estimate for Science Classroom Furniture</b>				<b>\$10,728</b>

## ***Estimated Remodeling Costs for Two Science Labs***

Below are construction estimates based on 2009 pricing. These are estimates only of square footage costs associated with Rooms 66/68 and Room 127 for remodeling at Winnequah. Please note, these costs reflect what is listed below as work in each area.

### **Science Lab Rooms 66 and 68**

- Existing wall would need to be removed.
- Existing Rooms needing no new walls, doors or windows.
- Removal of existing floor & ceiling finishes
- All new finishes-vinyl tile floor, acoustical tile ceiling, new lighting, paint walls.
- Electrical/Data to lab stations
- Wiring and smart Boards
- Plumbing for lab sinks
- Plastic laminated cabinetry and countertops. (Not heavy duty lab tops)
- Does not include FFE (Chairs, stools, desks)

Square footage of Rooms 66 and 68 is 1,130 sq ft at an estimate of \$65.00/sq ft

**Remodeling Cost Estimate    \$73,450.00**

### **Room 127**

The scope of work would be the same as above. The square footage of Room 127 is 1,400 sq ft at an estimate of \$65.00/sq ft

**Remodeling Cost Estimate    \$91,000.00**

**MONONA GROVE SCHOOL DISTRICT**  
**DECEMBER 22, 2009**

# **4K-8 Grade Configuration Study**

---

## **Projected FACE & Tech. Ed. Expenses**

### ***FACE***

Appliance Estimate for FACE at Winnequah	\$ 6,659
Curriculum & Equipment Item Estimate for FACE at Winnequah	\$ 7,295
Furniture Cost Estimate for FACE at Winnequah	\$ <u>3,219</u>
	\$ 17,173

### ***Tech. Ed.***

First Technologies Lab Furniture Quote (plus 10%)	\$ 24,045
First Technologies STEM Laboratory Curriculum (plus 10%)	\$ 64,356
First Technologies Epilog Zing Laser (plus 10%)	\$ 9,917
First Technologies CO2 Car Workstations (plus 10%)	\$ <u>44,765</u>
	\$143,083

Estimated Construction/Remodel Costs	\$69,426
--------------------------------------	----------

<b><i>Total Estimated Costs for FACE &amp; Tech. Ed.</i></b>	<b>\$229,682</b>
--	------------------

## 4K-8 Family and Consumer Education

### Projected Winnequah Costs for Family and Consumer Education Cost Projections: Pamela Kolb, Mark Scullion, Patti McGinnis

FF& E Item	Unit Price	10% Increase
2 Refrigerators:  Suggested Model: Whirlpool ET8WTKXKQ 18.2 cu. Ft. Top-Freezer Refrigerator	Unit price: \$629. Total price: \$1258	\$1,384
5 Microwave Ovens  Suggested Model: Sharp R-320HW 1200 Watts Mid Size Microwave Oven	Unit price: \$140 Total price: \$700	\$770
1 Dishwasher  Suggested Model: Whirlpool Quiet Partner II Whirlpool – 24" Tall Tub Built-in Dishwasher	\$340	\$374
5 Overhead Range Hoods  Suggested Model: Broan 30" under cabinet hoods QS1 Series (Allure I) Range Hood QS130WW	Unit price: \$140 Total price: \$700	\$770
5 Electric Ranges  Suggested Model: Whirlpool RF263LXTQ 30" Freestanding Electric Range with 4 Coiled Elements, 4.8 cu. Ft. Self Clean Oven, Balanced Bake System, Storage Drawer and Electronic Controls	Unit price: \$409 Total Price: \$2045	\$2,250
Washing Machine  Suggested Model: Whirlpool WTW57ESWW – 4.0 Cu. Ft. 32-Cycle Super Capacity Plus Washer	\$530	\$583
Dryer Machine  Suggested Model: Whirlpool WED5300VW – 7.0 Cu. Ft. 12-Cycle Super Capacity Plus Electric Dryer	\$480	\$528
<b>Appliance Total:</b>		<b>\$6,659</b>

Curriculum Items	Unit Price	10% Increase
Cookbooks  I use cookbooks in my classroom for various activities. I will need a classroom set (at least 25 cookbooks) of various titles that would appeal to middle school aged students. Listed below are 25 samples from Amazon.com which will provide title suggestions and price guidelines.	\$15.30	

<u>Yum-o! The Family Cookbook</u> by Rachael Ray	\$9.32	
<u>Kid Food: Rachael Ray's Top 30 30-Minute Meals</u> by Rachael Ray	\$13.57	
<u>Pillsbury Kids Cookbook: Food Fun for Boys and Girls</u> by Pillsbury Editors	\$11.53	
<u>Better Homes and Gardens Snack Attack!</u> by Better Homes & Gardens	\$11.53	
<u>Betty Crocker's Kids Cook!</u> by Betty Crocker Editors	\$19.77	
<u>Better Homes and Gardens New Cook Book:</u> <u>Celebrating the Promise,</u> <u>14th Limited Edition "Pink Plaid"</u> by Better Homes & Gardens	\$10.85	
<u>Simple &amp; Delicious Cookbook: 242 Quick, Easy</u> <u>Recipes Ready in 10,</u> <u>20, or 30 Minutes</u> by Taste of Home	\$13.57	
<u>Semi-Homemade Weeknight Wonders: 139 Easy</u> <u>Fast Fix Dishes (Sandra Lee Semi-Homemade)</u> by Sandra Lee	\$14.21	
<u>Paula Deen's Cookbook for the Lunch-Box Set</u> by Paula Deen, et al.	\$9.32	
<u>The Cake Mix Doctor Returns!: With 160 All-New</u> <u>Recipes</u> by Anne Byrn	\$12.21	
<u>Crazy About Cupcakes</u> by Krystina Castella	\$13.57	
<u>Taste of Home: Casseroles, Slow Cooker, and</u> <u>Soups: Casseroles, Slow Cooker, and Soups: 536</u> <u>Family Pleasing Recipes</u> by Taste of Home	\$13.57	
<u>Sandwiches, Panini, and Wraps: Recipes for the</u> <u>Original Anytime and Anywhere Meal</u> by Dwayne Ridgaway	\$16.98	
<u>The Big Book of Soups and Stews: 262 Recipes for</u> <u>Serious Comfort Food</u> by Maryana Vollstedt	\$11.53	
<u>The Big Book of Breakfast: Serious Comfort Food</u> <u>for Any Time of the Day</u> by Maryana Vollstedt	\$16.55	
<u>Simple As 1 2 3: Campbells Recipes</u> by Ltd. Editors of Publications International	\$16.47	
	\$10.17	

<u>Cooking Rocks! Rachael Ray 30-Minute Meals for Kids</u> by Rachael Ray	\$12.89	
	\$9.95	
<u>Emeril's There's a Chef in My Soup! Recipes for the Kid in Everyone</u> by Emeril Lagasse (Author), Charles Yuen (Illustrator)	\$13.22	
<u>Betty Crocker Quick and Easy Cookbook: 30 minutes or less to dinner (Betty Crocker Books)</u> by Betty Crocker Editors	\$15.61	
<u>Betty Crocker Comfort Food: 100 Recipes for the Way You Really Cook</u> by Betty Crocker Editors	\$17.21	
<u>100-Calorie Snack Cookbook</u> by Sally Sampson, Kathy McManus		
<u>Ben &amp; Jerry's Homemade Ice Cream &amp; Dessert Book</u> by Ben Cohen, et al.		
<u>The Ultimate Frozen Dessert Book: A Complete Guide to Gelato, Sherbert, Granita, and Semmifreddo, Plus Frozen Cakes, Pies, Mousses, Chiffon Cakes, and ... of Ways to Customize Every Recipe to Your</u> by Bruce Weinstein, Mark Scarbrough		
<u>Pillsbury Best Muffins and Quick Breads Cookbook: Favorite Recipes from America's Most-Trusted Kitchen</u> by Pillsbury Editors		
<u>Pillsbury Best Cookies Cookbook: Favorite Recipes from America's Most-Trusted Kitchens</u> by Pillsbury Editors		
	<b>\$334</b>	<b>Total: \$367</b>
<b>Equipment Items</b>	<b>Unit Price</b>	<b>10% Increase</b>
Large Stand Mixer	\$349.99	\$384.99
Suggested Model: KitchenAid K5SSWH Heavy Duty Series 5-Quart Stand Mixer		
5 Waffle Bakers	Unit Price: \$29.99	\$164.95
Suggested Model: Black & Decker WBM500 Belgian Waffle Waffle Maker	Total Price: \$149.95	
10 Sewing Machines (basic)	Unit Price: \$209	\$2,299
Suggested Model:	Total Price: \$2090	

Janome Sewist 7318 Magnolia		
2 Sewing Machines (computerized) Suggested Model: Bernina activa 240	Unit Price: \$1625 Total Price: \$3250	\$3,575
2 Ironing Boards  Suggested Model: Seymour 7000496 Ironing Board	Unit Price: \$17.78 Total Price: \$35.56	\$39.12
2 Irons  Suggested Model: Panasonic NI-S300TR 1200-Watt Steam Iron with Curved Titanium-Coated Soleplate, White/Green	Unit Price: \$26.87 Total Price: \$53.74	\$59.11
Educational Videos  A total of 5 different videos will be needed to supplement kitchen safety and measuring instruction. The students start out in 6 <sup>th</sup> grade learning the basics of kitchen safety. This knowledge base is added to throughout 7 <sup>th</sup> and 8 <sup>th</sup> grade as the information (and recipes they create) becomes increasingly difficult. I tried to duplicate the titles being used currently, but in all cases the videos are no longer available. Possible titles are listed below.  Suggested Titles: (6 <sup>th</sup> grade) Kitchen Safety (Films Media Group) (7 <sup>th</sup> grade) Safety in the Kitchen (Films Media Group) (7 <sup>th</sup> grade) Kitchen Fundamentals: Common Tools and Terms (Films Media Group) (8 <sup>th</sup> grade) Kitchen Safety Smart (Learning Zone Xpress) (8 <sup>th</sup> grade) Measure Up in the Kitchen (Learning Seed)	Total Price: \$369    \$80 \$100 \$50 \$50 \$89	\$406
	<b>Equipment Total:</b>	<b>\$7,295</b>

## ***FACE Classroom Furniture Costs***

<b>FACE Classroom Furniture</b>	<b>Cost</b>	<b># Needed</b>	<b>Total</b>	<b>10% Increase</b>
Student Trapezoid Tables	\$123.89	13	\$1,610.57	\$1,771.63
Student Chairs	\$45.12	26	\$1,173.12	\$1,290.43
Rectangular Table	\$142.42	1	\$142.42	\$156.66
<b>Estimated Classroom Furniture Total:</b>				<b>\$3,219</b>



## ***Monona Grove – Winnequah FACE & Tech. Ed. Remodel Estimated Cost***

Below is a communication from Vogel Brothers regarding deductions for the scope of their work after the district decided not to remodel the FACE or Tech. Ed. Rooms at Winnequah. The prices quoted were from 2007, and the district received the following information on June 6, 2008.

Mike Huffman  
Huffman Facility Development – MGSD owner representative  
2301 Monona Drive  
Monona, WI 53716

Re: RFP #15 – Eliminate work at C071 and C072

Dear Mike:

Vogel Bros. quotes as follows for the additional scope of work:

Demo (Vogel)	Deduct:	\$	4,454
Masonry (Monona Masonry)	Deduct:	\$	2,531
Casework supply (Lance Service)	Deduct:	\$	6,500
Finish carpentry (Vogel)	Deduct:	\$	6,476
Glass/glazing (Portage Glass)	Deduct:	\$	246
Drywall (E&A Enterprise)	Deduct:	\$	1,008
Ceiling (Badger Acoustics)	Deduct:	\$	1,400
Flooring (Halverson)	Deduct:	\$	1,584
Epoxy flooring (bid amount)	Deduct:	\$	3,723
Painting (Schmelzer)	Deduct:	\$	865
Plumbing (MCI)	Deduct:	\$	1,443
HVAC (NAMI)	Deduct:	\$	3,410
Electrical (Electrical Solutions)	Deduct:	\$	16,924
Vogel Fee (2%)	Deduct:	\$	1,111
<b>Total</b>	<b>Deduct:</b>	<b>\$</b>	<b>51,675</b>

Includes:

No work within rooms C071 and C072. Will complete work at entrance to both rooms.

If you have any questions, please contact me at our office.

Sincerely,  
Vogel Bros. Building Co.

Jay Thomsen  
Project Engineer

### ***Estimated Construction/Remodel Costs for FACE & Tech. Ed. Classrooms at Winnequah***

Costs listed above	\$51,675
Add 15%	\$ 7,751
Vogel Remobilization Cost	\$10,000 (confirmed by Mark Scullion with Vogel)
<b>Estimated Construction/Remodel Costs</b>	<b>\$69,426</b>



Authorized Education Reseller  
Interior Concepts Furniture  
Wisconsin and Minnesota

December 4, 2009

**WINNEQUAH MIDDLE SCHOOL**  
**LAB FURNITURE PROPOSAL**

- To include:
- 10 2-student workstations (room perimeter)
  - 1 2-student corner workstation
    - With: 27" Work Surface Height
    - Melamine vertical surfaces
    - Laminate horizontal surfaces
    - Grommets / Cable trough for wire management
  - 10 Portable Work Tables
    - With: 30 x 84" Work Surface
    - 29" Work Surface Height
    - Fixed T-legs with Levelers
    - Laminate horizontal surfaces
  - 1 Instructor Corner Station
    - With: 2 File cabinets
    - 1 Armless Task Chair
    - Adjustable Keyboard
    - Melamine vertical surfaces
    - Laminate horizontal surfaces
    - Grommets / Cable trough for wire management
  - 24 Student Chairs
    - With: 5 caster base
    - Soft plastic shell

**Shipping, Complete Installation and Set-up**

**Total Furniture Package: \$21,859**

**Note:** Prices are valid for 90 days from above date and subject to change by the manufacturer.

Prepared For: Winnequah Middle School  
10/15/2009

LJ Reference:

**LJ Create**

85 Corporate Drive  
Holtsville, NY 11742  
P: 1-800-237-3482  
F: 631-759-1788  
W: www.ljcreate.com



**LJ CREATE**  
Learning for life

**STEM Laboratory**  
*Executive Pricing Summary*

Total for Teachers Resources	\$8,500.00
Total for Technology/Engineering Experiment Materials	\$43,450.00
Total for Science/Math Experiment Materials	\$3,060.00
Total for Training and Support	\$2,550.00
Sub-Total	\$57,560.00
Freight Charges	\$944.97
<b>Total Package Cost</b>	<b>\$58,504.97</b>

*Prices Valid for 90 Days*  
*Prices quoted FOB Destination*  
*Terms Net 30 Days*

*12 Month Warranty on all Products Manufactured by LJ Technical Systems*  
*Manufacturers Warranty on all Third Party Products*  
*Delivery 60 Days ARO*

Date: October 15, 2009  
 For: Winnequah Middle School  
 800 Greenway Rd  
 Monona WI 53716

**LJ Create**

85 Corporate Drive  
 Holtsville, NY 11742  
 P: 1-800-237-3482  
 F: 631-758-1788  
 W: www.ljcreate.com



**LJCREATE**  
 Learning for life

**STEM Laboratory**  
*Proposed Package contains:*

Qty	Item	Description	Cost \$(US)	Total \$(US)
<b>Teachers Demonstration/Management Resources</b>				
1	STEM01/SRS	STEM Presentations - SRS	\$1,200.00	\$1,200.00
1	ST560/SL	Academic Support	\$1,700.00	\$1,700.00
1	ST520/NTW	ClassAct NT - Networked Management System	\$2,400.00	\$2,400.00
1	ST520/SRF/24	ClassAct SRS System - RF (24 Response Units)	\$3,200.00	\$3,200.00
<b>Sub Total - Teachers Resources</b>				<b>\$8,500.00</b>

**Technology and Engineering Experiment Materials**

Qty	Item	Description	Cost \$(US)	Total \$(US)
1	ST120A	Construction - Materials and Structures Whole Class Module	\$2,300.00	\$2,300.00
1	ST140 ETP	Basic Electricity Whole Class Module	\$2,300.00	\$2,300.00
1	ST290 ETP	Industrial Control Technology Whole Class Module*	\$7,190.00	\$7,190.00
1	ST350 ETP	Materials and Processes Whole Class Module	\$4,900.00	\$4,900.00
<b>Complete Modules - Technology</b>				
1	ST200 ETP	Electronic Communications Whole Class Module	\$3,800.00	\$3,800.00
1	ST380 TTP	Digital Photography Theme Pack*** *** Contains 12X LS/RP	\$6,800.00	\$6,800.00
1	ST130/40-IP	Computer Aided Design 40 Hr- Instructor Pack	\$1,090.00	\$1,090.00
12	ST130/40-L	Computer Aided Design 40 Hr- Student Workstation PK	\$1,160.00	\$13,920.00
<b>Hardware Packs</b>				
1	ST120A/HP	Construction - Materials and Structures Hardware Pack	\$790.00	\$790.00
1	ST380/LS/HW	Digital Photogarphy TTP Hardware Pack	\$360.00	\$360.00
<b>Sub Total - Engineering Modules</b>				<b>\$43,450.00</b>

**Math and Business Skills**

<b>Qty</b>	<b>Item</b>	<b>Description</b>	<b>Cost \$(US)</b>	<b>Total \$(US)</b>
1	ST710/SL	Skills For Business-Site License	\$1,700.00	\$1,700.00
1	ST790 MTP	Math for STEM package - Site License	\$1,360.00	\$1,360.00
<b>Sub Total - Science/Math Modules</b>				<b>\$3,060.00</b>

**Installation, Training and Customer Support for STEM Resources**

<b>Qty</b>	<b>Item</b>	<b>Description</b>	<b>Cost \$(US)</b>	<b>Total \$(US)</b>
<i>Installation, Training and Customer Support</i>				
1	ST800/INST	Installation Per Day	\$1,200.00	\$1,200.00
1	ST800/PDU	Professional Development Unit (1 Day)	\$1,200.00	\$1,200.00
1	ST800/TC/AL	Telephone Support Contract - Annual License	\$150.00	\$150.00
<b>Sub Total - Installation and Support</b>				<b>\$2,550.00</b>

November 12, 2009

## **EPILOG ZING LASER**

### **ENGRAVING AND CUTTING SYSTEM**

The **Epilog Zing Laser** comes complete with laser, built-in 10Base-T Ethernet or USB connection, control software, high speed Micro Stepper motors, stores unlimited files up to 64MB. Compatible with Windows XP and Vista.

### **ZING LASER**

#### **Epilog Zing 16 Laser - 30W **\$ 9,015****

**Includes:** 16" x 12" Engraving Surface Area  
30 Watt Laser (air cooled all metal tube)  
2 in. (51mm) Focus Lens, Air Assist,  
Motorized Table, Red Dot Pointer, Relocatable Home,  
Laser Dashboard, User Reference Manual

#### **Options: Epilog Zing as above, with Upgrade to 40 Watt Laser **\$10,435****

Air Curtain Pump	\$ 350
CorelDraw Graphics Suite X4	\$ 128
Vector Grid for Zing	\$ 360
BOFA Base Z Fume Extractor System (with connection kit)	\$2,560

<b><u>Annual Extended Warranty Option:</u></b>	30 Watt System	\$ 525
	40 Watt System	\$ 600

#### **System Requirements:**

- 1.) The air curtain pump option should be purchased for the Epilog Laser unless your lab has an air source that can provide 30 to 60 PSI that is filtered and dried.
- 2.) It is recommended that this machine be connected to an external exhaust system and vented to the outside. Vent Requirements: 400cfm @ 6" static pressure

**Please note:** Zing Laser package price includes shipping, installation, set-up, testing, and initial instructor orientation. Additional shipping charges will apply if options are ordered separately from the machine.

*Prices valid for 90 days from above date and subject to change by the manufacturer.*

**CO2 Car Workstations**

3	ST255 CNC Mill Technology	\$ 10,700	\$32,100
3	CO2 Car Fixture and Curriculum	\$ 2,015	\$ 6,045
3	ICC Workstation Furniture (As Pictured)	\$ 850	\$ 2,550

Exclusive \* Tech Lab - Station#4 - Mobile Table

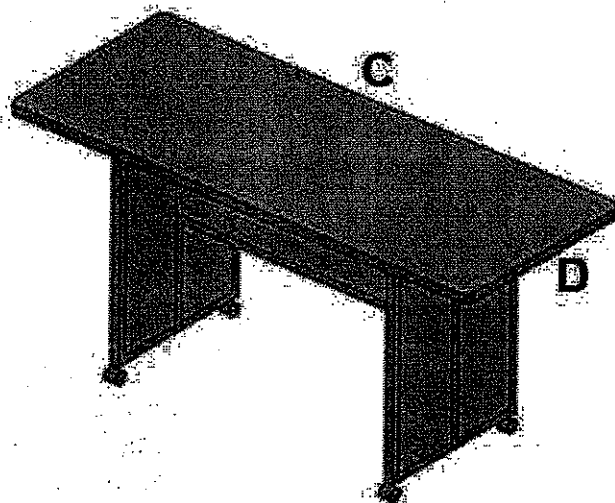

**Station 4 (Mobile Table)**

**Standard Features:**

Mobile Table  
 Half-height modesty panel

\*\* A floorplan **MUST** be provided to complete quote.

\*\* All sizes selected below will be provided unless we need to change a size to fit into the space provided on floorplan.

**Recommended Options  
 (as shown)**

Station #4 Width (C): 60in  
 Station #4 Depth (D): 24in  
 Worksurface Ht: 29in  
 Melamine Panel Material

**Video Room Furniture**

6	ICC Portable Workstation	\$850 each	\$5,100
---	--------------------------	------------	---------

This is the unit pictured above. This is a steel tube framed portable cart with high pressure laminate top and heavy duty casters. These tables are intended to handle heavy duty usage and can be moved together for projects or left around the perimeter as workstations.

**MONONA GROVE SCHOOL DISTRICT**  
**DECEMBER 22, 2009**

# **4K-8 Grade Configuration Study**

---

## **Projected Library Replication Costs**

<b>Estimated Cost to Replicate 7<sup>th</sup> and 8<sup>th</sup> Library Materials</b>	<b>\$29,100</b>
<b>Estimated Cost for Additional Shelving (conservative)</b>	<b>\$ 2,500</b>
<b><i>Total Estimated Library Costs</i></b> <b><i>Library Materials (1,200 volumes)</i></b>	<b><i>\$31,600</i></b>



## ***Duplication of 7<sup>th</sup> & 8<sup>th</sup> Grade Library Materials***

Prepared by Barbara Schmidt

This is an estimate of what it would cost to purchase 7<sup>th</sup> & 8<sup>th</sup> grade library materials for Winnequah School. This list was compiled by taking the instructional units, where I currently supply a cart of books to the teachers, and trying to recreate the content as closely as possible. I also added a line for some high interest, nonfiction materials that are not used in any specific class projects. Finally, I didn't find specific fiction titles but gave an estimate of the cost to provide 5 fiction books per student. It appears there would be about 110 students in the two grades total. I used Follett Titlewave, a major book vendor and supplier, to obtain the quotes.

In addition to the specific units, I also included the cost of Safari Montage. We have Safari Montage at Glacial Drumlin and teachers are shifting from using VHS and DVD videos to Safari Montage. I only included the video titles that are not available from Safari Montage at this time. We subscribe to the Core K-8 video package, the Video Encyclopedia 20<sup>th</sup> Century Content Package, and the Schlessinger Media K-8 package.

Besides cost there are programming implications that occur with adding 4<sup>th</sup> grade at Glacial Drumlin and 7 & 8<sup>th</sup> grade at Winnequah. First, it may become necessary to create a separate fiction section in our libraries since many of the materials that are appropriate and necessary for 7<sup>th</sup> and 8<sup>th</sup> grade students may not be appropriate for younger students. For example, Speak is an award winning, thoughtful, wonderfully written fiction book about date rape. While this book is appropriate for older students, it would not be in an elementary library. Splitting the collection that way will create another set of problems (i.e. the forbidden fruit problem).

In addition to the content of the collection issues, there will be issues in programming. 4<sup>th</sup> & 5<sup>th</sup> grade students have regularly scheduled library classes once a week making it difficult to adequately serve the 6<sup>th</sup> through 8<sup>th</sup> grade classes. If the fixed schedule class for the lower grades interferes with even one core class period for 7<sup>th</sup> & 8<sup>th</sup>, it will be very difficult to run collaborative units in the library. A core teacher isn't going to want to do a project with only some of his or her core classes.

### ***Estimate to Duplicate 7<sup>th</sup> & 8<sup>th</sup> Grade Library Materials***

	# of items	Current Cost	Ten Percent	Total
CultureGrams		555.00	55.50	\$610.50
Safari Montage -- streaming video in place of vhs or dvd purchases (annual cost)		1,790.00	179.00	\$1,969.00
Net Trekker		790.00	79.00	\$869.00
Career Books	43	1,825.00	182.50	\$2,007.50
Native American Unit	71	1,704.77	170.48	\$1,875.25
Health (7th grade bullying & drug use units)	40	1,064.00	106.40	\$1,170.40
Editorials	41	1,047.00	104.70	\$1,151.70
Diseases & Body Systems	65	2,603.00	260.30	\$2,863.30
Space & Universe	48	937.00	93.70	\$1,030.70
Biography - 1800's	57	1,123.00	112.30	\$1,235.30
Revolutionary War & Colonial	56	1,403.00	140.30	\$1,543.30
Poetry	37	545.00	54.50	\$599.50
Countries (Walk-about) Visual Geography 2nd ed.	99	2,371.00	237.10	\$2,608.10
Universe Videos (Planet Earth, The Universe)	2	105.00	10.50	\$115.50
History Videos (War that Made America \$35.00 -- We Shall Remain -\$56.00)	2	91.00	9.10	\$100.10
7th grade Social Studies Getting Ahead Country Videos	5	200.00	20.00	\$220.00
High Interest Non-Fiction Titles	73	1,156.00	115.60	\$1,271.60
Fiction 5 titles per student (higher lexile, high interest/low vocab, and more age appropriate subjects) approx cost \$14.00 per book	550	7,700.00	770.00	\$8,470.00
<b>Total</b>				<b>\$29,100</b>

## Poetry

### Books

FLR#	Title	Author	Yr Bnd RL	IL Qty 1st Price	Ext
10341P8	Alfred, Lord Tennyson	Tennyson, 03	HRD 5.8 5-8 1	12.70	12.70
38458E4	Animal poems		04 HRD 6.5 3-6 1	12.70	12.70
15146H0	Carl Sandburg	Sandburg, 95	HRD 3.9 5-8 1	12.70	12.70
03007Z1	Classic poetry : an illus		09 FBG 6.1 5-8 1	15.96	15.96
18323H0	Edgar Allan Poe	Poe, Edgar 95	HRD 6.3 5-8 1	12.70	12.70
18416W4	Edgar Allan Poe : "deep i Burlingame	09	HRD 7.8 5-8 1	23.95	23.95
10051K7	Edna St. Vincent Millay	Millay, Ed 99	HRD 5.2 5-8 1	12.70	12.70
05497M3	Edward Lear	Lear, Edwa 01	HRD 7.7 5-8 1	12.70	12.70
14500G0	Emily Dickinson	Dickinson, 94	HRD 4.2 5-8 1	12.70	12.70
14546F1	Hand in hand : an America		94 HRD 7.5 5-8 1	22.94	22.94
16195P5	Hour of freedom : America		03 HRD 7.6 5-8 1	14.40	14.40
03273R2	Keats, Shakespeare, and o Fandel, Je	06	HRD 7.6 5-8 1	22.96	22.96
10887S9	Langston Hughes	Hughes, La 06	HRD 4.1 3-6 1	12.70	12.70
04865L9	Lewis Carroll	Carroll, L 00	HRD 7.1 5-8 1	12.70	12.70
07499U2	Maya Angelou	Angelou, M 07	HRD 5.4 5-8 1	12.70	12.70
01758Y1	Maya Angelou : a creative Egan, Jill	09	HRD YA 1	26.96	26.96
10847R5	Metaphors, similes, and o Fandel, Je	06	HRD 5.9 5-8 1	22.96	22.96
22775T3	One hundred years of poet		07 PAP 6.6 5-8 1	8.41	8.41
32533Z5	Partly cloudy : poems of Soto, Gary	09	HRD YA 1	13.60	13.60
00450Z0	Poetry for beginners	Chapman, M 09	PAP AD 1	12.74	12.74
38410VX	Poetry matters : writing Fletcher, 02	FBG 6 5-8 1		10.96	10.96
21130R8	Puns, allusions, and othe Fandel, Je	06	HRD 5.7 5-8 1	22.96	22.96
23997RX	Rhyme, meter, and other w Fandel, Je	06	HRD 8.2 5-8 1	22.96	22.96
19225L7	Robert Browning	Browning, 01	HRD 5.5 5-8 1	12.70	12.70
10842G9	Robert Frost	Frost, Rob 94	HRD 6.5 5-8 1	12.70	12.70
01396K6	Robert Louis Stevenson	Stevenson, 00	HRD 4 3-6 1	12.70	12.70
25431K2	Rudyard Kipling	Kipling, R 00	HRD 4.2 3-6 1	12.70	12.70
13637Z7	Rules of the game : baseb Maddox, Ma	09	HRD 6.9 5-8 1	14.40	14.40
05770R7	The seasons		05 HRD 4.7 3-6 1	12.70	12.70
28641Z6	Stage a poetry slam : cre Smith, Mar	09	PAP AD 1	9.34	9.34
13351Q6	Wallace Stevens	Stevens, W 04	HRD 7.8 3-6 1	12.70	12.70
27423C4	Walt Whitman	Whitman, W 97	HRD 7.4 5-8 1	12.70	12.70
15281T3	William Blake	Blake, Wil 06	HRD 3.2 3-6 1	12.70	12.70
16148N9	William Butler Yeats	Yeats, W. 02	HRD 6.8 5-8 1	12.70	12.70
11614P1	William Carlos Williams	Williams, 04	HRD 6.3 5-8 1	12.70	12.70
21225L4	William Shakespeare	Shakespear 00	HRD 6.9 5-8 1	12.70	12.70
14283N4	William Wordsworth	Wordsworth 03	HRD 4.4 3-6 1	12.70	12.70

37 titles (qty 37) Total Guaranteed Title Price 544.90

## Biography of the 1800's

### Books

FLR#	Title	Author	Yr Bnd	RL	IL	Qty	1st	Price	Ext
22227Q4	100 African Americans who	Beckner, C	05	HRD	8.9	5-8	1	23.25	23.25
11082Q7	100 famous Americans who	Crompton,	05	HRD	8.3	5-8	1	23.25	23.25
09602Q1	100 Hispanic Americans wh	Laezman, R	05	HRD	8.9	5-8	1	23.25	23.25
30057V8	Abigail Adams : famous fi	Glass, May	04	FBS	4.2	5-8	1	15.86	15.86
13840S6	Abraham Lincoln : defende		05	HRD	7.2	5-8	1	15.26	15.26
25768F8	African American military	Haskins, J	98	HRD	6.9	5-8	1	21.20	21.20
24163Q4	Alexander Hamilton	McLeese, D	05	HRD	6.8	3-6	1	19.95	19.95
23191NX	Alexander Hamilton : Amer	DeGraw, Al	04	HRD	3.7	5-8	1	17.95	17.95
01683N9	Andrew Jackson	Harmon, Da	03	HRD	6.4	5-8	1	17.95	17.95
27805K3	Andrew Jackson : frontier	Whitelaw,	01	HRD	6	5-8	1	29.10	29.10
04705S2	Benjamin Banneker	Maupin, Me	10	HRD	4.3	5-8	1	19.95	19.95
26509R9	Benjamin Banneker : Ameri	Weatherly,	06	HRD	7.8	5-8	1	25.99	25.99
02241E8	Black Hawk : an autobiogr	Black Hawk	90	PAP	YA	1	16.95	16.95	
01784P8	Chief John Ross	Koestler-G	04	HRD	5.2	3-6	1	18.75	18.75
26280S6	David Crockett : fearless	Collard, S	07	HRD	4.1	3-6	1	23.94	23.94
11837J8	David Crockett : the man	Shackford,	94	PAP	YA	1	24.95	24.95	
06480P5	Dorothea Dix : advocate f	Muckenhoup	03	HRD	YA	1	35.59	35.59	
11113N0	Dorothea Dix : social ref	Witteman,	03	HRD	5.6	3-6	1	17.99	17.99
23204NX	Eli Whitney : the cotton	Huff, Rega	04	HRD	6.4	5-8	1	25.95	25.95
02983Q4	Elizabeth Blackwell : fir	Binns, Tri	05	HRD	5.6	5-8	1	21.35	21.35
11009R5	Elizabeth Cady Stanton : Miller,	Co	06	HRD	3.8	5-8	1	19.99	19.99
30828M6	Elizabeth Cady Stanton : Adiletta,		05	HRD	5.8	5-8	1	25.95	25.95
36905W6	The first woman doctor : Baker,	Rac	71	FBG	8.9	5-8	1	10.46	10.46
26712N2	Frederick Douglass : from Fleming,	A	04	HRD	6.4	5-8	1	25.95	25.95
20854Q5	Frederick Douglass : slav	Haugen, Br	05	HRD	5.5	5-8	1	25.99	25.99
20165R9	Harriet Beecher Stowe	Griskey, M	05	HRD	8.3	5-8	1	21.50	21.50
09213E5	Harriet Beecher Stowe : t	Elliot, He	10	FBS	7.4	5-8	1	14.46	14.46
37184W0	Harriet Tubman and the Un	Stearns, D	06	FBS	6.5	5-8	1	15.96	15.96
39674D5	Harriet Tubman / (DK Biog	Sawyer, Ke		HRD		5-8	1	12.74	12.74
<i>Not yet published: This item is scheduled to be available on February 1, 2010.</i>									
30897X3	"I am for equal rights" : Ruffin,	Fr	04	FBS	3.7	5-8	1	15.86	15.86
29975J4	John Brown Abolitionist	Brackett,	01	PAP		3-6	1	24.96	24.96
09254E8	John Brown : putting acti	Horn, Geof	10	FBS	5.9	5-8	1	14.46	14.46
32349V1	John C. Fremont	Souza, D.	04	FBS	6	5-8	1	12.86	12.86

38261X4	John James Audubon : wild Anderson, 95 FBS 5.5 5-8 1	11.26	11.26
30078V8	John Wesley Powell Souza, D. 04 FBS 6.5 5-8 1	12.86	12.86
07603S6	Levi Strauss and blue jea Olson, Nat 07 HRD 3.8 5-8 1	19.99	19.99
14431P5	The life and times of Ste Zannos, Su 04 HRD 8 5-8 1	21.50	21.50
36124X6	Mr. Blue Jeans : a story Weidt, Mar 90 FBS 6.2 3-6 1	13.66	13.66
09722R8	Noah Webster and the firs Fodde Meli 05 HRD 8.4 5-8 1	25.95	25.95
32233X2	On the frontier with Mr. Brenner, B 97 FBG 6.3 5-8 1	12.76	12.76
27245N0	Osceola, 1804-1838 Koestler-G 03 HRD 5.2 3-6 1	17.99	17.99
07185W7	Painting the wild frontie Reich, Sus 08 HRD 5.2 5-8 1	17.85	17.85
21216M3	Robert Fulton : and the d Pierce, Mo 03 HRD 6.8 5-8 1	25.95	25.95
10057N5	Robert Fulton : engineer Rosenberg, 03 HRD 4.9 3-6 1	18.95	18.95
06467P3	Sacagawea DeKeyser, 04 HRD 6.7 5-8 1	17.85	17.85
27560S4	Sacagawea : journey into Gunderson, 07 HRD 3.4 5-8 1	19.99	19.99
15401Q9	Samuel Morse and the stor Zannos, Su 05 HRD 7.3 5-8 1	21.50	21.50
16947W9	Samuel Morse and the tele Seidman, D 07 PAP 4.1 5-8 1	7.95	7.95
16775T8	Sequoyah : inventor of wr Basel, Rob 07 HRD 6.9 5-8 1	25.99	25.99
21609N9	Sequoyah : Native America Fitterer, 03 HRD 4.8 3-6 1	18.95	18.95
09970W7	Sisters against slavery : McPherson, 99 PAP 6.2 3-6 1	8.95	8.95
11862R6	Sojourner Truth Gillis, Je 06 HRD 4.8 3-6 1	18.75	18.75
34027W5	Sojourner Truth : ain't I McKissack, 92 FBG 6.6 5-8 1	10.46	10.46
29039N1	Susan B. Anthony Wheeler, J 03 HRD 6.2 5-8 1	18.95	18.95
21933M2	The Susan B. Anthony wome Monroe, Ju 02 HRD YA 1	19.95	19.95
19412V1	Tecumseh : a biography Sturgis, A 08 HRD YA 1	37.80	37.80
20487NX	Tecumseh : Shawnee leader Gregson, S 03 HRD 5.8 3-6 1	17.99	17.99

57 titles (qty 57) Total Guaranteed Title Price 1,123.37

# Space & Universe

## Books

FLR#	Title	Author	Yr	Bnd	RL	IL	Qty	1st	Price	Ext
07538X7	The 10 coolest wonders of Samuel, Ni	08 PAP	6.8	3-6	1			12.74	12.74	
09228U9	11 planets : a new view o Aguilar, D	08 HRD	6.4	3-6	1			14.40	14.40	
14130S6	300 astronomical objects Wilkins, J	06 HRD	YA	1				25.46	25.46	
13356T7	The 50 best sights in ast Schaaf, Fr	07 PAP	YA	1				16.96	16.96	
11782N0	A to Z of scientists in s Todd, Debo	05 HRD	YA	1				49.96	49.96	
05525U5	Asteroids, comets, and me Kortenkamp	08 HRD	2.9	K-3	1			15.99	15.99	
14963L3	Asteroids, comets, and me Kerrod, Ro	00 HRD	5.2	3-6	1			15.95	15.95	
39186B2	Asteroids, comets, and me Miller, Ro	06 HRD	8.9	5-8	1			20.95	20.95	
21839Z7	Asteroids, comets and met Mist, Rosa	08 HRD	4.3	K-3	1			16.98	16.98	
04193N1	Astronomy	Green, Dan	09 PAP	8.7	5-8	1		7.64	7.64	
22364X0	Astronomy	Lippincott	08 HRD	8.2	5-8	1		14.44	14.44	
24634P1	Astronomy demystified Gibilisco, 03	PAP	YA	1				21.95	21.95	
16717S6	Astronomy : essential fac Flynn, Mik	06 PAP	YA	1				9.34	9.34	
09908T6	Beyond the solar system : Parker, St	08 HRD	7	5-8	1			19.95	19.95	
16459P5	Black holes	Nardo, Don	04 HRD	7.7	5-8	1		23.96	23.96	
15632Q6	Black holes	Rau, Dana	05 HRD	5.4	K-3	1		17.99	17.99	
00880W7	Black holes	Than, Ker,	10 HRD	5.4	3-6	1		18.20	18.20	
21389C3	Black holes / (A True Boo Than, Ker	10 FBG	5.4	3-6	1			11.26	11.26	
<i>Not yet published: This item is scheduled to be available on March 1, 2010.</i>										
28084Q7	Black holes, pulsars, and Asimov, Is	05 HRD	6.3	3-6	1			19.50	19.50	
34943Q9	Chasing Hubble's shadows Kanipe, Je	07 PAP	AD	1				12.75	12.75	
25681P6	Comets, meteors, asteroid Bell, Trud	03 HRD	YA	1				20.96	20.96	
23995Y2	Copernicus : founder of m Andronik,	09 HRD	7.2	5-8	1			23.95	23.95	
05161T1	Deep space	Whitfield, 05	PAP	YA	1			5.46	5.46	
17732T5	Earth and its moon	Oxlade, Ch	08 HRD	6.2	5-8	1		19.95	19.95	
24933G7	An earthling's guide to d Sumners, C	99 PAP	6.7	5-8	1			12.95	12.95	
19655R7	Encyclopedia of space and Angelo, Jo	06 HRD	YA	1				84.96	84.96	
09990R9	Facts on File stars & pla Ridpath, I	04 HRD	7.4	5-8	1			18.95	18.95	
19551L3	Jupiter	Kerrod, Ro	00 HRD	5.2	3-6	1		15.95	15.95	
18624T2	Jupiter, Neptune, and the Oxlade, Ch	08 HRD	6.4	5-8	1			19.95	19.95	
31752X0	The last universe	Sleator, W	06 FBG	YA	1			10.66	10.66	
14403L8	Mars	Kerrod, Ro	00 HRD	5.2	3-6	1		15.95	15.95	
14523L6	Mercury and Venus	Kerrod, Ro	00 HRD	4.9	3-6	1		15.95	15.95	
26896T7	Mercury, Mars and the oth Oxlade, Ch	08 HRD	5.7	5-8	1			19.95	19.95	
26915S6	The mystery of black hole Oxlade, Ch	06 HRD	6.5	3-6	1			20.50	20.50	
09844L1	Planet Earth	Kerrod, Ro	00 HRD	5.1	3-6	1		15.95	15.95	
11927Z8	Pluto and other dwarf pla Hayhurst,	07 HRD	5.7	5-8	1			20.95	20.95	
31799V0	Probing deep space	Sparrow, G	07 FBS	8.1	5-8	1		15.96	15.96	
26459L6	The solar system	Kerrod, Ro	00 HRD	5.7	3-6	1		15.95	15.95	
24008T1	Space objects : comets, a Parker, St	08 HRD	6.7	5-8	1			19.95	19.95	
38548W0	Space rocks : a look at a Waldeck, A	02 FBS	4.6	3-6	1			12.86	12.86	
15814Q9	Space stations	Kerrod, Ro	05 HRD	8.9	5-8	1		23.25	23.25	

33426W5 Stars and planets	Kerrod, Ro 00 FBS 3.5 3-6 1	12.86	12.86
18816R5 Stars & planets	Stott, Car 05 HRD 5.7 5-8 1	10.96	10.96
07228L6 The sun	Kerrod, Ro 00 HRD 5 3-6 1	15.95	15.95
27508T2 The sun	Parker, St 08 HRD 6.2 5-8 1	19.95	19.95
25819M6 Universe	Couper, He 00 PAP YA 1	19.54	19.54
34771V3 Universe	Kerrod, Ro 03 FBS 7.6 5-8 1	17.26	17.26
01973R1 Universe	05 HRD YA 1	42.50	42.50

48 titles (qty 48) Total Guaranteed Title Price 936.35

## Body systems & Diseases Unit

### Books

FLR#	Title	Author	Yr	Bnd	RL	IL	Qty	1st	Price	Ext
13709U7	The ADHD update : underst	Silverstei	08	HRD	6.6	5-8	1	23.95	23.95	
00755U2	Aids	James, Ott	10	HRD	6.9	5-8	1	23.98	23.98	
27442YX	AIDS and other epidemics	Ballard, C	09	HRD	8.6	5-8	1	23.25	23.25	
29148U3	Alcoholism	Wyborny, S	08	HRD	8.7	5-8	1	25.96	25.96	
00187V1	Alcoholism / (Perspective	Langwith,		HRD	YA		1	27.96	27.96	
25610L1	Alzheimer's disease	Altman, Li	01	HRD	8.9	5-8	1	25.96	25.96	
22671M1	Arthritis	Sheen, Bar	02	HRD	8.9	5-8	1	25.96	25.96	
06660Q1	Asthma	Bjorklund,	05	HRD	5.7	3-6	1	26.22	26.22	
20023K6	Asthma	Greenberg,	00	HRD	YA		1	14.70	14.70	
17832V7	Asthma : the ultimate tee	Paquette,	06	PAP	YA		1	14.95	14.95	
17776R3	The asthma update	Silverstei	06	HRD	6.6	5-8	1	23.95	23.95	
26066W9	Autism	Freedman,	09	HRD	YA		1	21.95	21.95	
13207W1	Autism and Asperger syndr	Rodriguez,	09	HRD	YA		1	24.95	24.95	
18448T3	The breast cancer update	Silverstei	08	HRD	6.7	5-8	1	23.95	23.95	
21607Q9	Breathe easy! : a teen's	Ford, Jean	05	HRD	YA		1	24.95	24.95	
21891R1	Cancer	Silverstei	06	HRD	YA		1	24.95	24.95	
03719Q7	Cancer	Silverthor	09	HRD	8.5	5-8	1	25.96	25.96	
12972R2	Cancer treatments	Wyborny, S	06	HRD	8.9	5-8	1	20.96	20.96	
08071X9	Cerebral palsy / (Perspec	Langwith,		HRD	YA		1	28.80	28.80	
<i>Not yet published: This item is scheduled to be available on September 24, 2010.</i>										
38545J2	The circulatory system	Mertz, Les	04	HRD	YA		1	77.70	77.70	
20827L7	Depression	Moragne, W	01	HRD	YA		1	24.95	24.95	
26466W0	The depression and bipola	Silverstei	09	HRD	7.1	5-8	1	23.95	23.95	
17839P9	Diabetes	Bryan, Jen	04	HRD	6.4	5-8	1	22.96	22.96	
04889RX	The diabetes update	Silverstei	06	HRD	5.7	5-8	1	23.95	23.95	
37144G4	The digestive system	Windelspec	04	HRD	YA		1	77.70	77.70	
27432Q8	Dyslexia	Clark, Ard	05	HRD	8.2	5-8	1	25.96	25.96	
07671R8	[Multi-Volume Set] Encyclopedia of famil								549.95	
	Encyclopedia of family he		05	HRD	YA		1	549.95		
38536G9	The endocrine system	Watson, St	04	HRD	YA		1	77.70	77.70	
19223L2	Epilepsy	Goodfellow	01	HRD	8.9	5-8	1	25.96	25.96	
01305T5	Fighting infectious disea	Ballard, C	07	HRD	8.9	5-8	1	25.50	25.50	
12455R4	The flu and pneumonia upd	Silverstei	06	HRD	7.3	5-8	1	23.95	23.95	
23207N1	Germes	Nardo, Don	03	HRD	8.4	5-8	1	23.96	23.96	



10374Q7	Heart, blood, and lungs	Parker, St 05 HRD 8.9 5-8 1	19.50	19.50
26748QX	Heart disease	Sheen, Bar 04 HRD 8.9 5-8 1	25.96	25.96
16037S0	Heart disease	Silverstei 06 HRD YA 1	24.95	24.95
22518Q1	Hepatitis	Horn, Lyle 05 HRD 8.9 5-8 1	34.95	34.95
10663T4	Human body systems : main	Katz Coope 07 HRD 7.3 5-8 1	20.99	20.99
17511Y5	Infectious mononucleosis	Marcovitz, 08 HRD 8.3 5-8 1	25.96	25.96
24571S4	Influenza : the next pand	Goldsmith, 07 HRD YA 1	24.95	24.95
27396S6	Lou Gehrig's disease	Abramovitz 06 HRD 8.9 5-8 1	25.96	25.96
20768W4	Lung cancer	Sheen, Bar 08 HRD 8.4 5-8 1	25.96	25.96
02695U1	The lungs : a graphic nov	Dunn, Joem 10 HRD 4.2 3-6 1	18.95	18.95
01816V2	Lungs : injury, illness a	Ballard, C 09 HRD 6.6 5-8 1	21.96	21.96
23290K3	Lyme disease	Silverstei 00 HRD 6 5-8 1	17.85	17.85
39167J2	The lymphatic system	McDowell, 04 HRD YA 1	77.70	77.70
13471S0	Meningitis	Grabowski, 07 HRD 8.9 5-8 1	25.96	25.96
26619P4	Multiple sclerosis	Burnfield, 04 HRD 6 5-8 1	22.96	22.96
05353W5	Muscular dystrophy	Johanson, 09 HRD YA 1	21.95	21.95
38173D6	The muscular system	Adams, Amy 04 HRD YA 1	77.70	77.70
37801D0	The nervous system and se	McDowell, 04 HRD YA 1	77.70	77.70
10626W5	Obsessive-compulsive diso	Hyman, Bru 09 HRD YA 1	24.95	24.95
38047JX	The reproductive system	Hollen, Ka 04 HRD YA 1	77.70	77.70
38225G9	The respiratory system	Petechuk, 04 HRD YA 1	77.70	77.70
32652V3	Schizophrenia	Landau, El 04 FBS 5.9 5-8 1	11.26	11.26
16968W9	Sickle cell anemia	Peterson, 09 HRD YA 1	21.95	21.95
14380S9	The sickle cell anemia up	Silverstei 06 HRD 6.8 5-8 1	23.95	23.95
38398G0	The skeletal system	Kelly, Eve 04 HRD YA 1	71.95	71.95
22669P8	Smallpox	Saffer, Ba 03 HRD 7.7 5-8 1	25.96	25.96
07757W5	Spina bifida	Watson, St 09 HRD YA 1	21.95	21.95
15952M2	Tourette syndrome	Brill, Mar 02 HRD YA 1	24.95	24.95
26708S0	Tuberculosis	Allman, To 07 HRD 8.9 5-8 1	25.96	25.96
07931U3	Tuberculosis	Yancey, Di 08 HRD YA 1	24.95	24.95
10213R4	The tuberculosis update	Silverstei 06 HRD 6 5-8 1	23.95	23.95
38318GX	The urinary system	Watson, St 04 HRD YA 1	71.95	71.95
26399UX	Weight and health	Murphy, We 08 HRD YA 1	24.95	24.95

65 titles (qty 65) Total Guaranteed Title Price 2,603.49

## Editorials

### Books

FLR#	Title	Author	Yr	Bnd	RL	IL	Qty	1st	Price	Ext
23070U1	Abortion		07	HRD	YA	1		26.96	26.96	
13571W9	The abortion debate : und Haney, Joh		09	HRD	YA	1		23.95	23.95	
17361S7	Advertising		07	HRD	YA	1		26.96	26.96	
00908U3	Alternative medicine		09	HRD	YA	1		27.76	27.76	
22359SX	Animal rights		06	HRD	YA	1		26.96	26.96	
22802R6	Anorexia	Lynette, R	06	HRD	7.2	3-6	1	20.96	20.96	
00277V0	Anorexia and bulimia	Silverthor	10	HRD	8.9	5-8	1	25.96	25.96	
26007F9	Anorexia nervosa : when f Smith, Eri		99	HRD	5.5	YA	1	21.95	21.95	
02520Z6	Athletes and drug use		09	HRD	YA	1		26.96	26.96	
00726W7	The battle for oil / (Und Wells, Don		07	PAP	8.9	5-8	1	11.95	11.95	
00281V3	Body image / (Hot Topics) Lankford,		09	HRD		5-8	1	25.96	25.96	
<i>Not yet published: This item is scheduled to be available on February 19, 2010.</i>										
20183Y4	Body talk : the straight	Douglas, A	06	FBG	7.4	5-8	1	13.66	13.66	
08031X3	Censorship / (Introducing			HRD	YA	1		27.76	27.76	
0JOCQ46	The challenges of No Chil Irons, E.		07	HRD	AD	1		49.96	49.96	
11551R6	Cloning		06	HRD	YA	1		26.96	26.96	
08046X6	Death penalty / (Introduc Friedman,			HRD	YA	1		27.76	27.76	
<i>Not yet published: This item is scheduled to be available on November 5, 2010.</i>										
17909W2	Dress codes in schools		08	HRD	YA	1		27.76	27.76	
26767S1	Drunk driving		07	HRD	YA	1		26.96	26.96	
15852Y5	Eating disorders		09	HRD	YA	1		26.96	26.96	
07105W6	The eating disorders upda	Silverstei	09	HRD	6.9	5-8	1	23.95	23.95	
24678S0	Energy alternatives		06	HRD	YA	1		26.96	26.96	
08034X5	Fast food / (Introducing			HRD	YA	1		27.76	27.76	
<i>Not yet published: This item is scheduled to be available on April 30, 2010.</i>										
08047X3	Free speech / (Introduc Friedman,			HRD	YA	1		27.76	27.76	
<i>Not yet published: This item is scheduled to be available on November 19, 2010.</i>										
10108Y6	Garbage and recycling		09	HRD	YA	1		26.96	26.96	
12726R9	Gay marriage		06	HRD	YA	1		26.96	26.96	
18277R8	Genetic engineering		06	HRD	YA	1		26.96	26.96	
26435S1	Gun control		07	HRD	YA	1		26.96	26.96	
05219U1	Homosexuality		08	HRD	YA	1		26.96	26.96	
20626W9	Mixed messages : interpre	Palad, The	09	HRD	7	5-8	1	22.95	22.95	

37288W5 No body's perfect : stori Kirberger, 03 FBG 7.2 5-8 1 15.96 15.96

04633U8 Organic food and farming HRD YA 1 26.96 26.96

*Not yet published: This item is scheduled to be  
available on December 18, 2009.*

17840Z1 Reflections of me : girls Hirschmann 09 HRD 5.7 5-8 1 20.99 20.99

08053X0 Sports and athletes / (In Merino, No HRD YA 1 27.76 27.76

*Not yet published: This item is scheduled to be  
available on August 20, 2010.*

24718M9 Steroids Adams, Jac 06 HRD 8.9 5-8 1 25.96 25.96

24034P9 Steroids Fitzhugh, 04 HRD 7.6 5-8 1 23.96 23.96

15424SX Steroids = busted! Mintzer, R 06 HRD 7.2 5-8 1 23.95 23.95

04882T5 Students' rights 09 HRD YA 1 26.96 26.96

21880W9 Taking a stand : being a Ehrman, M. 09 HRD 6.1 5-8 1 22.95 22.95

08825E4 Taking action against eat Warbrick, 10 FBS 8.9 5-8 1 17.66 17.66

08060X5 Video games / (Introducun Hamilton, HRD YA 1 27.76 27.76

*Not yet published: This item is scheduled to be  
available on October 16, 2010.*

41 titles (qty 41) Total Guaranteed Title Price 1,047.12

## Native American Unit

### Books

FLR#	Title	Author	Yr	Bnd	RL	IL	Qty	1st Price	Ext
21407S4	100 Native Americans who	Juettner, 03	PAP	YA	1			5.96	5.96
28091P3	The Algonquian of New Yor	Oestreich, 03	HRD	6.8	3-6	1		21.95	21.95
13872R1	[Multi-Volume Set] American Indian contr							174.96	
	American Indian contribut Keoke, Emo 05							HRD 6.2 5-8 1	174.96
27782P8	The American Indian wars	Dolan, Edw 03	HRD	6.8	5-8	1		22.95	22.95
18067N8	The Anasazi culture at Me Crewe, Sab	03	HRD	6.4	3-6	1		19.50	19.50
28293K8	The Apache	Bial, Raym 00	HRD	6.5	5-8	1		30.80	30.80
18307V1	Atlas of the North Americ	Waldman, C 09	PAP	YA	1			24.95	24.95
15925R6	The Buffalo soldiers and	Glaser, Ja 06	HRD	4.5	5-8	1		19.99	19.99
27481MX	Chumash tribe	Boule, Mar 92	PAP	5.3	5-8	1		11.29	11.29
14208R2	The Cree	Bial, Raym 06	HRD	8	5-8	1		30.80	30.80
17394Y7	Early American Indian tri	Patterson, 05	PAP	5.8	3-6	1		5.84	5.84
12663W8	Early Native North Americ	Nardo, Don 08	HRD	YA	1			25.96	25.96
14372M8	Eastern Miwok tribe	Boule, Mar 92	PAP	5.2	5-8	1		11.29	11.29
20326M0	Eastern & Southeastern Po	Boule, Mar 92	PAP	5.6	5-8	1		11.29	11.29
18924S0	Encyclopedia of Native Am	Waldman, C 06	HRD	YA	1			74.96	74.96
22284C6	Geronimo : Apache freedom	Hermann, S 97	HRD	6.2	5-8	1		19.95	19.95
08106M6	Homes of the Native Ameri	Williams, 03	HRD	5.8	5-8	1		19.95	19.95
31227W2	How we saw the world : ni	Taylor, C. 93	FBS	4.9	3-6	1		12.86	12.86
20653M4	Hunting with the Native A	Staeger, R 03	HRD	5.5	5-8	1		19.95	19.95
19406M0	Hupa tribe	Boule, Mar 92	PAP	5.2	5-8	1		11.29	11.29
11085KX	The Huron	Bial, Raym 00	HRD	6.2	5-8	1		30.80	30.80
11555Q7	The Indian wars	00	PAP	6.3	5-8	1		8.95	8.95
DC31XX5	[Set/Series] Indians Of Nort (14 titles)							HRD YA 1	419.44
01140R7	The Apache	Melody, Mi 06	HRD	YA	1			29.96	
19132R5	The Arapaho	Fowler, Lo 06	HRD	YA	1			29.96	
16554R0	The Blackfeet	Lacey, The 06	HRD	YA	1			29.96	
16211Q9	The Cherokees	Perdue, Th 05	HRD	6.9	YA	1		29.96	
10786R8	The Cheyenne	Hoig, Stan 06	HRD	7.2	YA	1		29.96	
18025Q2	The Choctaw	McKee, Jes 05	HRD	YA	1			29.96	
14978Q7	The Comanche	Rollings, 05	HRD	8.1	YA	1		29.96	
15346Q5	The Hopi	Bonvillain 05	HRD	6.9	YA	1		29.96	
16575Q2	The Iroquois	Graymont, 05	HRD	8.9	YA	1		29.96	
27204Q2	The Mohawk	Bonvillain 05	HRD	8.8	YA	1		29.96	
15447R6	The Navajo	Iverson, P 06	HRD	YA	1			29.96	
03443R4	The Pawnee	Lacey, The 06	HRD	YA	1			29.96	
27350Q0	The Teton Sioux	Bonvillain 05	HRD	8.8	YA	1		29.96	
08212RX	The Zuni	Bonvillain 06	HRD	YA	1			29.96	

25854PX	The Inuit	Williams, 03 HRD 5.5 5-8 1	17.85	17.85
11268M6	Ipai-Tipai tribes (Diegue Boule, Mar 92 PAP 6.3 5-8 1	11.29	11.29	
11348M9	It is a good day to die : Viola, Her 01 PAP 6 5-8 1	12.95	12.95	
28195F6	The Kiowa	Sherrow, V 97 HRD 5.9 5-8 1	21.95	21.95
39023W9	Leaders of the American R Anderson, 06 FBS 8.1 5-8 1	18.26	18.26	
39043XX	Lewis and Clark on their Sapp, Rich 06 FBS 7.4 5-8 1	15.96	15.96	
28136R3	Lewis and Clark through I	06 HRD AD 1	21.25	21.25
17807P5	Meet Naiche : a Native bo Tayac, Gab 04 HRD 6.4 5-8 1	19.50	19.50	
28853H0	The Menominee	Ricciuti, 97 HRD 5.9 5-8 1	21.95	21.95
02118MX	Mohave tribe	Boule, Mar 00 PAP 5.7 5-8 1	11.29	11.29
23413NX	Native America	Greig, Cha 03 HRD 7.6 5-8 1	19.95	19.95
13629RX	Native American art & cul January, B 05 HRD 7 5-8 1	22.96	22.96	
15396M4	Native American confedera Carew-Mill 03 HRD 7.7 5-8 1	19.95	19.95	
12329M8	Native American cooking Carew-Mill 03 HRD 6.6 5-8 1	19.95	19.95	
01582M8	Native American family li Williams, 03 HRD 8 5-8 1	19.95	19.95	
28714M8	Native American festivals Glatzer, J 03 HRD 8.1 5-8 1	19.95	19.95	
18490MX	Native American horsemen Aykroyd, C 03 HRD 5.8 5-8 1	19.95	19.95	
14651M4	Native American languages Patrick, B 03 HRD 6.4 5-8 1	19.95	19.95	
14651M4	Native American languages Patrick, B 03 HRD 6.4 5-8 1	19.95	19.95	
16437T0	Native American life	Clare, Joh 06 PAP 7.8 5-8 1	6.46	6.46
07346M8	Native American medicine Orr, Tamra 03 HRD 6.3 5-8 1	19.95	19.95	
16776M8	Native American religions Staeger, R 03 HRD 5.4 5-8 1	19.95	19.95	
15967M5	Native American sports an Staeger, R 03 HRD 5.6 5-8 1	19.95	19.95	
15967M5	Native American sports an Staeger, R 03 HRD 5.6 5-8 1	19.95	19.95	
04580M7	Native American tribes : Boule, Mar 02 PAP 5.8 5-8 1	11.29	11.29	
39958V5	Native Americans and the Ray, Kurt. 04 FBG 6.9 5-8 1	15.86	15.86	
34079V3	The Navajo	Woods, Ger 02 FBS 6.3 5-8 1	12.86	12.86
23085L0	Navajo code talkers : Nat Jones, Cat 97 PAP 8.6 5-8 1	12.90	12.90	
02173NX	The Powhatan : a confeder Boraas, Tr 03 HRD 6 3-6 1	17.99	17.99	
27560S4	Sacagawea : journey into Gunderson, 07 HRD 3.4 5-8 1	19.99	19.99	
16487F8	The Shawnee	Fulkerson, 92 HRD 6.3 5-8 1	21.95	21.95
27212M1	What the Native Americans Williams, 03 HRD 8.6 5-8 1	19.95	19.95	
28410R3	Wilma Mankiller : chief o Dell, Pame 06 HRD 5.9 5-8 1	25.99	25.99	
11492Z9	Yuman and Yaqui music	Densmore, 09 HRD AD 1	57.95	57.95
21419M6	Yurok tribe	Boule, Mar 92 PAP 5.6 5-8 1	11.29	11.29

58 titles (qty 71) Total Guaranteed Title Price 1,704.77

## Career Unit

### Books

FLR#	Title	Author	Yr Bnd	RL	IL Qty	1st Price	Ext
UB20XX0	[Set/Series] Becoming A . . . (4 titles)		PAP	YA	1		50.80
00408Y9	Becoming a border patrol		09 PAP	AD	1	12.70	
03980Y2	Becoming a nurse	Muscari, M	09 PAP	YA	1	12.70	
00410Y7	Becoming a police officer		09 PAP	AD	1	12.70	
03988Y0	Becoming a teacher.		09 PAP	YA	1	12.70	
JK97XX4	[Set/Series] Career Resource (18 titles)		HRD	YA	1		431.10
17449K2	Careers as a disc jockey	Weigant, C	99 HRD	YA	1	23.95	
12791N4	Careers in alternative me	Steinfeld, 03	HRD	YA	1	23.95	
20291L5	Careers in animal care an	Marinelli, 01	HRD 5.8	YA	1	23.95	
17587M5	Careers in banking and fi	Haddock, P	01 HRD 8.9	YA	1	23.95	
17959L4	Careers in child care	Bowman-Kru	00 HRD	YA	1	23.95	
25576F9	Careers in fiber optics	Smith, Bri	98 HRD 8.9	YA	1	23.95	
24093L7	Careers in magazine publi	Rocha, Ton	01 HRD	YA	1	23.95	
03616M7	Careers in modeling	O'Donnell, 01	HRD	YA	1	23.95	
06104M2	Careers in outer space :	Willett, E	02 HRD	YA	1	23.95	
17121K5	Careers in social work	Simpson, C	99 HRD 6.2	YA	1	23.95	
26501F2	Careers in starting and b	Frisch, Ca	99 HRD 7.4	YA	1	23.95	
04338L4	Careers in television	Nagle, Jea	01 HRD 5.7	YA	1	23.95	
21269L9	Careers in the movies	Johnson, M	01 HRD	YA	1	23.95	
15822N6	Careers in trucking	Schauer, D	03 HRD	YA	1	23.95	
20701N1	Careers in urban planning	Houghton, 03	HRD	YA	1	23.95	
01376MX	Careers in video and digi	Allman, Pa	01 HRD	YA	1	23.95	
28983L8	Careers in Web design	Oleksy, Wa	01 HRD	YA	1	23.95	
22581F5	Exploring careers in cybe	Fulton, Mi	98 HRD 8.1	YA	1	23.95	
14881R5	Careers in focus. Agricul		06 HRD	YA	1	32.95	32.95
28151V2	Careers in focus. Art.		08 HRD	YA	1	32.95	32.95
25540V7	Careers in focus. Automot		09 HRD	YA	1	32.95	32.95
17983V1	Careers in focus. Busines		09 HRD	YA	1	32.95	32.95
22974U5	Careers in focus. Chemist		08 HRD	YA	1	32.95	32.95
27640S7	Careers in focus. Child c		06 HRD	YA	1	32.95	32.95
02160V7	Careers in focus. Coaches		08 HRD	YA	1	32.95	32.95

07614K4	Careers in focus. Complem	09 HRD	YA	1	32.95	32.95
25515U6	Careers in focus. Cosmeto	08 HRD	YA	1	32.95	32.95
17557VX	Careers in focus. Educati	09 HRD	YA	1	32.95	32.95
01157G4	Careers in focus. Electro	09 HRD	YA	1	32.95	32.95
16106SX	Careers in focus. Fashion	07 HRD	YA	1	32.95	32.95
25232T2	Careers in focus. Food.	07 HRD	YA	1	32.95	32.95
08738S1	Careers in focus. Interne	06 HRD	YA	1	32.95	32.95
27271U8	Careers in focus. Landscap	08 HRD	YA	1	32.95	32.95
22071U4	Careers in focus. Mechani	08 HRD	YA	1	32.95	32.95
17603T8	Careers in focus. Persona	07 HRD	YA	1	32.95	32.95
13304S2	Careers in focus. Real es	06 HRD	YA	1	32.95	32.95
01165G6	Careers in focus. Sales.	09 HRD	YA	1	32.95	32.95

01186PX [Multi-Volume Set] Cool careers. 467.96

Cool careers. 10 HRD 4.6 5-8 1 467.96

23689T8 [Multi-Volume Set] Encyclopedia of careers 249.95

Encyclopedia of careers a 08 HRD YA 1 249.95

23 titles (qty 43) Total Guaranteed Title Price 1,825.86

## Revolutionary War & Colonial Times

### Books

FLR#	Title	Author	Yr Bnd	RL	IL	Qty	1st Price	Ext
19563L4	100 colonial leaders who	Crompton, 99	PAP	YA	1		5.96	5.96
15435X4	African-American soldiers	Raatma, Lu 09	HRD	6.7	5-8	1	19.99	19.99
15026S2	The age of colonialism	Nardo, Don 06	HRD	8.1	5-8	1	25.96	25.96
08428XX	American colonial --estab	Nardo, Don	HRD	5-8	1		25.96	25.96
<i>Not yet published: This item is scheduled to be available on September 10, 2010.</i>								
06145Y3	American colonial --Polit	Nardo, Don	HRD	5-8	1		25.96	25.96
<i>Not yet published: This item is scheduled to be available on September 10, 2010.</i>								
08426X5	American colonial --relig	Nardo, Don	HRD	5-8	1		25.96	25.96
<i>Not yet published: This item is scheduled to be available on September 10, 2010.</i>								
32728V3	The American colonies dec	Anderson, 06	FBS	8.9	5-8	1	15.96	15.96
32613X1	The American Revolution	DeFord, De 07	FBS	7.1	5-8	1	15.96	15.96
17656P9	The American Revolution		04 HRD	YA	1		28.96	28.96
27017N5	Benedict Arnold : revolut	Powell, Wa 04	HRD	7.3	5-8	1	25.95	25.95
21613R4	Betsy Ross : a flag for a	Cox, Vicki 06	HRD	6.5	5-8	1	29.96	29.96
15102W9	The Bill of Rights	Taylor-But 08	FBS	5.2	3-6	1	11.26	11.26
32404V5	The causes of the America	Anderson, 06	FBS	8.2	5-8	1	15.96	15.96
10445R9	Causes of the American Re	Strum, Ric 05	HRD	8.4	5-8	1	21.40	21.40
23776N6	Colonial America		03 HRD	YA	1		28.96	28.96
07811K3	Colonial America 1543-176		HRD	5-8	1		34.96	34.96
<i>Not yet published: This item is scheduled to be available on April 1, 2010.</i>								
21367U3	[Multi-Volume Set] Colonial settlements						239.96	
	Colonial settlements in A		07 HRD	7.9	5-8	1	239.96	
14046Q4	Colonial Williamsburg	Coleman, W 05	HRD	8.2	5-8	1	18.95	18.95
22604S8	The colony of Connecticut	Miller, Ja 06	HRD	6.5	3-6	1	15.95	15.95
19093S3	The colony of Delaware :	Miller, Ja 06	HRD	6.6	3-6	1	15.95	15.95
11404S9	The colony of Georgia : a	Mis, Melod 07	HRD	5.9	3-6	1	15.95	15.95
11635S6	The colony of Maryland :	Mis, Melod 07	HRD	6.3	3-6	1	15.95	15.95
28658S6	The colony of Massachuset	Miller, Ja 06	HRD	5	3-6	1	15.95	15.95
25707S9	The colony of New Hampshi	Mis, Melod 07	HRD	6.4	3-6	1	15.95	15.95
22223S1	The colony of New Jersey	Miller, Ja 06	HRD	6.3	3-6	1	15.95	15.95



14508S7	The colony of New York : Mis, Melod 07 HRD 5.4 3-6 1	15.95	15.95
02319S7	The colony of North Carol Mis, Melod 07 HRD 5.9 3-6 1	15.95	15.95
20681S8	The colony of Pennsylvani Mis, Melod 07 HRD 6.2 3-6 1	15.95	15.95
20854S1	The colony of Rhode Islan Miller, Ja 06 HRD 6.7 3-6 1	15.95	15.95
03170S3	The colony of Virginia : Miller, Ja 06 HRD 6.4 3-6 1	15.95	15.95
30551S7	The Constitution Finkelman, 06 HRD 6 5-8 1	13.56	13.56
19860J2	Daily life in colonial Am 93 HRD YA 1	16.12	16.12
07468U6	Daily lives of civilians 07 HRD YA 1	64.96	64.96
13527S8	The Declaration of Indepe Fradin, De 07 HRD 6.7 3-6 1	25.09	25.09
18135R2	The Emancipation proclama McComb, Ma 06 HRD 6 5-8 1	25.80	25.80
39896V0	Forming a new American go Anderson, 06 FBS 7.5 5-8 1	15.96	15.96
24599R7	Franklin Delano Roosevelt Haugen, Br 06 HRD 6.6 5-8 1	25.99	25.99
28396NX	Generals of the Revolutio Wukovits, 03 HRD 7 5-8 1	23.96	23.96
24285R5	George Washington : Ameri McNeese, T 06 HRD 6.3 5-8 1	29.96	29.96
38751V9	George Washington, spymas Allen, Tho 04 FBG 7.3 5-8 1	10.46	10.46
07708W0	The Holocaust Tonge, Nei 09 HRD 8.3 5-8 1	19.95	19.95
24986R0	The Holocaust : a primary Bartel, Ju 06 HRD 8.2 5-8 1	23.25	23.25
24547R0	Key battles of the Americ Anderson, 06 HRD 7 5-8 1	23.25	23.25
04990S4	The life and times of Sam Gibson, Ka 07 HRD 7.4 5-8 1	21.50	21.50
28899R1	The Lost Colony of Roanok Miller, Ja 06 HRD 5.7 3-6 1	15.95	15.95
36004Y6	Night Wiesel, Ei 06 HRD YA 1	16.96	16.96
14917RX	The patriots win the Amer Anderson, 06 HRD 7.2 5-8 1	23.25	23.25
21543Y5	Pearl Harbor : a primary Gorman, Ja 09 HRD 6.5 5-8 1	26.35	26.35
11262S1	Primary source accounts o Deem, Jame 06 HRD 7.9 5-8 1	24.95	24.95
03957S5	Primary source accounts o Hendrickso 06 HRD 6.6 5-8 1	24.95	24.95
15481S6	Primary source accounts o Bozonelis, 06 HRD 7.4 5-8 1	24.95	24.95
00687V9	The Revolutionary War : a Raum, Eliz 10 HRD 4.1 5-8 1	20.99	20.99
14016S1	The Spanish-American War Poulakidas 06 HRD 5.1 3-6 1	15.95	15.95
09455T9	The surrender of Cornwall Heinrichs, 07 HRD 6.8 5-8 1	19.99	19.99
28448XX	Understanding the Declara Isaacs, Sa 09 HRD 5.7 3-6 1	19.95	19.95
24858XX	Understanding the U.S. Co Isaacs, Sa 09 HRD 5.7 3-6 1	19.95	19.95

56 titles (qty 56) Total Guaranteed Title Price 1,403.43

## Health (7<sup>th</sup> grade Harassment unit & Drug Use Unit)

### Books

FLR#	Title	Author	Yr Bnd	RL	IL	Qty	1st Price	Ext
18784W0	Addiction treatment : esc	Walker, Id	08	HRD	YA	1	24.95	24.95
13866V7	Alcohol	Smith, Ter	08	HRD	7.9	5-8	1	29.96
08029X5	Alcohol / (Introducing Is			HRD	YA	1	27.76	27.76
10313W0	Amphetamines and other st	Warburton, 08	HRD	8.9	5-8	1	29.96	29.96
27382U7	Bullying		08	HRD	YA	1	26.96	26.96
13819R4	Bullying : how to deal wi	Winkler, K	05	HRD	YA	1	23.95	23.95
0V9VZ88	Cigarettes, cigarettes : Traynor, P	93	PAP	3-6	1		7.95	7.95
15782SX	Cocaine	Connolly, 07	HRD	8.5	5-8	1	22.95	22.95
26427Q3	Cocaine	Lennard-Br	05	HRD	8.9	5-8	1	23.96
28651Q9	Cocaine and crack	Aretha, Da	05	HRD	6.8	5-8	1	18.95
01687V3	Dealing with bullying	Murphy, Al	09	HRD	YA	1	34.96	34.96
18557V4	Diet pills	Breguet, A	09	HRD	8.7	5-8	1	29.96
25554S8	Drug abuse		07	HRD	YA	1	26.96	26.96
14767V3	Ecstasy and other club dr	Koellhoffe	08	HRD	8.6	5-8	1	29.96
13568S0	The facts about caffeine	Klosterman	07	HRD	8.5	5-8	1	34.22
15914R2	The facts about depressan	Klosterman	06	HRD	8.1	5-8	1	34.22
22289T1	The facts about drug depe	Klosterman	08	HRD	8.1	5-8	1	34.22
19541T2	The facts about drugs and	Klosterman	08	HRD	8.4	5-8	1	34.22
16362T8	The facts about the A-Z o	Naden, Cor	08	HRD	7.3	5-8	1	34.22
26435V6	Heroin	Cobb, Alla	09	HRD	8.8	5-8	1	29.96
15969V3	How to say no to drugs	Kreske, Da	08	HRD	7.2	5-8	1	29.96
25252V1	Inhalants and solvents	Koellhoffe	08	HRD	7.2	5-8	1	29.96
33289Z9	Marijuana	Ingram, Sc	08	HRD	8.7	5-8	1	29.96
06692U8	Marijuana		07	HRD	YA	1	26.96	26.96
28065Q1	Marijuana		05	HRD	YA	1	28.96	28.96
18595V5	Nicotine	Price, Sea	08	HRD	8.7	5-8	1	29.96
09445R6	Nicotine and tobacco	Green, Car	05	HRD	6.3	5-8	1	18.95
24441V4	Over-the-counter drugs	Knowles, J	08	HRD	6.9	5-8	1	29.96
13112R5	Prescription drug abuse	Fitzhugh, 06	HRD	6.8	5-8	1	22.96	22.96
22251K0	Prescription drug abuse	Roberts, J	00	HRD	6.7	YA	1	21.95
05279V8	Prozac and other antidepr	Koellhoffe	08	HRD	8.9	5-8	1	29.96
25298R8	Smoking		06	HRD	YA	1	27.76	27.76
25353V4	Steroids and other perfor	West, Kris	08	HRD	7.9	5-8	1	29.96

02197S2	Taking action against bul Bingham, J	10 HRD 5.9 5-8 1	19.95	19.95
02474S4	Taking action against dru Bailey, Ja	10 HRD 7 5-8 1	19.95	19.95
24385XX	Teen rights (and responsi Truly, Tra	05 FBG YA 1	19.96	19.96
29115Y5	Tobacco Connolly, 08 FBS	7.9 5-8 1	13.66	13.66
19602Q5	Tobacco Pollard, J 05 HRD	5.6 5-8 1	22.96	22.96
22788L6	Tobacco and your mouth : Sommers, M	00 HRD 5.5 5-8 1	19.95	19.95
15351V6	Vicodin, OxyContin, and o Breguet, A	08 HRD 7.8 5-8 1	29.96	29.96

40 titles (qty 40) Total Guaranteed Title Price 1,063.90

## Countries (7<sup>th</sup> grade walk-about)

### Books

FLR#	Title	Author	Yr Bnd	RL	IL	Qty	1st	Price	Ext
25100N4	Afghanistan in pictures	Behnke, Al	03	HRD	8.9	5-8	1	23.95	23.95
05294U6	Algeria in pictures	DiPiazza, 08	HRD	7.2	5-8	1	23.95	23.95	
27656N6	Argentina in pictures	Streissgut 03	HRD	8.9	5-8	1	23.95	23.95	
01585W1	Armenia in pictures	Waters, Be	09	HRD	7.2	5-8	1	23.95	23.95
18118P5	Australia in pictures	Kerns, Ann	04	HRD	8.7	5-8	1	23.95	23.95
06833W4	Bangladesh in pictures	Streissgut 09	HRD	8.2	5-8	1	23.95	23.95	
04121UX	Belize in pictures	Streissgut 10	HRD	8.4	5-8	1	23.95	23.95	
21410U6	Bolivia in pictures	DiPiazza, 08	HRD	7.6	5-8	1	23.95	23.95	
26776S0	Bosnia-Herzegovina in pic	Englar, Ma	07	HRD	8	5-8	1	23.95	23.95
23743Y5	Botswana in pictures	Behnke, Al	09	HRD	7.5	5-8	1	23.95	23.95
06526NX	Brazil in pictures	Streissgut 03	HRD	8.9	5-8	1	23.95	23.95	
16181R6	Bulgaria in pictures	Goldstein, 05	HRD	7.9	5-8	1	23.95	23.95	
02871PX	Cambodia in pictures	Goldstein, 04	HRD	8.3	5-8	1	23.95	23.95	
13515N6	Canada in pictures	Braun, Eri	03	HRD	8.7	5-8	1	23.95	23.95
23632Y6	Central African Republic	Doeden, Ma	09	HRD	8.1	5-8	1	23.95	23.95
12252Y9	Chad in pictures	Zuchora-Wa	09	HRD	7.4	5-8	1	23.95	23.95
19630T4	Chile in pictures	DiPiazza, 07	HRD	7.5	5-8	1	23.95	23.95	
04396N4	China in pictures	Behnke, Al	03	HRD	8.9	5-8	1	23.95	23.95
21041PX	Colombia in pictures	Streissgut 04	HRD	8.9	5-8	1	23.95	23.95	
09719Q4	Costa Rica in pictures	Streissgut 04	HRD	8.9	5-8	1	23.95	23.95	
07049Q6	Cuba in pictures	Campbell, 05	HRD	8.9	5-8	1	23.95	23.95	
35335KX	Czech Republic in picture	Taus-Bolst	03	HRD	8.9	5-8	1	23.95	23.95
01361U2	Democratic Republic of Co	DiPiazza, 08	HRD	7.4	5-8	1	23.95	23.95	
28346U5	Dominican Republic in pic	Zuchora-Wa	08	HRD	8.3	5-8	1	23.95	23.95
14837W8	Ecuador in pictures	Behnke, Al	09	HRD	8.1	5-8	1	23.95	23.95
23872N2	Egypt in pictures	Zuehlke, J	03	HRD	8.9	5-8	1	23.95	23.95
29157QX	Ethiopia in pictures	Zuehlke, J	05	HRD	8.9	5-8	1	23.95	23.95
17284N5	Germany in pictures	Zuehlke, J	03	HRD	8.9	5-8	1	23.95	23.95
19784P8	Ghana in pictures	La Pierre, 04	HRD	8.8	5-8	1	23.95	23.95	
23346P1	Guatemala in pictures	Markel, Ri	04	HRD	8.9	5-8	1	23.95	23.95
04122U7	Guyana in pictures	Sirvaitis, 10	HRD	8.9	5-8	1	23.95	23.95	
02148RX	Haiti in pictures	Goldstein, 06	HRD	8.2	5-8	1	23.95	23.95	
04123U4	Honduras in pictures	Zuchora-Wa	10	HRD	8.9	5-8	1	23.95	23.95

28208N1	India in pictures	Engfer, Le 03	HRD 8.9	5-8	1	23.95	23.95
12440R1	Indonesia in pictures	Zuehlke, J 06	HRD 8.9	5-8	1	23.95	23.95
24995P3	Iran in pictures	Taus-Bolst 04	HRD 8.9	5-8	1	23.95	23.95
28527PX	Iraq in pictures	Taus-Bolst 04	HRD 8.9	5-8	1	23.95	23.95
25141P3	Israel in pictures	Goldstein, 04	HRD 8.3	5-8	1	23.95	23.95
16781P2	Ivory coast in pictures	Hamilton, 04	HRD 8.6	5-8	1	23.95	23.95
16869RX	Jamaica in pictures	Hamilton, 05	HRD 8.9	5-8	1	23.95	23.95
22027R1	Jordan in pictures	Zuehlke, J 05	HRD 8.9	5-8	1	23.95	23.95
10642T4	Kazakhstan in pictures	Waters, Be 07	HRD 7.4	5-8	1	23.95	23.95
01239N9	Kenya in pictures	Broberg, C 03	HRD 8.9	5-8	1	23.95	23.95
11614T4	Kuwait in pictures	DiPiazza, 07	HRD 7.9	5-8	1	23.95	23.95
17623T0	Laos in pictures	Doeden, Ma 07	HRD 7.9	5-8	1	23.95	23.95
24628Q2	Lebanon in pictures	Goldstein, 05	HRD 8.1	5-8	1	23.95	23.95
11850S3	Liberia in pictures	Streissgut 06	HRD 8.2	5-8	1	23.95	23.95
11554R8	Libya in pictures	DiPiazza, 06	HRD 8.6	5-8	1	23.95	23.95
28564W0	Malawi in pictures	De Capua, 09	HRD 7.9	5-8	1	23.95	23.95
24737S3	Malaysia in pictures	DiPiazza, 06	HRD 8.6	5-8	1	23.95	23.95
25275TX	Mali in pictures	DiPiazza, 07	HRD 7.7	5-8	1	23.95	23.95
23864M2	Mexico in pictures	Hamilton, 03	HRD 8.9	5-8	1	23.95	23.95
25594S3	Morocco in pictures	DiPiazza, 07	HRD 8.2	5-8	1	23.95	23.95
08003Y7	Mozambique in pictures	Streissgut 09	HRD 7.8	5-8	1	23.95	23.95
12928U9	Myanmar in pictures	Streissgut 08	HRD 7	5-8	1	23.95	23.95
25657W8	Namibia in pictures	Streissgut 09	HRD 8.2	5-8	1	23.95	23.95
01668W6	Nepal in pictures	Zuchora-Wa 09	HRD 7.9	5-8	1	23.95	23.95
19550R5	New Zealand in pictures	Di Piazza, 06	HRD 8.6	5-8	1	23.95	23.95
26600S7	Nicaragua in pictures	Dall, Chri 07	HRD 8.6	5-8	1	23.95	23.95
03009U5	Niger in pictures	Behnke, Al 08	HRD 8.2	5-8	1	23.95	23.95
26056N9	Nigeria in pictures	Hamilton, 03	HRD 8.9	5-8	1	23.95	23.95
11525Q8	North Korea in pictures	Behnke, Al 05	HRD 8.9	5-8	1	23.95	23.95
24052N0	Norway in pictures	Braun, Eri 03	HRD 8.9	5-8	1	23.95	23.95
22459N4	Pakistan in pictures	Taus-Bolst 03	HRD 8.9	5-8	1	23.95	23.95
01313R0	Panama in pictures	Streissgut 05	HRD 8.5	5-8	1	23.95	23.95
04124U1	Paraguay in pictures	Behnke, Al 10	HRD 8.9	5-8	1	23.95	23.95
20228P4	Peru in pictures	Marquez, H 04	HRD 8.1	5-8	1	23.95	23.95
28655S4	Philippines in pictures	Sexton, Co 06	HRD 8.5	5-8	1	23.95	23.95
09455S0	Poland in pictures	Zuehlke, J 06	HRD 8.9	5-8	1	23.95	23.95
22170P1	Puerto Rico in pictures	Tagliaferr 04	HRD 8.9	5-8	1	23.95	23.95

22920S8	Romania in pictures	Kerns, Ann 07	HRD 8.3	5-8	1	23.95	23.95
01342P6	Russia in pictures	Marquez, H 04	HRD 8.9	5-8	1	23.95	23.95
24829U3	Rwanda in pictures	Streissgut 08	HRD 7.7	5-8	1	23.95	23.95
21623U5	El Salvador in pictures	DiPiazza, 08	HRD 7.3	5-8	1	23.95	23.95
07298N7	Saudi Arabia in pictures	Broberg, C 03	HRD 8.9	5-8	1	23.95	23.95
02339D7	Senegal in pictures	Streissgut 09	HRD 8	5-8	1	23.95	23.95
26099S7	Serbia and Montenegro in	Behnke, Al 07	HRD 8.9	5-8	1	23.95	23.95
19252TX	Somalia in pictures	Hamilton, 07	HRD 7.4	5-8	1	23.95	23.95
10446PX	South Africa in pictures	Hamilton, 04	HRD 8.9	5-8	1	23.95	23.95
16397Q9	South Korea in pictures	Behnke, Al 05	HRD 8.9	5-8	1	23.95	23.95
35965B8	Spain in pictures	Taus-Bolst 04	HRD 8.9	5-8	1	23.95	23.95
09571SX	Sri Lanka in pictures	Hoffmann, 06	HRD 8.9	5-8	1	23.95	23.95
13274S1	Sudan in pictures	DiPiazza, 06	HRD 8.2	5-8	1	23.95	23.95
04125U9	Suriname in pictures	Streissgut 10	HRD 8.9	5-8	1	23.95	23.95
01765R9	Syria in pictures	Behnke, Al 05	HRD 8.9	5-8	1	23.95	23.95
10619U4	Taiwan in pictures	Behnke, Al 08	HRD 8.3	5-8	1	23.95	23.95
22362U1	Tanzania in pictures	Pritchett, 08	HRD 7.7	5-8	1	23.95	23.95
19799P0	Thailand in pictures	Taus-Bolst 04	HRD 8.9	5-8	1	23.95	23.95
16678QX	Turkey in pictures	DiPiazza, 05	HRD 8.9	5-8	1	23.95	23.95
11702R2	Uganda in pictures	Braun, Eri 06	HRD 8.7	5-8	1	23.95	23.95
36785B4	United Kingdom in picture	Campbell, 04	HRD 8.9	5-8	1	23.95	23.95
09645U1	United States in pictures	Streissgut 08	HRD 8.9	5-8	1	23.95	23.95
04126U6	Uruguay in pictures	Behnke, Al 10	HRD 8.9	5-8	1	23.95	23.95
05756S6	Uzbekistan in pictures	Waters, Be 07	HRD 7.7	5-8	1	23.95	23.95
18241Q7	Venezuela in pictures	Aalgaard, 05	HRD 8.9	5-8	1	23.95	23.95
15818N3	Vietnam in pictures	Taus-Bolst 03	HRD 8.9	5-8	1	23.95	23.95
22825U5	Yemen in pictures	DiPiazza, 08	HRD 7.4	5-8	1	23.95	23.95
08723Z6	Zambia in pictures	Waters, Be 09	HRD 7.5	5-8	1	23.95	23.95
16208R1	Zimbabwe in pictures	Di Piazza, 05	HRD 8.9	5-8	1	23.95	23.95

99 titles (qty 99) Total Guaranteed Title Price 2,371.05

## High Interest Non-Fiction

### Books

FLR#	Title	Author	Yr	Bnd	RL	IL	Qty	1st	Price	Ext
18989N4	Apache helicopter : the	A Pitt, Matt	00	FBS	4.5	YA	1	10.96	10.96	
36626WX	Baseball : becoming a gre	Fitzgerald	00	FBS	5.4	YA	1	11.16	11.16	
36557W0	Basketball stars	Shea, Ther	07	FBS	5.4	YA	1	11.26	11.26	
01535T5	The Battle of Midway : th	White, Ste	07	HRD	6.5	5-8	1	21.95	21.95	
23540T1	The Battle of the Bulge : Cain, Bill		08	HRD	6.9	5-8	1	21.95	21.95	
32315V3	Behind enemy lines : a yo	DeMallie,	07	FBG	5.6	5-8	1	11.86	11.86	
08545S5	Bigfoot caught on film : Teitelbaum		08	HRD	7.5	5-8	1	18.90	18.90	
28275E0	Bombers of World War II	Robinson M	98	HRD	4.8	5-8	1	17.99	17.99	
27643U5	Bowhunting	Weintraub,	08	HRD	4.9	5-8	1	17.99	17.99	
30708WX	Crisis in space : Apollo	Beyer, Mar	02	FBS	5.2	YA	1	11.16	11.16	
22364J6	Darkness over Denmark : t	Levine, El	00	HRD	6.8	5-8	1	22.46	22.46	
13957Q2	Debunked! : esp, telekine	Charpak, G	04	HRD		YA	1	30.78	30.78	
23886U5	Deer hunting	Frahm, Ran	08	HRD	5	5-8	1	17.99	17.99	
S771XX9	[Set/Series] Edge Books: War (11 titles)			HRD		YA	1		197.89	
07532Q6	Aircraft carriers : the	N Green, Mic	05	HRD	3.2	YA	1	17.99		
25003Q5	Armored personnel carrier	Green, Mic	05	HRD	5.1	YA	1	17.99		
16766Q4	Attack submarines : the	S Green, Mic	05	HRD	4.2	YA	1	17.99		
16411QX	Destroyers : the Arleigh	Green, Mic	05	HRD	3.8	YA	1	17.99		
08597Q5	High mobility vehicles : Healy, Nic		05	HRD	3.6	YA	1	17.99		
13728P1	Infantry fighting vehicle	Green, Mic	04	HRD	4.6	YA	1	17.99		
15479P3	Main battle tanks : the	M Green, Mic	04	HRD	4.3	YA	1	17.99		
25775P4	Remotely piloted aircraft	Green, Mic	04	HRD	6.2	YA	1	17.99		
19853Q5	Self-propelled howitzers	Green, Mic	05	HRD	4.3	YA	1	17.99		
01613Q9	Super Cobra attack helico	Green, Mic	05	HRD	5.3	YA	1	17.99		
13593Q7	Weapons carrier helicopte	Green, Mic	05	HRD	5.3	YA	1	17.99		
16080Q5	ESP	Herbst, Ju	05	HRD	6.4	5-8	1	19.95	19.95	
21538L9	Essential boating for tee	Thompson,	00	HRD	7.4	YA	1	17.15	17.15	
23909L8	Essential camping for tee	Hooks, Kri	00	HRD	6.7	YA	1	17.15	17.15	
15460L9	Essential fishing for tee	Fitzgerald	00	HRD	2.8	YA	1	17.15	17.15	
23442L5	Essential hiking for teen	Hooks, Kri	00	HRD	6.1	YA	1	17.96	17.96	
32905W8	Essential snowmobiling fo	Payan, Gre	00	FBS	6.7	YA	1	11.26	11.26	

37141W3	Extreme sports stars	Abraham, P 07 FBS 5.2	YA 1	11.26	11.26
36017X6	Fashion	Rivera, Ur 04 FBS 7.5	YA 1	11.26	11.26
37223X9	The FBI	Ramaprian, 03 FBS 6.4	YA 1	11.26	11.26
38294X5	Football stars	Buckman, V 07 FBS 5	YA 1	11.26	11.26
27504S5	Ghosts : and real-life gh	Teitelbaum 08 HRD 6.1	5-8 1	18.90	18.90
04461Z2	Ghosts : the unsolved mys	McCormick, 09 HRD 4	5-8 1	16.99	16.99
33682W5	Gladiators : battling in	Frew, Kath 05 FBS 6.6	YA 1	11.26	11.26
26946Y1	The great escape : the lo	Meserole, 08 FBG 6.1	5-8 1	11.86	11.86
23722J2	High flight : a story of	Granfield, 99 HRD 6	5-8 1	13.56	13.56
37780G3	Hiroshima : the story of	Lawton, CI 04 HRD 7.4	5-8 1	16.14	16.14
33466V2	Hockey stars	Shea, Ther 07 FBS 4.2	YA 1	11.26	11.26
30469X7	Jet ski	Thompson, 01 FBS 5.7	YA 1	11.26	11.26
39493W5	Jon Krakauer's adventure	Werther, S 02 FBS 5.7	YA 1	11.26	11.26
35885L7	Left for dead : a young m	Nelson, Pe 02 PAP 8.9	5-8 1	5.82	5.82
34177V4	Life in the Army Special	Kennedy, R 00 FBS 7.5	YA 1	11.16	11.16
21100LX	Life of a Nazi soldier	Cartlidge, 01 HRD 7.4	5-8 1	23.96	23.96
34002V8	Machu Picchu : city in th	Somervill, 05 FBS 6.4	YA 1	11.26	11.26
20320U2	Media violence	Allman, To 07 HRD 3.4	YA 1	23.95	23.95
32215W6	Military robots	White, Ste 07 FBS 5.6	YA 1	11.26	11.26
28543W0	Mind readers : science ex	Tilden, Th 08 FBS 6.3	5-8 1	11.96	11.96
07520N0	Mountain biking	Weintraub, 03 HRD 5.7	YA 1	18.38	18.38
09637S3	Mummies unwrapped! : the	Grace, N. 08 HRD 5.8	5-8 1	18.90	18.90
16090X9	No pretty pictures : a ch	Lobel, Ani 08 FBG 5	5-8 1	12.86	12.86
34463W3	The other victims : first	Friedman, 90 FBG 8.1	5-8 1	11.96	11.96
24082T9	Pearl Harbor : a day of i	White, Ste 07 HRD 5.6	5-8 1	21.95	21.95
37074X7	Pioneers : adventure in a	Burnett, L 05 FBS 6.6	YA 1	11.26	11.26
35642R8	Remember WW II : kids who	05 HRD 6.3	5-8 1	15.26	15.26
37455W5	Samurai : warlords of Jap	Dean, Arla 05 FBS 5.2	YA 1	11.26	11.26
30086X6	The secret of Priest's Gr	Taylor, Pe 07 FBG 7.9	5-8 1	13.66	13.66
30516W0	The Shackleton expedition	Fine, Jil. 02 FBS 6.4	YA 1	11.26	11.26
31105V1	Shark attacks	Fitzgerald 00 FBS 6	YA 1	11.26	11.26
36841W7	Snowboarding	Brown, Gil 03 FBS 6.1	YA 1	11.26	11.26
27792MX	Space exploration	Beyer, Mar 02 HRD 6.8	YA 1	16.80	16.80
16518R4	The story of the attack o	Whiting, J 06 HRD 7.1	5-8 1	21.50	21.50
21784R1	The story of the Holocaus	Whiting, J 06 HRD 5.7	5-8 1	21.50	21.50
39043V3	Tank of tomorrow : Stryke	Hama, Larr 07 FBS 5.8	YA 1	11.26	11.26
33317X9	Terra-cotta soldiers : ar	Dean, Arla 05 FBS 8.1	YA 1	11.26	11.26



15537S3 UFOs : what scientists sa Grace, N. 08 HRD 6.2 5-8 1 18.90 18.90  
38538X2 Unmanned aerial vehicles Hama, Larr 07 FBS 4.8 YA 1 11.26 11.26  
21515L4 Volunteering to help with Isler, Cla 00 HRD 6.1 YA 1 16.80 16.80  
15492Q3 World War II Adams, Sim 04 HRD 7.7 5-8 1 19.99 19.99  
18943U2 World War II Harris, Na 08 HRD 7.9 5-8 1 22.96 22.96  
26484W9 World War II, 1939-1945 Black, Her 08 HRD 6.4 5-8 1 22.96 22.96

63 titles (qty 73) Total Guaranteed Title Price 1,156.28

**MONONA GROVE SCHOOL DISTRICT**  
**DECEMBER 22, 2009**

# **4K-8 Grade Configuration Study**

---

## **Projected Music Replication Expenses**

### ***Band***

Band Equipment Replication Estimated Costs	\$ 34,709
Band Instrument Replication Estimated Costs	\$ <u>78,381</u>
	\$113,090

### ***Choir***

Classroom Furniture Estimated Costs	\$ 4,481
Choral Music and Text Estimated Costs	\$ <u>1,485</u>
	\$ 5,966

### ***Orchestra***

Orchestra Equipment and Music Estimated Costs	\$ 32,823
Orchestra Instrument Replication Estimated Costs	\$ <u>16,280</u>
	\$ 49,103

Accoustical Shell (Shared Music Department Item)	\$ 11,000
--	-----------

Stereo Sound System (connected to band, choir, orchestra rooms & computer work stations)	\$ ?
--	------

Note: Wenger Chairs at list price will likely cost less if bidded out. Additional staff additive costs may occur if concerts are separated by community.

<b>Total Projected Costs for Band, Choir, and Orchestra</b>	<b>\$179,159</b>
---	------------------

# Winnquah School Band Equipment Needed for 4K-8 Configuration

Item		No.	Indiv. Cost	Mult. Cost	Plus 10%	Total
Drum set		1	\$1,000.00	\$1,000.00	\$100.00	\$1,100.00
Timpani	Ludwig 23"	1	\$2,430.00	\$2,430.00	\$243.00	\$2,673.00
Timpani	Ludwig 32"	1	\$2,430.00	\$2,430.00	\$243.00	\$2,673.00
Snare Drums and stands	Yamaha GSM1450	2	\$788.00	\$1,576.00	\$157.60	\$1,733.60
Xylophone	Yamaha YX335 w/cover	1	\$1,644.00	\$1,644.00	\$164.40	\$1,808.40
Suspended Cymbal	Zildjian 20" ZIK1014	1	\$350.00	\$350.00	\$35.00	\$385.00
Suspended Cymbal Stand	Pearl C100SC Gooseneck	1	\$75.00	\$75.00	\$7.50	\$82.50
Gong	Zildjian P0499 26"	1	\$300.00	\$300.00	\$30.00	\$330.00
Gong Stand	Zildjian P0560 stand	1	\$179.00	\$179.00	\$17.90	\$196.90
Gong Beater	Vic Firth GB1	1	\$35.00	\$35.00	\$3.50	\$38.50
Chimes (wind chimes)	Meinl 27-bar chimes	1	\$80.00	\$80.00	\$8.00	\$88.00
Boom stand for chimes	Sound Perc. - SP880BS	1	\$40.00	\$40.00	\$4.00	\$44.00
Classic Chimes	Musser M635B	1	\$3,269.00	\$3,269.00	\$326.90	\$3,595.90
Temple blocks	Ludwig LE104	1	\$150.00	\$150.00	\$15.00	\$165.00
Temple blocks stand	Ludwig Pearl or Yamaha	1	\$65.00	\$65.00	\$6.50	\$71.50
Toms & stands	Yamaha CTS0234B 10-14	1	\$1,430.00	\$1,430.00	\$143.00	\$1,573.00
Triangle	Alan Abel 6"	1	\$56.00	\$56.00	\$5.60	\$61.60
Triangle beater	Ludwig LULE1337	1	\$4.99	\$4.99	\$0.50	\$5.49
Cowbell	Latin Percussion LP228	1	\$28.99	\$28.99	\$2.90	\$31.89
Woodblock	Ludwig LE774	1	\$20.99	\$20.99	\$2.10	\$23.09
Claves - rosewood or	HT4338	1	\$12.99	\$12.99	\$1.30	\$14.29
Maracas	LP281 Latin Percussion	1	\$20.00	\$20.00	\$2.00	\$22.00
Guiro	Latin Percussion LP243	1	\$30.00	\$30.00	\$3.00	\$33.00
Shaker	Rhythm Tech RT2030 -red	1	\$23.00	\$23.00	\$2.30	\$25.30
Hand Bells	Harris Teller HT3568	1	\$30.00	\$30.00	\$3.00	\$33.00
Cabasa	Rhythm Tech RT8000	1	\$30.00	\$30.00	\$3.00	\$33.00
Tambourine	Latin Percussion CP392	1	\$30.00	\$30.00	\$3.00	\$33.00
Finger Cymbals	Zildjian, pair (thick) P0771	1	\$16.00	\$16.00	\$1.60	\$17.60
Timpani mallets	Vic Firth VFT1	1	\$28.00	\$28.00	\$2.80	\$30.80
Timpani mallets	Vic Firth VFT4	1	\$28.00	\$28.00	\$2.80	\$30.80
Bell/Xylo mallets	Musser M4-Rubber, 1" medium, Gray	2	\$20.00	\$40.00	\$4.00	\$44.00
Bell/Xylo mallets	Musser M2 - Rubber, 1" medium, Red	1	\$20.00	\$20.00	\$2.00	\$22.00
Yarn mallets	Balter Pro Vibe Series Black Birch 23BB Medium Blue Cord	3	\$25.50	\$76.50	\$7.65	\$84.15
Bass Drum mallets	Ludwig LUL308	2	\$50.00	\$100.00	\$10.00	\$110.00
French Horn	Holton, model H179	3	\$3,450.00	\$10,350.00	\$1,035.00	\$11,385.00
Tenor Sax	student model Yamaha-YTS23	2	\$1,185.00	\$2,370.00	\$237.00	\$2,607.00
Bass Clarinet	Yamaha, with Garrett mouthpiece-YCL221II	3	\$1,860.00	\$5,580.00	\$558.00	\$6,138.00
Bassoon	Fox Model 41, add high D key and right hand whisper key lock.	2	\$4,490.00	\$8,980.00	\$898.00	\$9,878.00
Alto Saxophone	Keilwerth ST-90	1	\$2,829.00	\$2,829.00	\$282.90	\$3,111.90
Saxophone (and case)	Yamaha, YEP 201	3	\$3,482.00	\$10,446.00	\$1,044.60	\$11,490.60
Tuba (and case)	Yamaha, YBB 105	2	\$7,526.00	\$15,052.00	\$1,505.20	\$16,557.20
<b>Band Instrument Total</b>						<b>\$78,381.01</b>

# Winnquah School Band Equipment Needed for 4K-8 Configuration

Item		No.	Indiv. Cost	Mult. Cost	Plus 10%	Total
Wenger Student Chair - Black (Must be tallest size available!)		25	\$80.00	\$2,000.00	\$200.00	\$2,200.00
Chair Racks	Wenger Chair Move and Store Cart	2	\$310.00	\$620.00	\$62.00	\$682.00
Stands	Wenger Classic 50 music stand	20	\$49.00	\$980.00	\$98.00	\$1,078.00
Stand Racks	Wenger Stand Move and Store Carts	2	\$405.00	\$810.00	\$81.00	\$891.00
Director's Stand	Wenger Director's stand	1	\$359.00	\$359.00	\$35.90	\$394.90
Director's Chair	Wenger Director's chair	1	\$576.00	\$576.00	\$57.60	\$633.60
Folder Rack	75-slot Wenger mobile folio cabinet	1	\$930.00	\$930.00	\$93.00	\$1,023.00
Music Storage	Wenger Music Library System	2	\$1,565.00	\$3,130.00	\$313.00	\$3,443.00
Instrument Storage	Additional Shelving and Storage			\$0.00	\$0.00	\$0.00
Band Music Library	Band music - standard literature for 6-8	250	\$75.00	\$18,750.00	\$1,875.00	\$20,625.00
Solo/Ensemble Music	Solo/Ensemble music from WSMA music list	150	\$20.00	\$3,000.00	\$300.00	\$3,300.00
Digital recording device	Tascam DR-1	1	\$399.00	\$399.00	\$39.90	\$438.90
Sound System	Same as in GDS band room	1		\$0.00	\$0.00	\$0.00
Overhead projector for computer	Same as in GDS band room	1		\$0.00	\$0.00	\$0.00
Screen	Same as in GDS band room	1		\$0.00	\$0.00	\$0.00
<b>Band Equipment Total</b>						<b>\$34,709.40</b>

<b>Band Instrument Total from previous page</b>						<b>\$78,381.01</b>
---	--	--	--	--	--	--------------------

<b>Band Equipment &amp; Music Total</b>						<b>\$113,090.41</b>
---	--	--	--	--	--	---------------------

Need to use Rm. 69 for GIGs and soundproof better between Rm. 69 and the choir room.

## ***Choir Costs for 4K-8 Configuration***

<b>Classroom Furniture</b>	<b>Cost</b>	<b>Cost + 10%</b>
Teacher Desk	\$290.40	\$319.44
Teacher Chair	\$200.27	\$220.30
Filing Cabinets (2 @ \$135.65 each)	\$271.30	\$298.43
Shelving Unit	\$111.85	\$123.04
Classroom Chairs (Wenger) (40 @ \$80/ chair)	\$3,200	\$3,520.00
<b>Totals</b>		<b>\$4,481</b>

<b>Additional Costs</b>	<b>Current Costing</b>	<b>Costing + 10%</b>
Choral Music*	\$ 800.00	\$ 880.00
Classroom Texts	\$ 550.00	\$ 605.00
<b>Totals</b>	<b>\$1,350</b>	<b>\$1,485</b>

\*The vendor for the music would most likely be JW Pepper. It is hard to give an exact breakdown because the prices vary. One piece of music might be \$1.60 per copy while another may be as much as \$4.95...and all price points in between.

The dollar amount came from figuring that we would not replicate the existing library...we would simply have to supplement and/or buy more copies of new songs (i.e. If we chose to sing "Do You Hear What I Hear" and we already owned 25 copies, we would have to buy about 15-25 more to cover the kids at Winnequah). If we were doing a completely new song, we would buy 45-50 instead of the normal 25-30.

***Choir Projected Cost Increase: \$5,966***

# **Orchestra Cost Rationale for a 4K-8 Configuration**

**Submitted by Carl Davick in consultation with Maureen McCarty**

## **Instrument Rationale**

It would not be as simple as just taking half of the instruments from GDS and putting them at Winnequah. This year alone, there are 5 Glacial Drumlin 7<sup>th</sup> grade cello players from Monona that need to play on full size cellos. We currently have 7. If we took half, that wouldn't meet the needs of either building. This is the case for all the instruments.

## **Music Library Rationale**

Each school orchestra program would need to have its own music library. It simply does not work to "share." The instructors need the library at their disposal to look through, study, and select the appropriate pieces for their students and their changing needs and abilities. This would not be possible if there were only one library. There would not be time to access the library if you had to drive to the other building.

Each piece costs out at about \$50. In addition, I have included pricing for outfitting the library with Solo/Ensemble materials as well as miscellaneous method and technique books that we use to supplement or enhance individual student instruction.

## **Equipment Rationale**

1. The orchestra would need to have its own bass amplifier for a potential Sizzling Strings orchestra.
2. Like the orchestra room has at GDS, the Winnequah orchestra room would need the projector system allowing students to be able to watch different orchestra video clips, projected lesson plans, Smart Music music software, etc.
3. The room would need a screen for the projection system.
4. The orchestra room would need bigger chairs than are currently in the Winnequah orchestra room. The current chairs are too small for 7<sup>th</sup> and 8<sup>th</sup> graders. They were part of the Nichols remodel from the early 90's and are best suited for 3<sup>rd</sup>, 4<sup>th</sup>, and 5<sup>th</sup> graders.
5. It would be necessary to have a music performance shell like the one used at GD for music performances in the gymnasium.

## Winnequah Orchestra Equipment Needed for 4K-8 Configuration

FF&E Item		Qty	Indiv.Cos	Mult. Cost	Plus 10%	Total
Chairs	Wenger Student Chair - Black (Must be tallest size available!)	25	\$80.00	\$2,000.00	\$200.00	\$2,200.00
Director's Stand	Wenger Director's stand	1	\$359.00	\$359.00	\$35.90	\$394.90
Director's Chair	Wenger Director's chair	1	\$576.00	\$576.00	\$57.60	\$633.60
Folder Rack	75-slot Wenger mobile folio cabinet	1	\$930.00	\$930.00	\$93.00	\$1,023.00
Music Storage	Wenger Music Library System	3	\$1,325.00	\$3,975.00	\$397.50	\$4,372.50
Instrument Storage	Would be able to use existing storage in strings room					
Orchestra Music Library	Orchestra Music - standard literature for 6-8	400	\$50.00	\$20,000.00	\$2,000.00	\$22,000.00
Digital recording device	Tascam DR-1	1	\$399.00	\$399.00	\$39.90	\$438.90
Sound System	Yamaha components	1	\$500.00	\$500.00	\$50.00	\$550.00
Overhead projector for computer	Epson 410W	1	\$1,000.00	\$1,000.00	\$100.00	\$1,100.00
Screen		1	\$100.00	\$100.00	\$10.00	\$110.00
<b>Equipment &amp; Music Total</b>						<b>\$32,822.90</b>

## Winnequah Orchestra Instruments Needed for 4K-8 Configuration

Item	Vendor	Qty	Indiv.Cos	Mult. Cost	Plus 10%	Total
1/2 size cellos	Eastman	2	\$700.00	\$1,400.00	\$140.00	\$1,540.00
3/4 size cellos	Eastman	2	\$700.00	\$1,400.00	\$140.00	\$1,540.00
4/4 size cellos	Eastman	6	\$800.00	\$4,800.00	\$480.00	\$5,280.00
1/4 size bass	Eastman	1	\$1,500.00	\$1,500.00	\$150.00	\$1,650.00
1/2 size bass	Eastman	2	\$1,500.00	\$3,000.00	\$300.00	\$3,300.00
3/4 size bass	Eastman	1	\$2,000.00	\$2,000.00	\$200.00	\$2,200.00
Bass Amp	Gaelen Kruger	1	\$700.00	\$700.00	\$70.00	\$770.00
<b>Instrument Total</b>						<b>\$16,280.00</b>
<b>Equipment Total</b>						<b>\$32,822.90</b>
<b>Orchestra Total</b>						<b>\$49,102.90</b>

### Winnequah School Music Dept. Shared Equipment Needed

Item		Qty	Indiv.Cos	Mult. Cost	Plus 10%	Total
Accoustical Shell	Wenger Music	5	\$2,000.00	\$10,000.00	\$1,000.00	\$11,000.00

**MONONA GROVE SCHOOL DISTRICT**  
**DECEMBER 22, 2009**

# **4K-8 Grade Configuration Study**

---

## **Projected Additional PE & Health Expenses**

<b>Physical Education Equipment Cost Estimate for Grades 7 &amp; 8</b>	<b>\$ 40,015</b>
<b>Health Cost Estimate for Grades 7 &amp; 8 at Winnequah</b>	<b>\$ <u>2,501</u></b>
	<b>\$ 42,516</b>

**Rationale for Additional PE Storage at Winnequah under a 4K-8 Grade Configuration is included.**



## ***PE Equipment & Health Costs for 4K-8 Configuration***

Cost Projections Prepared by Kevin Mikelbank in Consultation with Rick Sonn & Jeff Albers

Item	Description	Quantity	Catalog #	Unit price	Total
Weighted bars	3#	8	Gm68640	\$27	\$216
	6#	7	Gm68641	\$31	\$217
	9#	6	Gm68642	\$35	\$210
	12#	7	Gm68643	\$39	\$273
	15#	2	Gm68644	\$43	\$86
	18#	1	Gm64645	\$51	\$51
Weight rack			Gm68670	\$249	\$249
Football rubber (official size)		12	Gm61556	\$14	\$168
Football rubber intermediate		12	Gm61557	\$13	\$156
Gripper volleyball		13	Gm41865	\$17	\$221
Gripper soccer ball		25	Gm41644	\$15	\$375
Gripper football		15	Gm41641	\$13	\$195
Metal CAGE	Rectangle storage cart	3		\$319	\$957
	Double decker kong	1	Gm89 008	\$669	\$669
Lockmaster tote master bin	Full blue	3	Gm85086	\$200	\$600
		2 Half size	Gm85098	\$140	\$280
Reg soccer ball		15	Gm62105	\$28	\$420
Hockey stick	4 goalie	4	Gm10786	\$26	\$104
	52"	14	Gm10904	\$16	\$224
	47"	14	Gm11075	\$15	\$210
Upright Bin On Wheels For Sticks		1	Gm82758	\$140	\$140
Extra Blades	8	6	Gm10906	\$4	\$24
Eye Protection		30	Gm53-353	\$14	\$420
Puck Things		30	Gm10-184	\$3	\$90
Volleyballs	Regulation sv18L	35	Gm61759	\$42	\$1470
Vb carts		2	Gm46140	\$130	\$260
Volley lites		6	Gm62531	\$32	\$192
Hula Hoops no kink	1 doz Large		Gm43-705	Doz/\$83	\$83
	1 sm		Gm43704	Doz/\$78	\$78
Ultra fit balance boards		15	GM68-348	\$145	\$2175
Medicine balls		4# 12	Gm61-301	\$23	\$276
Medicine balls		6# 6	Gm61-302	\$29	\$174
Medicine balls		8# 5	Gm61-303	\$35	\$175
Med ball racks		1	Gm68-673	\$249	\$249
Industrial plastic rectangular bin		4	Home depot	\$25	\$100

**Equipment      Costs      Continued**

Bosuballs with rack	Class pack w/ storage cart	14	Gm01049	\$1800	\$1080
Resistance tubing		Class pack	Gm01438	\$580	\$580
Smart Cart		1	Gm68-103	\$1649	\$1649
Ladders		4	Gm69217	\$100	\$400
Tennis Balls		5 Tubes	Gm51120	\$3.50	\$17.50
100 foot Yellow Ropes		5	walmart	\$20	\$20
Kickballs	SIZE 10.	6	Gm71325	\$44	\$44
	SIZE 8.5	6	Gm71322	\$52	\$52
Exercise Mats with Cart	30 MATS 1 CART		Gm68193	\$929	\$929
Swim Boards		15	Gm86272	\$16	\$240
Ultimate Frisbees		30	Gm10395	\$10	\$300
Golf Wiffelballs	15 Dozen		Gm11-519	\$5/doz	\$75
Big Round Scooters		6	Gm82010	\$300	\$300
Bocce Balls outdoors		7	Walmart	\$30/set	\$210
Bocce set indoors		1	Gm01025	\$85	\$85
Black & White Eclipse Balls		12	online	\$91	\$91
Foam Tennis Trainer		25	Gm41718	3/\$12	\$96
Softball Whiffle Balls		3 DOZ	Gm41649	\$1.35	\$48.60
Baseball Whiffle Balls		3 DOZ	Gm41629	\$1.05	\$37.80
Whiffle Ball Bats Plastic Cosom		15	Gm48152	\$8	\$120
Soft Balls	Yellow Smaller Incrediball 11"	10	Gm41875	\$5.25	\$52.50
	Regulation Incrediball	10	Gm41873	\$5.50	\$55
	Real Jr. Size 11"	10	Gm41385	\$7	\$70
	Real Size	10	Gm41387	\$6	\$60
White Bases Sets		3	Gm46358	\$28 set	\$84
White Home Plate		3	Gm46175	\$11	\$33
AB Wheels		15	GM68327	\$11	\$165
Mesh Bags	XL	6	Gm14556	Set/\$109	\$109
	Large	6	Gm14540	Set/\$70	\$70
Canvas Bags		3	GM14502	\$23	\$69
Track Battons		30	Gm38034	\$3.25	\$97.50
Bowing Pins		1 DOZ	Gm10-783	\$55	\$55
Physio balls	39 total 55 mm	1	Gm72-300	6/\$179	\$179
	65mm	3	Gm72-301	6/\$195	\$585
	75mm	3	Gm71-022	6/\$209	\$624

**Equipment      Costs      Continued**

Psyio Racks		3	Gm68994	\$239	\$717
Badminton Rackets		30	Gm53425	\$14	\$420
Badminton Nets		6	Gm56503	\$30	\$180
Birdies	36 Total	6	Gm53478	\$11	\$66
Red & Yellow sets Flag Belts		2 sets of 12 R&Y	Gm01653	\$105/set	\$210
Red Flag Belts XL		Set of 12	Gm63881	\$54/set	\$54
Yellow Flag Belts XL			Gm63880	\$54/set	\$54
Pinnies		30	29266		\$135
Portable Jump Rope Rack			Gm82305	\$119	\$119
Jump ropes	Red	4	Gm10090	6/\$15	\$60
Jump ropes	Yellow	4	Gm10091	6/\$16	\$64
Jump ropes	Blue	4	Gm10092	6/\$24	\$94
Omnikins			Gm47015	6/\$300	\$300
# polly spots	Large set (60)		Gm93306	\$170	\$170
Mega phone			Gm25602	\$140	\$140
Dodge balls small	6.3 size	5	Gm41590	6/\$70	\$350
Dodge balls large	8.25	5	Gm41550	6/\$125	\$625
Baseball gloves righty		30	Gm42325	\$28	\$840
Baseball gloves lefty		5	Gm42326	\$28	\$140
3vc Storage Cart with baskets			Gm89011	\$249	\$249
Plastic Pickleball Paddles		5	Gm53397	6/\$50	\$250
Bat Softball	2 larger		Gm42055	\$35	\$70
	2 smaller		Gm42093	\$28	\$56
Pickle Ball Storage Rack					\$25
Volleyball Nets for Pickleball			Gm66703	\$43	\$72
15 Bike Helmets			Walmart price	\$24	\$360
Stereosystem per gym					
Urban Rebounders & Cart	12 with cart		Gm68-164	\$2250	\$2250
Badminton Nets			Gm56503	\$30	\$180
3 Large Garbage Cans (for storage)					\$162
Cones	18 inch	20	Gm85835	\$11	\$220
	12 inch	24	Gm 85-833	\$8.25	\$198
	36 inch	5	Gm85834	5/\$160	\$160
Dome cones Rack	Set of 36		Gm85959	\$30	\$30
			Gm82-730	\$7	\$7
tilts		4 pair	Gm17712	\$90	\$360
5 Gallon Pail		3	Home depot	\$4	\$12
1 Measuring Wheel			Gm38351	\$179	\$179

**Equipment      Costs      Continued**

Men's Leather Basketballs	LEATHER	30	GM62-861	\$23.95	\$720
Women's Leather Basketballs	LEATHER	30	GM62-862	\$23.95	\$720
Pump To Handle Bikes			Gm73691	\$270	\$270
			<b>TOTAL</b>		<b>\$31,758</b>
				<b>S&amp;H 16%</b>	<b>\$ 5,081</b>
				<b>Plus 10%</b>	<b>\$ 3,176</b>
				<b>TOTAL</b>	<b>\$40,015</b>

**The PE department will also need a TV cart, TV, VCR player, DVD player and a 300 WATT or more stereo. We did not include these prices as this equipment may be available in the AV department at Winnequah.**

**Note:**

1. 98% of the items listed are quoted from Gopher Sports. Only a few prices are quoted from Home Depot (much better price on rubber storage barrels and 5 gallon buckets) or another on-line service (eclipse ball) for some equipment. The item costs listed are the current prices. 10% was added after the 16% shipping and handling.
2. PEP Grant funds have been allocated to specific district buildings based upon the structure of the grant application in 2008-2009.

GOPHER SPORTS  
2525 Lemond Street SW  
PO Box #998  
Owatonna, MN 55060-0998

***Winnequah Seventh-Grade Health and Wellness Instruction***

**Projected Costs:**

4 HGD videos from Marshfield Video (\$320.00)

35 student texts – classroom set (\$2,100.00). "Teen Health Course 3" from Glencoe.com

1 Teacher Wrap Around Edition (\$81.00) for above student text.

***Cost to replicate student and teacher materials: \$2,501***

**WINNEQUAH STORAGE SPACE ISSUE:** Adding equipment is a major concern. Almost all equipment currently at Winnequah is not the correct size for appropriate utilization and instruction for 7<sup>th</sup> and 8<sup>th</sup> graders. The current storage room at Winnequah is already full and basically at capacity.

Having an appropriately sized storage room involves construction and expansion. Keeping in mind that it needs to be accessible to the gym, the best situation (that we could come up with) would be to add a storage room along the wall that is alongside the recess area. The room could come out from the cafeteria wall and gym and go onto the area that is the service driveway. The current fence would be removed up to the point of the door that exits from the wood gym on that side, which is about half way down. The storage room would potentially have three sections. One would be accessible only from the outside. This would store things that we only use outside such as hurdles for track. Someday I believe there will be a HJ matt issue again as well. The second section would be PE storage. This would have access to the main gym via a slightly recessed "metal drop gate" similar to ones used on store fronts in a city location. Perhaps a garage door style that goes up and down would be best. The area of this door would be no closer to the tile gym than the bleachers of the wood gym and be large enough to go over towards the locker rooms but stop shy of the basketball wall pads under the basket. Outside, the perception may be that the new storage area would take up the current service driveway. In fact, it would be shortened. One option is to switch the location of the door that the driveway uses to enter the kitchen area over to the left as you look at the building. Another is to run a "separate hallway" along the back of the equipment room to gain access.

A second idea which we doubt would have enough space to facilitate the current equipment needs for equitable programming would be to shorten the locker room hallway up to the girl's entrance. A door would then have to be popped into the gym wall so the girls could walk "straight out" to the gym and enter it by the side basket. By doing such, the remainder of the hallway, as well as the "girl's PE office" could become a PE storage area. Ideally, the entrance in the middle of the gym would be included in storage, too, as the PE office would have to be expanded simply to accommodate a second teacher's desk in the office where Jeff is located. All students would enter the locker room from the gym, similar to the set up at GDS.

Finally, a concern that has not been corrected yet involves the tile gym doors that provide access to the wood gym. A standard PE cart does not fit through these doors. They should both be widened slightly and can be without affecting the bleachers. This would eliminate having to take a cart outside and then back in through the two doors that are close on the lower parking lot side.

***Estimated Cost for 70' X 15' Storage Room = \$50,000***

**MONONA GROVE SCHOOL DISTRICT**  
**DECEMBER 22, 2009**

# **4K-8 Grade Configuration Study**

---

## **Student Services**

**Impact on Special Education and Student Services Staffing**

**None**

# Department of Student Services

---

**December 4, 2009**

**To:** Patti McGinnis

**From:** John H Faust

**Re:** Grade Configuration Study – Impact on Special Education Staffing and Student Services Staffing

---

In projecting special education enrollments for the 2011-2012 school year and analyzing the data in terms of special education staffing required in the proposed grade configuration, there is no indication that additional special education staffing is required based on the data available at this time.

It is difficult to accurately predict special education enrollments two years hence, so one must be cognizant that special education enrollments could change dramatically under given circumstances. These circumstances include, but are not limited to change in state special education and/or licensing rules, open enrollment increases and/or decreases, and/or a change in district philosophy on prevention/early intervention.

Assumptions made in projecting enrollments and analyzing the data included that students eligible to graduate will graduate on time and that projections for Early Childhood: Special Education enrollment remain static over the course of the next two years.

Given the analysis of this data; however, I am confident that additional special education professional staff are not needed to adequately staff the proposed grade configuration proposal under consideration at this time.

We currently have 12.8 FTE student services personnel and I do not see that FTE changing in the proposed configuration. There may be shifts in personnel, but the overall FTE would remain the same.

**MONONA GROVE SCHOOL DISTRICT**  
**DECEMBER 22, 2009**

# **4K-8 Grade Configuration Study**

---

## **Winnequah Interscholastic Athletics Projected Costs**

<b>Coaching Additives</b>	<b>\$ 20,119</b>
<b>Intramural Coordinator Additives</b>	<b>\$ 5,192</b>
<b>Athletic Director Additive</b>	<b>\$ 2,921</b>
<b>Home Game Management Costs</b>	<b>\$ <u>6,204</u></b>
	<b>\$ 34,436</b>
 <b>Estimated Transportation Costs</b>	 <b>\$ 7,311</b>
 <b>Athletics Equipment Estimated Costs</b>	 <b>\$ 11,459</b>
 <b>Total Projected Costs for Winnequah Interscholastic Athletics</b>	 <b>\$ 53,205</b>

**Note: Ten Percent has been added to estimated costs.**



**Monona Grove School District**

**Middle School Athletics**

**Comprehensive Report**

**Prepared by Dan Zweifel**

# **Monona Grove Middle School Athletics**

## **Table of Contents**

- 1. Sports Offered**
  - a. Glacial Drumlin**
- 2. Intramurals**
  - a. Glacial Drumlin**
- 3. Athletic Additive Pay**
  - a. Glacial Drumlin**
  - b. Proposed Winnequah**
- 4. Game Management**
  - a. Glacial Drumlin**
  - b. Proposed Winnequah**
- 5. Transportation**
  - a. Transportation Costs from GDS + Winnequah 2007-2009**
- 6. Equipment**
  - a. Equipment Needs for Winnequah**

# Glacial Drumlin Athletics

- **SPORTS OFFERED AT GLACIAL DRUMLIN**

- **Fall**

- **Girls Volleyball**
      - Girl's 7<sup>th</sup> & 8<sup>th</sup> grade
        - September - October
    - **Boy's and Girl's Cross Country**
      - Boy's & Girl's 7<sup>th</sup> & 8<sup>th</sup> Grade
        - September - October

- **Winter**

- **Boys Basketball**
      - Boy's 7<sup>th</sup> & 8<sup>th</sup> grade
        - October - December
    - **Girls Basketball**
      - Girl's 7<sup>th</sup> & 8<sup>th</sup> Grade
        - January - February

- **Spring**

- **Track & Field**
      - Boys & Girls 7<sup>th</sup> & 8<sup>th</sup> Grade
        - April-May

# • INTRAMURALS

## ○ Sports Offered

- Girl's Basketball
  - January - February
- Boy's Basketball
  - March
- Girl's Basketball
  - November; February

## ○ Participants

- 6<sup>th</sup> Grade Boy's & Girl's from Winnequah & Glacial Drumlin

## ○ Transportation

- Kids bussed from Winnequah to Glacial Drumlin
- Transportation provided by Lazer Bus Company
- Transportation cost covered by MGSD

## ○ Intramural Coordinators

- Girl's Volleyball
  - (2) Positions
  - .02 Contract = \$ 590 per coordinator
  - Total = \$ 1,180
- Boy's Basketball
  - (2) Positions
    - Coordinator
    - Asst. Coordinator
  - Coordinator
    - .04 Contract = \$ 1,180
  - Assistant Coordinator
    - .02 Contract = \$590
  - Total = \$1,770
- Girl's Basketball
  - (2) Positions
    - Coordinator
    - Asst. Coordinator
  - Coordinator
    - .04 Contract = \$ 1,180
  - Assistant Coordinator
    - .02 Contract = \$590
  - Total = \$1,770

# Glacial Drumlin Athletics

## Additive Salaries

### Interscholastic Athletics

Sport	Number of Coaches	Additive	Amount	Total
Boy's & Girl's Cross Country	2	.06	\$1,770.00	\$3,540.00
Girl's Volleyball Two "A" Coaches	2	.06	\$1,770.00	\$3,540.00
Girl's Volleyball Two "B" Coaches	2	.06	\$1,770.00	\$3,540.00
Boy's Basketball Two (2) "A" Coaches	2	.08	\$2,360.00	\$4,720.00
Boy's Basketball Two (2) "B" Coaches	2	.06	\$1,770.00	\$3,540.00
Girl's Basketball Two (2) "A" Coaches	2	.08	\$2,360.00	\$4,720.00
Girl's Basketball Two (2) "B" Coaches	2	.06	\$1,770.00	\$3,540.00
Boy's Track n Field	2	.06	\$1,770.00	\$3,540.00
Girl's Track n Field	2	.06	\$1,770.00	\$3,540.00
<b>Total Cost (Coaching Salaries)</b>				<b>\$ 34,220.00</b>

### Intramurals

Girl's Volleyball Coordinator	1	.02	\$590.00	\$590.00
Girl's Volleyball Assistant Coordinator	1	.02	\$590.00	\$590.00
Boy's Basketball Coordinator	1	.04	\$1,180.00	\$1,180.00
Boy's Basketball Assistant Coordinator	1	.02	\$590.00	\$590.00
Girl's Basketball Coordinator	1	.04	\$1,180.00	\$1,180.00
Girls' Basketball Assistant Coordinator	1	.02	\$590.00	\$1,180.00
<b>Total Cost (Intramural Additives)</b>				<b>\$ 4,720.00</b>

### Athletic Director

Athletic Director	1	.09	\$2,655.00	
-------------------	---	-----	------------	--

<b>Glacial Drumlin</b> <b>Total Cost for Combined Additive Salaries</b>	
<b>Total Interscholastic Salaries</b> <b>(Coaching Additives)</b>	<b>\$ 34,220.00</b>
<b>Total Intramural Salaries</b> <b>(Intramural Additives)</b>	<b>\$ 4,720.00</b>
<b>Total Athletic Director Salary</b> <b>(Athletic Director Additive)</b>	<b>\$ 2,655.00</b>
<b>Total Cost</b>  <b>Coaching Additives</b> <b>Intramural Additives</b> <b>Athletic Director Additive</b>	<b>\$ 41,595.00</b>

# Projected Cost for Winnequah Athletics (If Same)

## Interscholastic Athletics

Sport	Number of Coaches	Additive	Amount	Total
Boy's & Girl's Cross Country	2	.06	\$1,770.00	\$3,540.00
Girl's Volleyball Two "A" Coaches	2	.06	\$1,770.00	\$3,540.00
Girl's Volleyball Two "B" Coaches	2	.06	\$1,770.00	\$3,540.00
Boy's Basketball Two (2) "A" Coaches	2	.08	\$2,360.00	\$4,720.00
Boy's Basketball Two (2) "B" Coaches	2	.06	\$1,770.00	\$3,540.00
Girl's Basketball Two (2) "A" Coaches	2	.08	\$2,360.00	\$4,720.00
Girl's Basketball Two (2) "B" Coaches	2	.06	\$1,770.00	\$3,540.00
Boy's Track n Field	2	.06	\$1,770.00	\$3,540.00
Girl's Track n Field	2	.06	\$1,770.00	\$3,540.00
<b>Total Cost (Coaching Salaries)</b>				<b>\$ 34,220.00</b>

## Intramurals

Girl's Volleyball Coordinator	1	.02	\$590.00	\$590.00
Girl's Volleyball Assistant Coordinator	1	.02	\$590.00	\$590.00
Boy's Basketball Coordinator	1	.04	\$1,180.00	\$1,180.00
Boy's Basketball Assistant Coordinator	1	.02	\$590.00	\$590.00
Girl's Basketball Coordinator	1	.04	\$1,180.00	\$1,180.00
Girls' Basketball Assistant Coordinator	1	.02	\$590.00	\$590.00
<b>Total Cost (Intramural Additives)</b>				<b>\$ 4,720.00</b>

## Athletic Director

Athletic Director	1	.09	\$2,655.00	
-------------------	---	-----	------------	--

# Projected Cost for Winnequah Athletics (For Winnequah Numbers)

## Interscholastic Athletics

Sport	Number of Coaches	Additive	Amount	Total
Boy's & Girl's Cross Country	1	.06	\$1,770.00	\$1,770.00
Girl's Volleyball Two (2) Coaches (1) 7 <sup>th</sup> Grade (1) 8 <sup>th</sup> Grade	2	.06	\$1,770.00	\$3,540.00
Boy's Basketball Two (2) Coaches (1) 7 <sup>th</sup> Grade (1) 8 <sup>th</sup> Grade	2	.08	\$2,360.00	\$4,720.00
Girl's Basketball Two (2) Coaches (1) 7 <sup>th</sup> Grade (1) 8 <sup>th</sup> Grade	2	.08	\$2,360.00	\$4,720.00
Boy's Track n Field	1	.06	\$1,770.00	\$1,770.00
Girl's Track n Field	1	.06	\$1,770.00	\$1,770.00

Total Cost  
Coaching Salaries

\$ 18,290.00

## Intramurals

Girl's Volleyball Coordinator	1	.02	\$590.00	\$590.00
Girl's Volleyball Assistant Coordinator	1	.02	\$590.00	\$590.00
Boy's Basketball Coordinator	1	.04	\$1,180.00	\$1,180.00
Boy's Basketball Assistant Coordinator	1	.02	\$590.00	\$590.00
Girl's Basketball Coordinator	1	.04	\$1,180.00	\$1,180.00
Girls' Basketball Assistant Coordinator	1	.02	\$590.00	\$590.00

Total Cost  
Intramural Salaries

\$ 4,720.00

## Athletic Director

Athletic Director	1	.09	\$2,655.00	
-------------------	---	-----	------------	--



<b>Total Cost for Combined Additive Salaries Based on Winnequah Numbers</b>	
<b>Total Interscholastic Salaries (Coaching Additives)</b>	<b>\$ 18,290.00</b>
<b>Total Intramural Salaries (Intramural Additives)</b>	<b>\$ 4,720.00</b>
<b>Total Athletic Director Salary (Athletic Director Additive)</b>	<b>\$ 2,655.00</b>
<b>Total Cost</b>  Coaching Additives Intramural Additives Athletic Director Additive	<b>\$ 25,665.00</b>

<b>Total Cost for Combined Additive Salaries Based on Being Equal to Glacial Drumlin</b>	
<b>Total Interscholastic Salaries (Coaching Additives)</b>	<b>\$ 34,220.00</b>
<b>Total Intramural Salaries (Intramural Additives)</b>	<b>\$ 4,720.00</b>
<b>Total Athletic Director Salary (Athletic Director Additive)</b>	<b>\$ 2,655.00</b>
<b>Total Cost</b>  Coaching Additives Intramural Additives Athletic Director Additive	<b>\$ 41,595.00</b>

# Glacial Drumlin Athletics 2009-2010

## Home Game Management Cost

Home Game	Referees	Scoreboard	Scorebook	Supervision	Total Per Home Match
	(2) @ \$ 50/each	(2) @ \$ 30.00	(2) @ \$ 30.00	(2) @ \$ 30.00/each	\$ 280.00
Number of Games					Total for Season
6	\$ 600.00	\$ 360.00	\$ 360.00	\$ 360.00	\$ 1,580.00

### Boy's & Girl's Cross Country (No Home Meet Cost)

Home Game	Referees	Scoreboard	Scorebook	Supervision	Total Per Home Match
(2) Game Cost	(4) @ \$50/each	(2) @ \$ 30.00	(2) @ \$ 30.00	(2) @ \$ 30.00/each	\$ 380.00
Number of Games					Total for Season
6	\$ 1,200.00	\$ 360.00	\$ 360.00	\$ 360.00	\$ 2,280.00

Home Game	Referees	Scoreboard	Scorebook	Supervision	Total Per Home Match
(2) Game Cost	(4) @ \$ 50/each	(2) @ \$ 30.00	(2) @ \$ 30.00	(2) @ \$ 30.00/each	\$ 380.00
Number of Games					Total for Season
5	\$ 1,000.00	\$ 300.00	\$ 300.00	\$ 300.00	\$ 1,900.00

Home Meet	Referee	Timers	High Jump	Long Jump	Shot Put	Discus	Total For Home Meet
(1) Home Meet	(1) @ \$ 50	(6) @ \$ 30	(2) @ \$ 30	(1) @ \$ 30	2 @ \$ 30	2 @ \$ 30	\$ 440.00

### Total Cost for Home Game Management

Sport	Home Game Management Cost
Girl's Volleyball	\$ 1,580.00
Cross Country	\$ 0.00
Boy's Basketball	\$ 2,280.00
Girl's Basketball	\$ 1,900.00
Track and Field	\$ 440.00
<b>Total Cost for Home Game Management</b>	<b>\$ 6,200.00</b>

**Winnequah Middle School Athletics**  
**Projected Cost For**  
**Home Game Management**

GIRLS VOLLEYBALL					
Home Game	Referees	Scoreboard	Scorebook	Supervision	Total Per Home Match
	(2) @ \$ 50/each	(2) @ \$ 30.00	(2) @ \$ 30.00	(2) @ \$ 30.00/each	\$ 280.00
Number of Games					Total for Season
5	\$ 500.00	\$ 300.00	\$ 300.00	\$ 300.00	\$ 1,400.00

**Boy's & Girl's Cross Country (No Home Meet Cost)**

BOYS BASKETBALL					
Home Game	Referees	Scoreboard	Scorebook	Supervision	Total Per Home Match
(1) Game Cost	(4) @ \$50/each	(2) @ \$ 30.00	(2) @ \$ 30.00	(2) @ \$ 30.00/each	\$ 380.00
Number of Games					Total for Season
5	\$ 1,000.00	\$ 300.00	\$ 300.00	\$ 300.00	\$ 1,900.00

GIRLS BASKETBALL					
Home Game	Referees	Scoreboard	Scorebook	Supervision	Total Per Home Match
(1) Game Cost	(4) @ \$ 50/each	(2) @ \$ 30.00	(2) @ \$ 30.00	(2) @ \$ 30.00/each	\$ 380.00
Number of Games					Total for Season
5	\$ 500.00	\$ 300.00	\$ 300.00	\$ 300.00	\$ 1,900.00

TRACK & FIELD							
Home Meet	Referee	Timers	High Jump	Long Jump	Shot Put	Discus	Total For Home Meet
(1) Home Meet	(1) @ \$ 50	(6) @ \$ 30	(2) @ \$ 30	(1) @ \$ 30	2 @ \$ 30	2 @ \$ 30	\$ 440.00

Total Cost for Home Game Management	
Sport	Home Game Management Cost
Girl's Volleyball	\$ 1,400.00
Cross Country	\$ 0.00
Boy's Basketball	\$ 1,900.00
Girl's Basketball	\$ 1,900.00
Track and Field	\$ 440.00
<b>Total Cost for Home Game Management</b>	<b>\$ 5,640.00</b>

# Glacial Drumlin / Winnequah Athletics

## Transportation Costs for 2007-2009

\*\*\* Note \*\*\* 2007-2008 School Year @ Winnequah \*\*\*

Girl's Volleyball							
2009 Season	@ Wis. Hts	@ Monroe	@ Mt. Horeb	@ Badger Ridge	@ Stoughton		Total Cost
Bus Cost	\$235.00	\$285.00	\$235.00	\$225.00	\$215.00		\$ 1,195.00
2008 Season	@ McFarland	@ Oregon	@ Stoughton	@ McFarland	@ Verona	@ Beaver Dam	Total Cost
Bus Cost	\$225.00	\$215.00	\$225.00	\$215.00	\$225.00	\$275.00	\$1,380.00
2007 Season (Winnequah)	@ Badger Ridge	@ Wis. Hts	@ Mt. Horeb	@ Monroe	@ Sav. Oaks		
Bus Cost	\$230.00	\$265.00	\$235.00	\$315.00	\$235.00		\$ 1,280.00

Boy's & Girl's Cross Country						
2009 Season	@ Sun Prairie	@ Mt. Horeb	@ Stoughton	@ Lodi	@ Cross Plains	Total Cost
Bus Cost	\$215.00	\$215.00	\$215.00	\$215.00	\$205.00	\$ 1,065.00
2008 Season	@ Sun Prairie	@ Mt. Horeb	@ Stoughton	@ Verona	@ Monroe	Total Cost
Bus Cost	\$225.00	\$235.00	\$205.00	\$215.00	Cancelled	\$ 880.00
2007 Season (Winnequah)	@ Sun Prairie	@ DeForest	@ Stoughton	@ Monroe	@ Lodi	
Bus Cost	\$225.00	\$225.00	\$210.00	\$300.00	\$250.00	\$ 1,210.00

Boy's Basketball							
2009 Season	@ Sav. Oaks	@ Monroe	@ Sun Prairie	@ Wis. Hts	@ Oregon	@ Ore/Def	Total Cost
Bus Cost							TBA
2008 Season	@ McFarland	@ Stoughton	@ DeForest	@ Mt. Horeb	@ Stoughton		Total Cost
Bus Cost	\$220.00	\$205.00	\$255.00	\$250.00	\$215.00		\$ 1,145.00
2007 Season (Winnequah)	@ Wis Hts.	@ Monroe	@ Oregon	Game Cancelled			
Bus Cost	\$260.00	\$315.00	\$210.00	Show			\$ 785.00

### Girl's Basketball

2010 Season	@ Mt. Horeb	@ Badger Ridge	@ Oregon	@ Sav. Oaks	@ Stoughton	@ DeForest	Total Cost
Bus Cost							
2009 Season	@ Wis. Hts	@ Badger Ridge	@ Mt. Horeb	@ Sav. Oaks	@ Monroe	@ DeForest	Total Cost
Bus Cost	\$ 247.50	\$ 225.00	\$ 220.00	\$ 215.00	\$ 285.00	\$285.00	\$1,477.50
2008 Season (Winnequah)	@ Kromrey	@ Monroe	@ Sav. Oaks	@ Oregon	@ DeForest		Total Cost
Bus Cost	\$ 200.00	\$ 310.00	\$ 205.00	\$ 195.00	\$ 205.00		\$ 1,115.00

### Boy's & Girl's Track and Field

2010 Season						Total Cost
Bus Cost						
2009 Season	@ Sun Prairie	@ McFarland	@ Mt. Horeb	@ McFarland	@ Beaver Dam	Total Cost
Bus Cost		\$380.00		\$380.00	\$395.00	\$1,763.00
2008 Season (Winnequah)	McFarland	Oregon	DeForest	2 Meets Rained Out		Total Cost
Bus Cost	\$375.00	\$ 400.00	\$ 410.00			\$1,185.00

### Total Transportation Costs @ Glacial Drumlin / Winnequah 2007-2009

Season	Girl's Volleyball	Boy's & Girl's Cross Country	Boy's Basketball	Girl's Basketball	Boy's & Girl's Track & Field	Total Bus Cost Each Year
2009-2010 (GDS)	\$ 1,195.00	\$ 1,065.00	TBA	TBA	TBA	\$ 2,260 + TBA
2008-2009 (GDS)	\$1,380.00	\$880.00	\$ 1,145.00	\$1,477.50	\$1,763.00	\$ 6,645.50
2007-2008 (Winnequah)	\$ 1,280.00	\$ 1,210.00	\$ 785.00 * There was a game Cancelled	\$ 1,115.00	\$1,850.00	\$ 6,240.00

# Winnequah Athletics Equipment Needs

## Girls Volleyball

Equipment Name	Company	Item	Item Number	Quantity	Cost	Total Cost
Volleyball Standards	Gopher Sports	Jaypro Power Volleyball	84-174	2	\$ 2,195.00	\$ 4,390.00
Volleyball System Carrier	Gopher Sports	Jaypro Power Volleyball System Carrier	84-576	1	\$ 319.00	\$ 319.00
Volleyball Storage Cart	Realvolleyball.com	Mikasa Volleyball Storage Cart	61-736	2	\$ 114.99	\$229.98
Volleyballs	Realvolleyball.com	Tachikara Volleyballs	SV5WSC	26	\$ 26.99	\$701.74
Volleyballs	Realvolleyball.com	Molten Volleyballs	IV58L-3	4	\$ 38.99	\$ 155.96
Referee Stand	Jaypro	Folding Referee Stand	VRS-6000	2	\$565.00 + \$150 Shipping	\$ 1,280.00
Total Equipment Cost for Volleyball						\$ 7,076.68

## Boys & Girls Cross Country

Cones	Gopher Sports	Orange Vinyl Cones	85-835	12	\$ 10.50	\$ 126.00
Total Equipment Cost for Cross Country						\$ 126.00

## Boys Basketball

Basketballs	Badger Sporting Goods	Spalding TF-1000	LBTF1000WC	24	\$ 36.00	\$ 864.00
Total Equipment Cost for Boys Basketball						\$ 864.00

## Girls Basketball

Basketballs	Badger Sporting Goods	Spalding TF-1000 (28.5)	LBTF1008WC	24	\$ 36.00	\$ 864.00
Total Equipment Cost for Girls Basketball						\$ 864.00

## Boys & Girls Track and Field

Hurdles	First To The Finish	Gill Scholastic Aluminum Hurdle	G411	6	\$ 103.50	\$ 621.00
Starting Blocks	First To The Finish	Gill Scholastic Starting Blocks	G412	6	\$ 109.95	\$ 659.70
Shot Puts	Gopher Sports	Shot Put	38-322	6	\$ 14.95	\$ 89.70
Discus	Gopher Sports	Discus	38-394	6	\$ 13.95	\$ 83.70
Batons	Gopher Sports	Aluminum Batons	38-034	10	\$ 3.25	\$ 32.50
Total Equipment Cost for Track and Field						\$ 1,486.60

**Winnequah Athletics  
New Equipment Cost**

<b>Sport</b>	<b>New Equipment Cost</b>
Girl's Volleyball	\$ 7,076.68
Boy's & Girl's Cross Country	\$ 126.00
Boys Basketball	\$ 864.00
Girl's Basketball	\$ 864.00
Boy's & Girl's Track and Field	\$ 1,486.60
<b>Total New Equipment Cost for Winnequah Athletics</b>	<b>\$ 10,417.28 + Shipping</b>

**Winnequah Middle School  
Projected  
Total Cost for Athletics  
If Same as GDS**

Total Interscholastic Salaries (Coaching Additives)	\$ 34,220.00
Total Intramural Salaries (Intramural Additives)	\$ 4,720.00
Total Athletic Director Salary (Athletic Director Additive)	\$ 2,655.00
Total Cost for Game Management	\$ 6,200.00
Total Estimated Cost for Transportation	\$ 6,645.50
Total Cost for New Equipment Needed for Winnequah	\$ 10,417.28 + Shipping
<b>Total Cost (If Same as GDS)</b>  Coaching Additives Intramural Additives Athletic Director Additive Game Management Transportation New Equipment	<b>\$ 64,857.78</b>



**Winnequah Middle School  
Projected  
Total Cost for Athletics  
Based on Estimated  
Winnequah Numbers**

Total Interscholastic Salaries (Coaching Additives)	\$ 18,290.00
Total Intramural Salaries (Intramural Additives)	\$ 4,720.00
Total Athletic Director Salary (Athletic Director Additive)	\$ 2,655.00
Total Cost for Game Management	\$ 5,640.00
Total Estimated Cost for Transportation	\$ 6,645.50
Total Cost for New Equipment	\$ 10,417.28 + Shipping
<b>Total Cost ( Based on Winnequah#No)</b>	
Coaching Additives Intramural Additives Athletic Director Additive Game Management Transportation New Equipment	<b>\$ 48,421.78</b>

## Projection for Winnequah

- My Recommendation is for (2) separate Teams if there are (2) K-8 Schools
  - GDS & Winnequah
  - Reasons
    - Transportation between the two communities
    - Monona already has the Facilities available to make it work
    - Other Schools do it
      - Sun Prairie
        - Prairie View / Patrick Marsh
      - Middleton
        - Glacier Creek (Cross Plains) / Kromrey (Middleton)
      - Verona
        - Badger Ridge / Savannah Oaks
  - Pros
    - Keep Community Teams
    - Provide equal Opportunities for each community
    - Monona & CG have enough facilities to handle athletics
      - Monona
        - Winnequah & Nichols for Volleyball & Basketball
        - Winnequah Park for Cross Country
        - MGHS for Track & Field
      - Cottage Grove
        - GDS & Cottage Grove Elementary
    - Help with Transportation Problem
    - Provide Greater Opportunity for Kids to participate in each community
    - Provide an opportunity to play the other community
  - Cons
    - Kids would not play together until Freshmen year
    - Monona could have small numbers compared to Cottage Grove
      - This would be similar to other middle schools
      - Ie: Verona; Glacier Creek
    - Facilities not equal for certain sports
    - Winnequah would need updated equipment
      - Volleyball Standards
      - Basketballs
      - Track & Field Equipment
        - Indoor / outdoor equipment for when the MGHS is not available

**MONONA GROVE SCHOOL DISTRICT**  
**DECEMBER 22, 2009**

# **4K-8 Grade Configuration Study**

---

## **Transportation Cost Estimates**

### ***Monona***

Three additional busses needed for Winnequah grades six through eight are offset by elimination of the three busses transporting Monona 7<sup>th</sup> and 8<sup>th</sup> graders to Glacial Drumlin

**No Additional Cost**

### ***Cottage Grove***

One to two extra busses will be needed for Glacial Drumlin

<b>Projected Cost of One Route per Day</b>	<b>\$ 29,700</b>
<b>Estimated Cost to Lease an Additional Bus</b>	<b>\$ 13,500</b>
<b>Yearly Estimated Cost to Insure an Additional Bus</b>	<b>\$ <u>1,170</u></b>
	<b>\$ 44,370</b>

<b>Projected Transportation Costs for One Additional Bus</b>	<b>\$ 44,370</b>
<b>Projected Transportation Costs for Two Additional Buses</b>	<b>\$ 88,740</b>

**4K – 8<sup>th</sup> Grade Configuration**  
**2011/2012**

Prepared by John VanDerMerwe

**TRANSPORTATION**

**COST:** *(as per 2011/2012 Contractor Rates – rounded up)*

**MONONA**

**ASSUMPTIONS:**

GR. 4K-2 stay the same at Maywood.  
GR. 3-8 at Winnequah.

**ESTIMATES:**

7<sup>th</sup> and 8<sup>th</sup> grade = 109 students  
Students within the walk area = 23  
Students that need bussing = 86

**STAGGERED BELL TIMES:**

Gr 3 - 5 start @ 8:10AM until 3:00PM  
Gr 5 - 8 start @ 8:10AM until 3:20PM

**SUMMARY:**

Routes stay the same for Maywood and Winnequah 3-5<sup>th</sup> Gr.  
3 additional busses will be needed on the AM and PM runs for  
Winnequah 6 – 8<sup>th</sup> Gr.

**COST ESTIMATE AVERAGE:**

\$ 165.00 per route x 3 routes per day = \$495.00 x 180 Days = \$ 89,100.00

**CONCLUSION:**

The 3 Busses that run for the 7<sup>th</sup> and 8<sup>th</sup> Graders from Monona to  
Glacial Drumlin will be eliminated thus adding no additional cost.

**4K – 8<sup>th</sup> Grade Configuration**  
**2011/2012**

**TRANSPORTATION**

**COTTAGE GROVE**

**ASSUMPTIONS:**

GR. 4K-1 *stay the same* at Taylor Prairie.  
GR. 2 - 3 at Cottage Grove.  
GR. 4 - 8 at Glacial Drumlin.  
GR. 4 will fall into the same walk area as 5<sup>th</sup> - 8<sup>th</sup> Grade  
(If not then the walk area will have to be redefined for ALL grades  
at Glacial Drumlin and ALL routes will have to be redone and rerouted  
at an unknown cost at this stage.)  
[ Additional after school supervision will be provided for 4<sup>th</sup> graders as is  
the case with the 5<sup>th</sup> graders.]

**ESTIMATES:**

4<sup>th</sup> Gr. = 149 additional student to attend Glacial Drumlin  
Students within the walk zone = 66  
Students that need additional bussing = 83

**STAGGERED BELL TIMES:**

Gr KD - 1 start @ 7:50AM until 2:40PM - TP  
Gr 2 - 3 start @ 7:45AM until 2:35PM - CG  
Gr 4 - 5 start @ 8:10AM until 3:00PM - GD  
Gr 6 - 8 start @ 8:10AM until 3:33PM - GD

**SUMMARY::**

Routes stay the same for Taylor Prairie and Cottage Grove  
1 to 2 extra busses will be needed on the AM and PM runs for  
Glacial Drumlin

**COST ESTIMATE AVERAGE:**

\$ 165.00 per route x 1 routes per day = \$165.00 x 180 Days = \$ 29,700.00  
Lease of additional bus @ \$ 13,500 per route per year  
plus \$ 1170.00 per bus per year for insurance.

**CONCLUSION:**

The extra routes will have to be incorporated into the current routes.

**MONONA GROVE SCHOOL DISTRICT**  
**DECEMBER 22, 2009**

## **4K-8 Grade Configuration Study**

---

### **Projected Sections for Grades Seven and Eight** **Glacial Drumlin and Winnequah**

#### **Advanced Math**

Algebra 7	Glacial Drumlin (1)	Winnequah (combined 7/8)
Algebra 8	Glacial Drumlin (1)	Winnequah (combined 7/8)
Geometry 8	Glacial Drumlin (1)	Winnequah (travel to MGHS?)*

#### **Encore Electives 7<sup>th</sup> Grade**

French	Glacial Drumlin (2)	Winnequah (1)*
Spanish	Glacial Drumlin (4)	Winnequah (1)

#### **Encore Electives 8<sup>th</sup> Grade**

Art	Glacial Drumlin (1)	Winnequah (1)*
Computer Applications	Glacial Drumlin (1)	Winnequah (1)*
FACE	Glacial Drumlin (3)	Winnequah (1)
French	Glacial Drumlin (1)	Winnequah (1)*
Multi Media	Glacial Drumlin (2)	Winnequah (1)*
PE +	Glacial Drumlin (3)	Winnequah (1)
Spanish	Glacial Drumlin (3)	Winnequah (1)
Tech. Ed.	Glacial Drumlin (3)	Winnequah (1)

# **Projected Sections for Grades Seven and Eight**

## **Glacial Drumlin and Winnequah**

### **Music Electives 7<sup>th</sup> & 8<sup>th</sup>**

Band 7 <sup>th</sup>	Glacial Drumlin (1)	Winnequah (combined 7/8)
Band 8 <sup>th</sup>	Glacial Drumlin (1)	Winnequah (combined 7/8)
Choir 7 <sup>th</sup>	Glacial Drumlin (1)	Winnequah (combined 7/8)
Choir 8 <sup>th</sup>	Glacial Drumlin (1)	Winnequah (combined 7/8)
Orchestra 7 <sup>th</sup>	Glacial Drumlin (1)	Winnequah (combined 7/8)
Orchestra 8 <sup>th</sup>	Glacial Drumlin (1)	Winnequah (combined 7/8)

### **Read 180 (STAR) 7<sup>th</sup> & 8<sup>th</sup>**

STAR 6 <sup>th</sup>	Glacial Drumlin (1)	Winnequah (1)*
STAR 7 <sup>th</sup>	Glacial Drumlin (1)	Winnequah (1)*
STAR 8 <sup>th</sup>	Glacial Drumlin (1)*	Winnequah (1)*

Note: READ 180 class size upper limit is 16 students.

**7<sup>th</sup> & 8<sup>th</sup> Algebra & Geometry Enrollments Over Time**  
**2011 – 2012 Projected Enrollments at Winnequah & Glacial Drumlin**

**7<sup>th</sup> Grade Algebra (Two Year Advanced)**

Years	Number of 7 <sup>th</sup> Graders	Number of Algebra Students	Percent of 7 <sup>th</sup> Graders Taking Algebra	Cottage Grove Algebra Students	Monona Algebra Students	Other Algebra Students (not in total)	Number of Projected Algebra Sections	Class Size
'06 – '07	192	23	12%	13	10	1		
'07 – '08	212	39	18%	23	16	2		
'08 – '09	192	38	20%	23	15	2		
'09 – '10	215	26	12%	17	9	3		
'11 – '12	200 CG = 152 M = 48		Project 15%	23	7	Unknown	CG = 1 M = Combined 7/8	23 7 17

**8<sup>th</sup> Grade Algebra (One Year Advanced)**

Years	Number of 8 <sup>th</sup> Graders	Number of Algebra Students	Percent of 8 <sup>th</sup> Graders Taking Algebra	Cottage Grove Algebra Students	Monona Algebra Students	Other Algebra Students (not in total)	Number of Projected Algebra Sections	Class Size
'06 – '07	225	50	22%	27	23	1		
'07 – '08	192	28	15%	13	15	2		
'08 – '09	214	52	24%	35	17	1		
'09 – '10	207	28	14%	18	10	1		
'11 – '12	210 CG = 149 M = 61		Project 17%	25	10	Unknown	CG = 1 M = Combined 7/8	25 10 17

**8<sup>th</sup> Grade Geometry (Two Year Advanced)**

Years	Number of 8 <sup>th</sup> Graders	Number of Geometry Students	Percent of 8 <sup>th</sup> Graders Taking Geometry	Cottage Grove Geometry Students	Monona Geometry Students	Other Geometry Students (not in total)	Number of Projected Geometry Sections	Class Size
'06 – '07	225	23	10%	13	10	0		
'07 – '08	192	22	11%	13	9	1		
'08 – '09	214	38	18%	23	15	3		
'09 – '10	207	37	18%	23	14	3		
'11 – '12	210 CG = 149 M = 61		Project 14%	21	9	Unknown	CG = 1 M = Travel to MGHS?	21 9



**7<sup>th</sup> & 8<sup>th</sup> Elective Encore Enrollments Over Time**  
**2011 – 2012 Projected Encore Enrollments at Winnequah & Glacial Drumlin**

**7<sup>th</sup> Grade Spanish (Elective)**

<b>Years</b>	<b>Number of 7<sup>th</sup> Graders</b>	<b>Number of Spanish Students</b>	<b>Percent of 7<sup>th</sup> Graders Electing Spanish</b>	<b>Cottage Grove Spanish Students</b>	<b>Monona Spanish Students</b>	<b>Other Spanish Students (not in total)</b>	<b>Number of Projected Spanish Sections</b>	<b>Class Size</b>
'06 – '07	192	111	58%	79	32	5		
'07 – '08	212	125	59%	77	48	9		
'08 – '09	192	104	54%	71	33	3		
'09 – '10	215	133	62%	96	37	6		
'11 – '12	200 CG = 152 M = 48		Project 58%	88	28	Unknown	CG = 4 M = 1	22 28

**7<sup>th</sup> Grade French (Elective)**

<b>Years</b>	<b>Number of 7<sup>th</sup> Graders</b>	<b>Number of French Students</b>	<b>Percent of 7<sup>th</sup> Graders Electing French</b>	<b>Cottage Grove French Students</b>	<b>Monona French Students</b>	<b>Other French Students (not in total)</b>	<b>Number of Projected Spanish Sections</b>	<b>Class Size</b>
'06 – '07	192	51	27%	35	16	0		
'07 – '08	212	49	23%	38	11	2		
'08 – '09	192	62	32%	40	22	3		
'09 – '10	215	47	22%	26	21	2		
'11 – '12	200 CG = 152 M = 48		Project 26%	40	12	Unknown	CG = 2 M = 1	20 12

### 8<sup>th</sup> Grade Art (Semester Elective)

Years	Number of 8 <sup>th</sup> Graders	Number of Art Students	Percent of 8 <sup>th</sup> Graders Electing Art	Cottage Grove Art Students	Monona Art Students	Other Art Students (not in total)	Number of Projected Art Sections	Class Size
'06 – '07	225	44	20%	28	16	2		
'07 – '08	192	34	18%	26	8	4		
'08 – '09	214	43	20%	26	17	3		
'09 – '10	207	36	17%	27	9	3		
'11 – '12	210 CG = 149 M = 61		Project 19%	28	12	Unknown	CG = 1 M = 1	28 12

### 8<sup>th</sup> Grade Computer Applications (Semester Elective)

Years	Number of 8 <sup>th</sup> Graders	Number of Comp. App. Students	Percent of 8 <sup>th</sup> Graders Electing Com. App	Cottage Grove Com. App. Students	Monona Com. App. Students	Other Comp. App. Students (not in total)	Number of Projected Comp App Sections	Class Size
'06 – '07	225	38	17%	29	9	7		
'07 – '08	192	38	20%	30	8	2		
'08 – '09	214	43	20%	27	16	2		
'09 – '10	207	37	18%	23	14	0		
'11 – '12	210 CG = 149 M = 61		Project 19%	29	12	Unknown	CG = 1 - 2 M = 1	29 or 15 12

### 8<sup>th</sup> Grade FACE (Semester Elective)

Years	Number of 8 <sup>th</sup> Graders	Number of FACE Students	Percent of 8 <sup>th</sup> Graders Electing FACE	Cottage Grove FACE Students	Monona FACE Students	Other FACE Students (not in total)	Number of Projected FACE Sections	Class Size
'06 – '07	225	86	38%	49	37	7		
'07 – '08	192	88	46%	71	17	6		
'08 – '09	214	94	44%	61	33	4		
'09 – '10	207	93	45%	63	30	3		
'11 – '12	210 CG = 149 M = 61		Project 44%	66	27	Unknown	CG = 3 M = 1	22 27

### 8<sup>th</sup> Grade French (Year-Long Elective)

Years	Number of 8 <sup>th</sup> Graders	Number of French Students	Percent of 8 <sup>th</sup> Graders Electing French	Cottage Grove French Students	Monona French Students	Other French Students (not in total)	Number of Projected French Sections	Class Size
'06 – '07	225	37	16%	26	7	2		
'07 – '08	192	42	22%	27	15	0		
'08 – '09	214	44	21%	34	10	3		
'09 – '10	207	50	24%	32	18	3		
'11 – '12	210 CG = 149 M = 61		Project 20%	30	12	Unknown	CG = 1 - 2 M = 1	30 or 15 12

### 8<sup>th</sup> Grade Multi Media (Semester Elective)

Years	Number of 8 <sup>th</sup> Graders	Number of Multi Media Students	Percent of 8 <sup>th</sup> Graders Electing Multi Media	Cottage Grove Multi Media Students	Monona Multi Media Students	Other Multi Media Students (not in total)	Number of Projected Multi Media Sections	Class Size
'06 – '07	225	66	29%	40	26	5		
'07 – '08	192	43	22%	28	15	0		
'08 – '09	214	57	27%	32	25	5		
'09 – '10	207	41	20%	28	13	3		
'11 – '12	210 CG = 149 M = 61		Project 24%	36	15	Unknown	CG = 2 M = 1	18 15

### 8<sup>th</sup> Grade PE+ (Semester Elective)

Years	Number of 8 <sup>th</sup> Graders	Number of PE+ Students	Percent of 8 <sup>th</sup> Graders Electing PE+	Cottage Grove PE+ Students	Monona PE+ Students	Other PE+ Students (not in total)	Number of Projected PE+ Sections	Class Size
'06 – '07	225	120	53%	68	52	12		
'07 – '08	192	94	49%	62	32	6		
'08 – '09	214	112	52%	76	36	6		
'09 – '10	207	139	67%	92	47	5		
'11 – '12	210 CG = 149 M = 61		Project 55%	82	34	Unknown	CG = 3 M = 1	27 34

### 8<sup>th</sup> Grade Spanish (Year-Long Elective)

Years	Number of 8 <sup>th</sup> Graders	Number of Spanish Students	Percent of 8 <sup>th</sup> Graders Electing Spanish	Cottage Grove Spanish Students	Monona Spanish Students	Other Spanish Students (not in total)	Number of Projected Spanish Sections	Class Size
'06 – '07	225	120	53%	71	49	9		
'07 – '08	192	85	44%	56	29	6		
'08 – '09	214	100	47%	61	39	5		
'09 – '10	207	88	43%	59	29	3		
'11 – '12	210 CG = 149 M = 61		Project 46%	69	28	Unknown	CG = 3 M = 1	23 28

### 8<sup>th</sup> Grade Tech. Ed. (Semester Elective)

Years	Number of 8 <sup>th</sup> Graders	Number of Tech. Ed. Students	Percent of 8 <sup>th</sup> Graders Electing Tech. Ed.	Cottage Grove Tech. Ed. Students	Monona Tech. Ed. Students	Other Tech. Ed. Students (not in total)	Number of Projected Tech. Ed. Sections	Class Size
'06 – '07	225	86	38%	59	27	7		
'07 – '08	192	87	45%	63	24	5		
'08 – '09	214	87	41%	62	25	6		
'09 – '10	207	85	41%	57	28	3		
'11 – '12	210 CG = 149 M = 61		Project 41%	61	25	Unknown	CG = 3 M = 1	20 - 21 25

**7<sup>th</sup> & 8<sup>th</sup> Music Enrollments Over Time**  
**2011 – 2012 Projected Music Enrollments at Winnequah & Glacial Drumlin**

**7<sup>th</sup> Grade Band (Elective)**

<b>Years</b>	<b>Number of 7<sup>th</sup> Graders</b>	<b>Number of Band Students</b>	<b>Percent of 7<sup>th</sup> Graders Electing Band</b>	<b>Cottage Grove Band Students</b>	<b>Monona Band Students</b>	<b>Other Band Students (not in total)</b>	<b>Number of Projected Band Sections</b>	<b>Class Size</b>
'06 – '07	192	50	26%	36	14	3		
'07 – '08	212	69	33%	48	21	2		
'08 – '09	192	52	27%	30	22	1		
'09 – '10	215	72	33%	44	28	2		
'11 – '12	200 CG = 152 M = 48		Project 29%	44	14	Unknown	CG = 1 M = 1 or Combined 7/8	44 14  26

**8<sup>th</sup> Grade Band (Elective)**

<b>Years</b>	<b>Number of 8<sup>th</sup> Graders</b>	<b>Number of Band Students</b>	<b>Percent of 8<sup>th</sup> Graders Electing Band</b>	<b>Cottage Grove Band Students</b>	<b>Monona Band Students</b>	<b>Other Band Students (not in total)</b>	<b>Number of Projected Band Sections</b>	<b>Class Size</b>
'06 – '07	225	45	20%	29	16	2		
'07 – '08	192	33	17%	21	12	2		
'08 – '09	214	48	22%	34	14	3		
'09 – '10	207	38	18%	24	14	2		
'11 – '12	210 CG = 149 M = 61		Project 19%	28	12	Unknown	CG = 1 M = 1 or Combined 7/8	28 12  26

**7<sup>th</sup> & 8<sup>th</sup> Music Enrollments Over Time**  
**2011 – 2012 Projected Music Enrollments at Winnequah & Glacial Drumlin**

**7<sup>th</sup> Grade Choir (Elective)**

Years	Number of 7 <sup>th</sup> Graders	Number of Choir Students	Percent of 7 <sup>th</sup> Graders Electing Choir	Cottage Grove Choir Students	Monona Choir Students	Other Choir Students (not in total)	Number of Projected Choir Sections	Class Size
'06 – '07	192	94	49%	60	34	3		
'07 – '08	212	79	37%	44	35	1		
'08 – '09	192	52	27%	29	23	3		
'09 – '10	215	92	43%	62	30	3		
'11 – '12	200 CG = 152 M = 48		Project 37%?	56	18	Unknown	CG = 1 M = 1 or Combined 7/8	56 18  38

**8<sup>th</sup> Grade Choir (Elective)**

Years	Number of 8 <sup>th</sup> Graders	Number of Choir Students	Percent of 8 <sup>th</sup> Graders Electing Choir	Cottage Grove Choir Students	Monona Choir Students	Other Choir Students (not in total)	Number of Projected Choir Sections	Class Size
'06 – '07	225	88	39%	54	34	3		
'07 – '08	192	99	52%	67	32	4		
'08 – '09	214	72	34%	41	31	3		
'09 – '10	207	49	24%	31	18	2		
'11 – '12	210 CG = 149 M = 61		Project 32%?	48	20	Unknown	CG = 1 M = 1 or Combined 7/8	48 20  38



**7<sup>th</sup> & 8<sup>th</sup> Music Enrollments Over Time**  
**2011 – 2012 Projected Music Enrollments at Winnequah & Glacial Drumlin**

**7<sup>th</sup> Grade Orchestra (Elective)**

<b>Years</b>	<b>Number of 7<sup>th</sup> Graders</b>	<b>Number of Orchestra Students</b>	<b>Percent of 7<sup>th</sup> Graders Electing Orchestra</b>	<b>Cottage Grove Orchestra Students</b>	<b>Monona Orchestra Students</b>	<b>Other Orchestra Students (not in total)</b>	<b>Number of Projected Orchestra Sections</b>	<b>Class Size</b>
'06 – '07	192	43	22%	23	20	2		
'07 – '08	212	38	18%	22	16	1		
'08 – '09	192	46	24%	26	20	2		
'09 – '10	215	51	24%	26	25	5		
'11 – '12	200 CG = 152 M = 48		Project 22%	33	11	Unknown	CG = 1 M = 1 or Combined 7/8	33 11  22

**8<sup>th</sup> Grade Orchestra (Elective)**

<b>Years</b>	<b>Number of 8<sup>th</sup> Graders</b>	<b>Number of Orchestra Students</b>	<b>Percent of 8<sup>th</sup> Graders Electing Orchestra</b>	<b>Cottage Grove Orchestra Students</b>	<b>Monona Orchestra Students</b>	<b>Other Orchestra Students (not in total)</b>	<b>Number of Projected Orchestra Sections</b>	<b>Class Size</b>
'06 – '07	225	48	21%	31	17	2		
'07 – '08	192	38	20%	21	17	2		
'08 – '09	214	30	14%	16	14	1		
'09 – '10	207	37	18%	19	18	2		
'11 – '12	210 CG = 149 M = 61		Project 18%	27	11	Unknown	CG = 1 M = 1 or Combined 7/8	27 11  22

**7<sup>th</sup> & 8<sup>th</sup> STAR (READ 180) Enrollments Over Time**  
**2011 – 2012 Projected STAR Enrollments at Winnequah & Glacial Drumlin**

**6<sup>th</sup> Grade STAR (READ 180)**

<b>Years</b>	<b>Number of 6<sup>th</sup> Graders</b>	<b>Number of STAR Students <i>Reading Intervention</i></b>	<b>Percent of 6<sup>th</sup> Graders Taking STAR</b>	<b>Cottage Grove STAR Students</b>	<b>Monona *STAR **Voyager Students</b>	<b>Other STAR Students (not in total)</b>	<b>Number of Projected STAR Sections</b>	<b>Class Size</b>
'06 – '07	192	19	10%	14	*5	2		
'07 – '08	212	19	9%	11	*8	3		
'08 – '09	192	29	15%	13	**16	0		
'09 – '10	215	20	9%	14	**6	0		
'11 – '12	200 CG = 152 M = 48		Project 10%	15	6	Unknown	CG = 1 M =	15 6

**7<sup>th</sup> Grade STAR (READ 180)**

<b>Years</b>	<b>Number of 7<sup>th</sup> Graders</b>	<b>Number of STAR Students</b>	<b>Percent of 7<sup>th</sup> Graders Taking STAR</b>	<b>Cottage Grove STAR Students</b>	<b>Monona STAR Students</b>	<b>Other STAR Students (not in total)</b>	<b>Number of Projected STAR Sections</b>	<b>Class Size</b>
'06 – '07	192	16	8%	11	5	3		
'07 – '08	212	17	8%	14	3	1		
'08 – '09	192	9	5%	6	3	1		
'09 – '10	215	19	9%	14	5	1		
'11 – '12	200 CG = 152 M = 48		Project 8%	12	4	Unknown	CG = 1 M = 1	12 4

**8<sup>th</sup> Grade STAR (READ 180)**

<b>Years</b>	<b>Number of 8<sup>th</sup> Graders</b>	<b>Number of STAR Students</b>	<b>Percent of 8<sup>th</sup> Graders Taking STAR</b>	<b>Cottage Grove STAR Students</b>	<b>Monona STAR Students</b>	<b>Other STAR Students (not in total)</b>	<b>Number of Projected STAR Sections</b>	<b>Class Size</b>
'06 – '07	225	14	6%	12	2	0		
'07 – '08	192	11	6%	9	3	2		
'08 – '09	214	11	5%	11	0	0		
'09 – '10	207	8	4%	6	2	1		
'11 – '12	210 CG = 149 M = 61		Project 5%	8	3	Unknown	CG = 1 M = 1	8 3

STAR (READ 180) class size upper limit has been 16 students per class.



**MONONA GROVE SCHOOL DISTRICT**  
**DECEMBER 22, 2009**

# **4K-8 Grade Configuration Study**

---

## **Sample Master Schedules for Grades 6 - 8**

***Winnequah School***

**Start Time 7:57**

**End Time 3:20**

***Glacial Drumlin School***

**Start Time 8:10**

**End Time 3:33**

***School Day for Middle Level Students is 7 hours and 23 minutes***

# Winnequah 6<sup>th</sup> – 8<sup>th</sup> Sample Master Schedule 2011-2012

Grade 6	Grade 7	Grade 8
<b>Core</b> 7:57 – 8:50 (53)  <b>AME</b> 8:53 – 9:43 (50)  <b>Encore Y</b> 9:46 – 10:31 (45)	<b>Core</b> 7:57 – 8:52 (55)  <b>Encore Y</b> 8:55 – 9:40 (45)  <b>AME</b> 9:43 – 10:33 (50)	<b>Encore Y</b> 7:57 – 8:42 (45)  <b>Core</b> 8:45 – 9:40 (55)  <b>AME</b> 9:43 – 10:33 (50)
<b>Lunch</b> 10:34 – 11:04 (30)	<b>Core</b> 10:36 – 11:31 (55)	<b>Core</b> 10:36 – 11:31 (55)
<b>Core</b> 11:07 – 12:00 (53)	<b>Lunch</b> 11:33 – 12:03 (30)	<b>Lunch</b> 11:33 – 12:03 (30)
<b>Encore X</b> 12:03 – 12:48 (45)  <b>Core</b> 12:51 – 1:44 (53)  <b>Lit Core</b> 1:47 – 3:00 (73)  <b>HRM</b> 3:03 – 3:20 (17)	<b>Core</b> 12:06 – 1:01 (55)  <b>Encore X</b> 1:04 – 1:49 (45)  <b>Core</b> 1:52 – 2:47 (55)  <b>A &amp; E</b> 2:50 – 3:20 (30)	<b>Core</b> 12:06 – 1:01 (55)  <b>Core</b> 1:04 – 1:59 (55)  <b>Encore X</b> 2:02 – 2:47 (45)  <b>A &amp; E</b> 2:50 – 3:20 (30)

## Sixth Grade

3 Core Classes each 53 minutes  
 Literacy Core Time 73 minutes  
 Encore Classes each 45 minutes  
 Music/Tutorial Class 50 minutes  
 Home Room 17 minutes

## Seventh Grade

Core Classes each 55 minutes  
 Encore Classes each 45 minutes  
 Music/Tutorial Class 50 minutes  
 A & E Class 30 minutes

## Eighth Grade

Core Classes each 55 minutes  
 Encore Classes each 45 minutes  
 Music/Tutorial Class 50 minutes  
 A & E Class 30 minutes

Winnequah Grades 6 – 8 Estimated Enrollment = 184 Students

# Glacial Drumlin 6<sup>th</sup> – 8<sup>th</sup> Sample Master Schedule 2011 - 2012

Grade 6	Grade 7	Grade 8
<b>Core</b> 8:10 – 9:03 (53)	<b>Core</b> 8:10 – 9:05 (55)	<b>Encore X</b> 8:10 – 8:55 (45)
<b>Encore X</b> 9:06 – 9:51 (45)	<b>Core</b> 9:08 – 10:03 (55)	<b>Core</b> 8:58 – 9:53 (55)
<b>Lit Core</b> 9:54 – 10:41 (47)	<b>Encore X</b> 10:06 – 10:51 (45)	<b>Core</b> 9:56 – 10:51 (55)
<b>Core</b> 10:44 – 11:37 (53)	<b>Core</b> 10:54 – 11:49 (55)	<b>Lunch</b> 10:53 – 11:23 (30)
<b>Core</b> 11:40 – 12:33 (53)	<b>Lunch</b> 11:49 – 12:19 (30)	<b>Core</b> 11:26 – 12:21 (55)
<b>Lunch</b> 12:36 – 1:06 (30)	<b>Encore Y</b> 12:22 – 1:07 (45)	<b>AME</b> 12:24 – 1:14 (50)
<b>Encore Y</b> 1:09 – 1:54 (45)	<b>AME</b> 1:17 – 2:07 (50)	<b>Core</b> 1:17 – 2:12 (55)
<b>Lit Core</b> 1:57 – 2:23 (26)	<b>Core</b> 2:10 – 3:05 (55)	<b>Encore Y</b> 2:15 – 3:00 (45)
<b>AME</b> 2:26 – 3:16 (50)		
<b>HRM</b> 3:19 – 3:33 (14)	<b>A &amp; E</b> 3:08 – 3:33 (25)	<b>A &amp; E</b> 3:03 – 3:33 (30)

## Sixth Grade

3 Core Classes each 53 minutes  
 Literacy Core Time 73 minutes  
 Encore Classes each 45 minutes  
 Music/Tutorial Class 50 minutes  
 Home Room 14 minutes

## Seventh Grade

Core Classes each 55 minutes  
 Encore Classes each 45 minutes  
 Music/Tutorial Class 50 minutes  
 A & E Class 25 minutes

## Eighth Grade

Core Classes each 55 minutes  
 Encore Classes each 45 minutes  
 Music/Tutorial Class 50 minutes  
 A & E Class 30 minutes

Glacial Drumlin Grades 6 – 8 Estimated Enrollment = 466 Students



# Winnequah School

## Upper Level

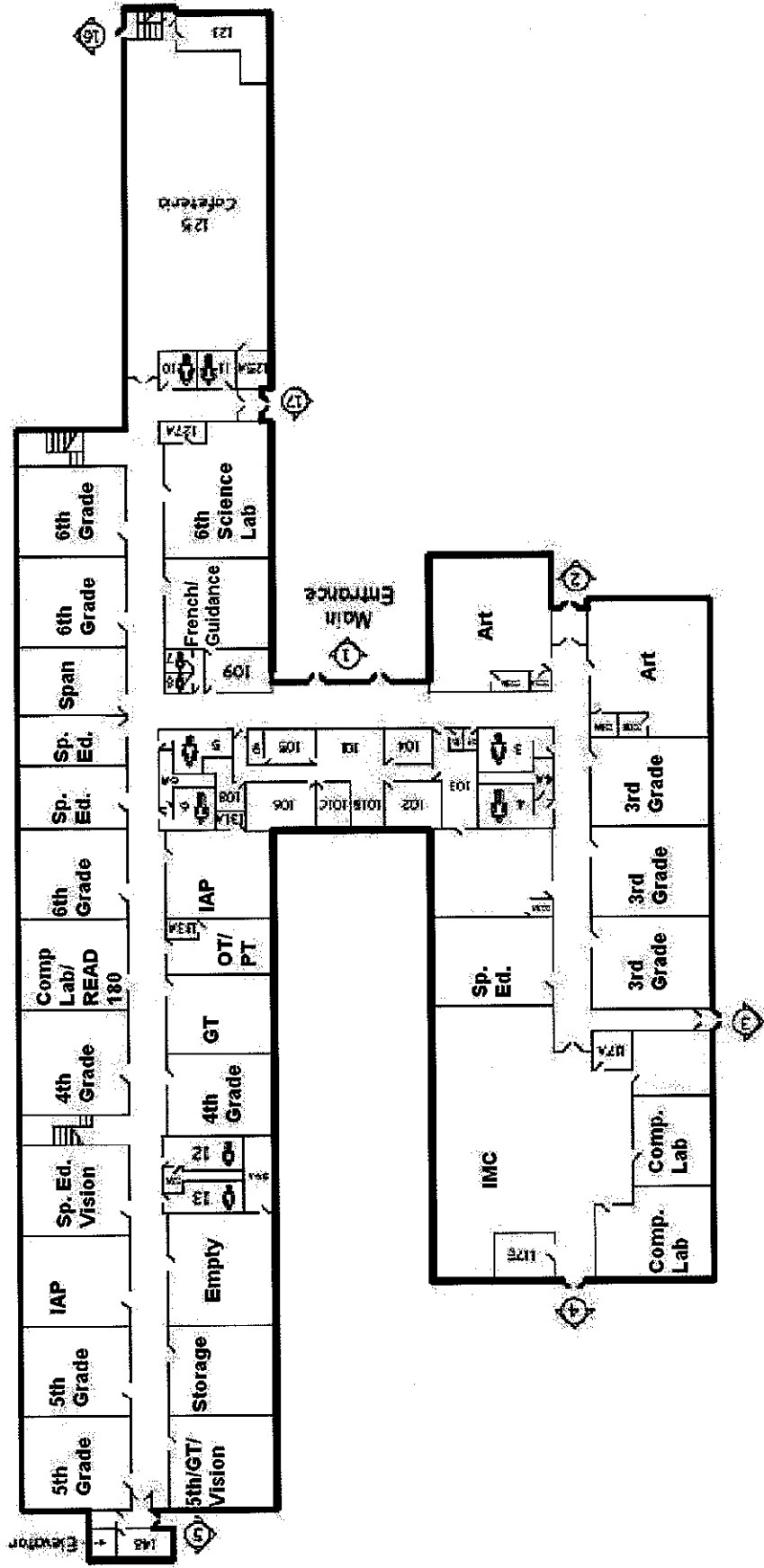

# Winnequah School

## Lower Level

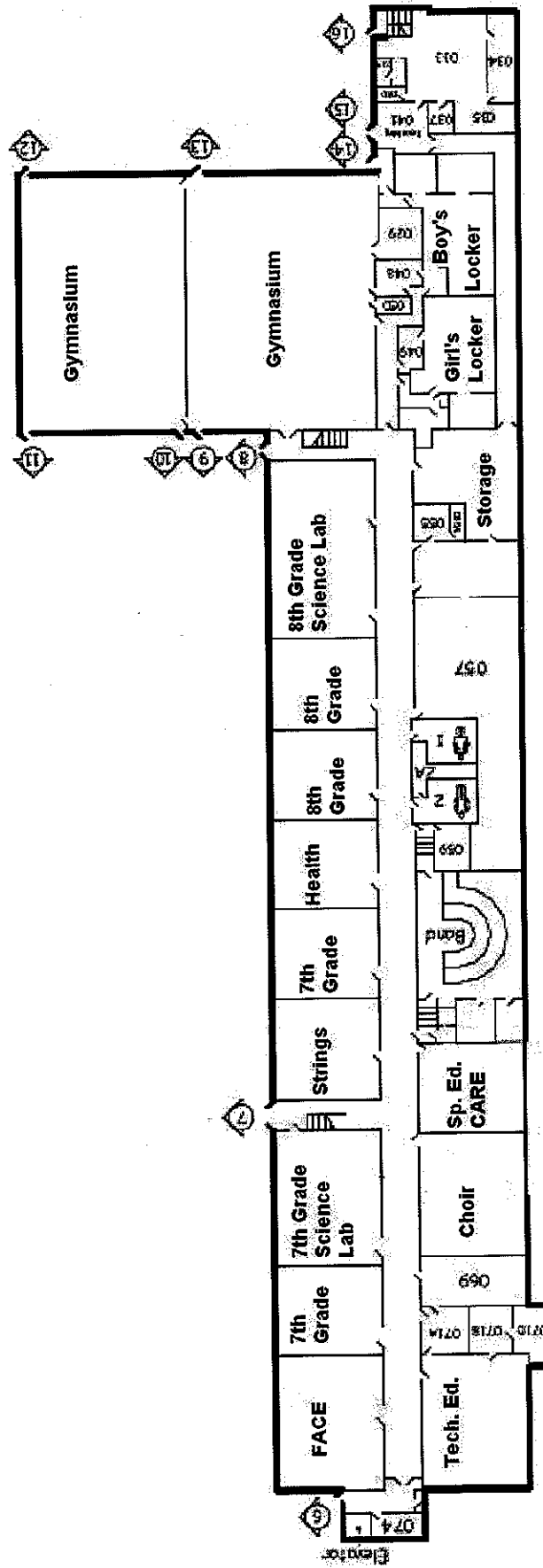

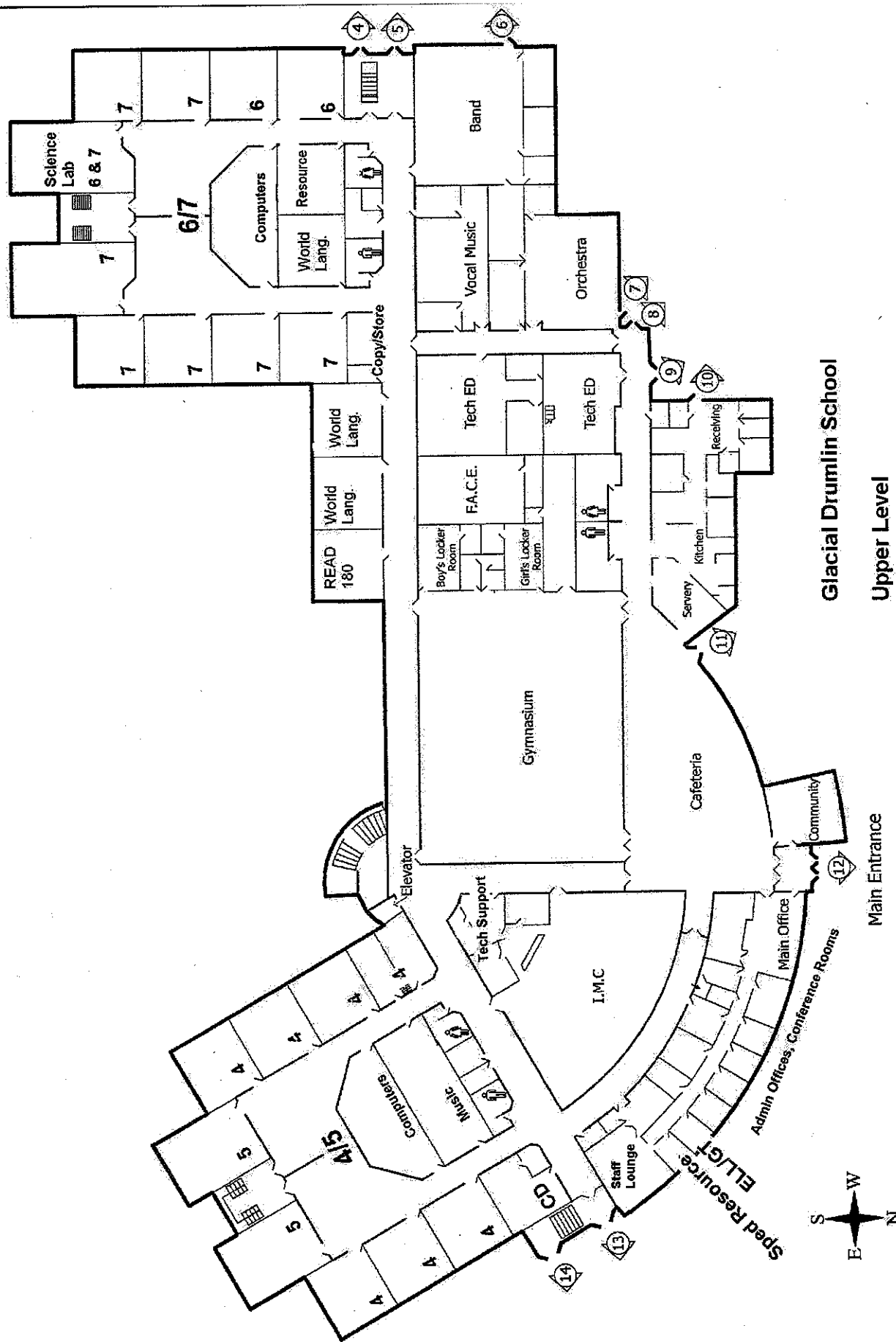

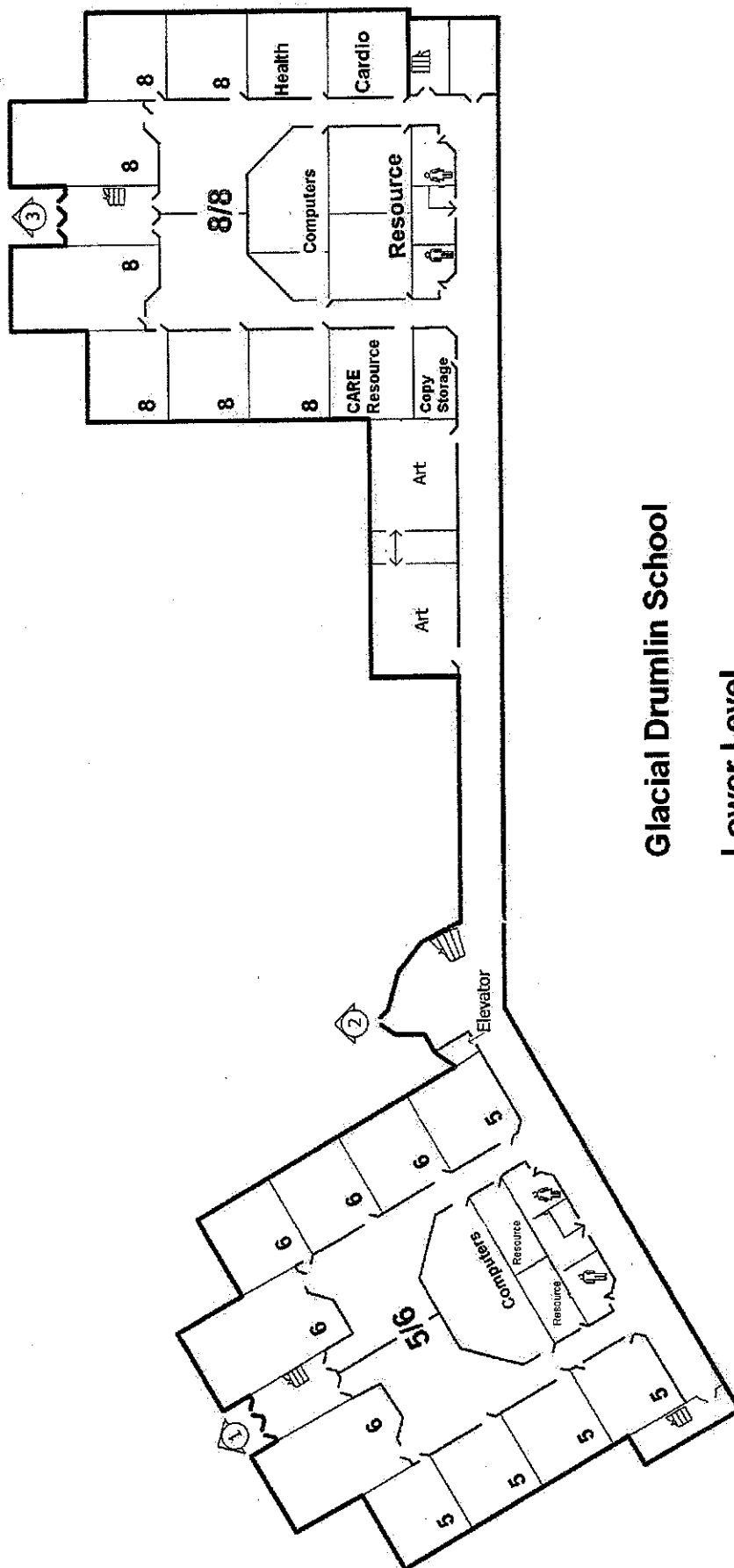

**Summary of Projected Costs**  
**4K-8 Grade Configuration**  
**Middle School Programming in Both Communities**

<b>First Year Estimated Costs for 4K-8 Configuration</b>	<b>Costs</b>
Computer Related Projected Expenses	<b>\$210,917</b>
Science Lab Projected Expenses	<b>\$178,178</b>
FACE and Tech. Ed. Projected Expenses	<b>\$229,682</b>
Library Materials Replication Projected Costs	<b>\$31,600</b>
Music Replication Projected Expenses (Stereo Sound System Additional Expense)	<b>\$179,159</b>
PE and Health Instruction Projected Expenses	<b>\$42,516</b>
Student Services Staffing	<b>\$0</b>
Winnequah Interscholastic Athletics Projected Costs	<b>\$53,205</b>
Transportation Projected Cost Estimates (1 Additional Bus)	<b>\$44,370</b>
(2 Additional Busses)	<b>\$88,740</b>
Costs to Move Furniture/Equipment Within District for 4K-8 Configuration	<b>?</b>
Review of Administrative Staffing (Potential Increase)	<b>?</b>
Additional Staffing Costs for Grades 7 and 8 Encore and Music (including travel), Supervision, and ISS	<b>?</b>
Winnequah PE Storage Addition and Storage Shelving	<b>\$50,625</b>



7 <sup>th</sup> & 8 <sup>th</sup> Math Texas Instruments Graphing Calculators and Display Tool	<b>\$8,085</b>
Music Additives: Band Director, Vocal Director, Orchestra Director, Jazz Band, Sizzling Strings, Show Choir	<b>\$8,437</b>
Coordinator Additives (7 <sup>th</sup> & 8 <sup>th</sup> )	<b>\$4,130</b>
Core Class Department Budgets (English, Math, Science, Social Studies)	<b>\$1,836</b>
Encore & Music Department Budgets: Art, Athletics, Computers, FACE, French, Health, Multi Media, Music, PE, Spanish, Tech. Ed.	<b>\$17,050</b>
Student Services Department Budgets: AV, CARE, ELL, Guidance, Gifted & Talented, Library, Nurse, STAR	<b>\$2,545</b>
<b>First Year Increased Expenses for 4K-8 Configuration</b>	
(One Bus for Transportation)	<b>\$1,062,333</b>
(Two Busses for Transportation)	<b>\$1,106,703</b>

**Summary of Projected Costs**  
**4K-8 Grade Configuration**  
**Middle School Programming in Both Communities**

<b>Yearly Ongoing Estimated Costs for 4K-8 Configuration</b>	<b>Costs</b>
Computer Related Costs	<b>\$23,267</b>
Transportation Costs (One bus \$44,370 or Two Busses \$88,740)	<b>\$44,370</b>
Additional Administrative Staff (Salary & Benefits)	<b>?</b>
Additional Staffing Costs for Grades 7 and 8 Encore and Music (including Travel) Supervision, and ISS	<b>?</b>
Athletic Additives for Interscholastic Sports and Intramurals	<b>\$25,311</b>
Athletic Director Additive	<b>\$2,921</b>
Interscholastic Athletics Home Game Management Costs	<b>\$6,204</b>
Interscholastic Athletics Transportation Costs	<b>\$7,311</b>
Music Additives: Band Director, Vocal Director, Orchestra Director, Jazz Band, Sizzling Strings, Show Choir	<b>\$1,836</b>
Coordinator Additives (7 <sup>th</sup> & 8 <sup>th</sup> )	<b>\$4,130</b>
Core Class Department Budgets (English, Math, Science, Social Studies)	<b>\$6,386</b>
Encore & Music Department Budgets: Art, Athletics, Computers, FACE, French, Health, Multi Media, Music, PE, Spanish, Tech. Ed.	<b>\$17,050</b>
Student Services Department Budgets: AV, CARE, ELL, Guidance, Gifted & Talented, Library, Nurse, STAR	<b>\$2,545</b>

Estimated Yearly Ongoing Costs for 4K-8 Configuration	
(One Bus for Transportation)	\$149,983
(Two Busses for Transportation)	\$194,353

**Note:** Ten percent has been added to athletic additives, coordinator additives, and encore/music additives. Department budget ongoing costs for moving grades seven and eight to Winnequah have been calculated at 40% of current allocations at Glacial Drumlin with 10% added.